

# Whipping & Binding Workshop Instructions



To: **Kasias Karpets Ltd** 07825 156676  
 Branch: Sheen - Tel: 020 8876 9126 E:sheenbranch@mr-carpet.co.uk  
 Branch Contact: Andy

Customer Name: Treadaway **Please quote on invoice**

Job No: S32005 **Please quote on invoice**

Description of Carpet: Flatweave Classics Boucle Inox

Carpet Finish: Top Taping all round

Number of Pieces: 3.25 x 5.00m ISSUED

Sizes to be cut to: (If applicable) Make Two rugs / 3.25 L x 2.50m WIDE and 3.25m L x 2.00m Wide

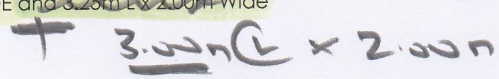

NOTE  
 RUG 2  
 3.00m L x 2.00m

Runner Lengths for Taping: **Please check before sewing**

Date for collection: Monday 26-10 Required back by: Wednesday 28-10

Collection From: Select Location Return To: Select Location

If Tape Selected	Supplied By	Select Supplier (if Appl)
Colour of tape: Calibra 3042	Size of Tape:	Amount Visible on Top: 2" VISIBLE
If Whipping:		
Colour of Whipping: N/A		

## Special Instructions

Sewing charges authorised - **Please note only charges authorised in writing will be paid on invoice**

Materials	Description	Quantity	Unit Cost	Total
Whipping	Under 3m x 3m		£2.50	
	Over 3m x 3m		£2.50	
Standard Taping	Labour Only Under 3m x 3m	21.50	£6.30	£135.45
Double Taping	Labour Only Under 3m x 3m		£9.00	
Faux Suede & Leather	Labour Only Under 3m x 3m		£7.50	
Mitres Cotton	Per Corner	NOT APPLICABLE		
Mitres Leather	Per Corner	NOT APPLICABLE		
Narrow Binding THICK PILES	Labour & tape included		£7.50	
Blind Stitching MACHINE	38mm Tape Labour & Tape		£8.50	
Blind Stitching HAND SEWN	38mm Tape Labour & Tape		£12.50	
Hidden Stitching	Additional cost per lin M to above prices (Enter the same quantity as tape quantity)	NOT APPLICABLE		

## Materials & other charges

Quantity	Description	Quantity	Unit Cost	Total
	Padding		£1.00	
	Chenille Tape 120mm	21.50	£4.20	£90.30
	Chrome Tape 120mm		£3.70	
	Cotton Tape 70mm		£3.20	
	Cotton Tape CK 120mm		£3.70	
	Cotton Herringbone HB 120mm		£4.20	
	Linen Twill Tape		£5.70	
	Faux Leather 120mm		£6.00	
	Faux Suede 120mm		£6.00	
	Goblin GLV 120mm		£4.50	
	Jute 120mm		£3.70	
	Leather 120mm		£13.00	
	Pipeline		£3.20	
	Starline (Linen) LS 120mm		£5.70	
	Superstrong 120mm		£5.70	
	Slim 120mm		£3.20	
	Teakline 120mm		£5.70	

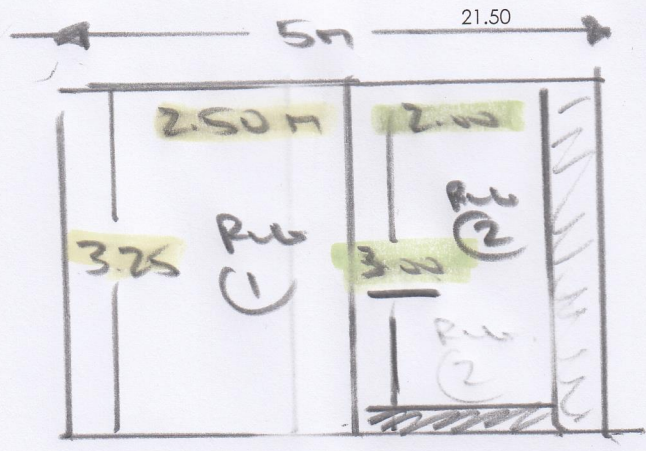

Sub Total	£225.75
VAT @ 20%	£45.15
<b>Total</b>	<b>£270.90</b>

(2 RUGS W/ 2" VISIBLE TAPE ALL ROUND)