



**Karndean**  
Designflooring



Karndean  
LooseLay

**Karndean**  
**LooseLay**  
Home

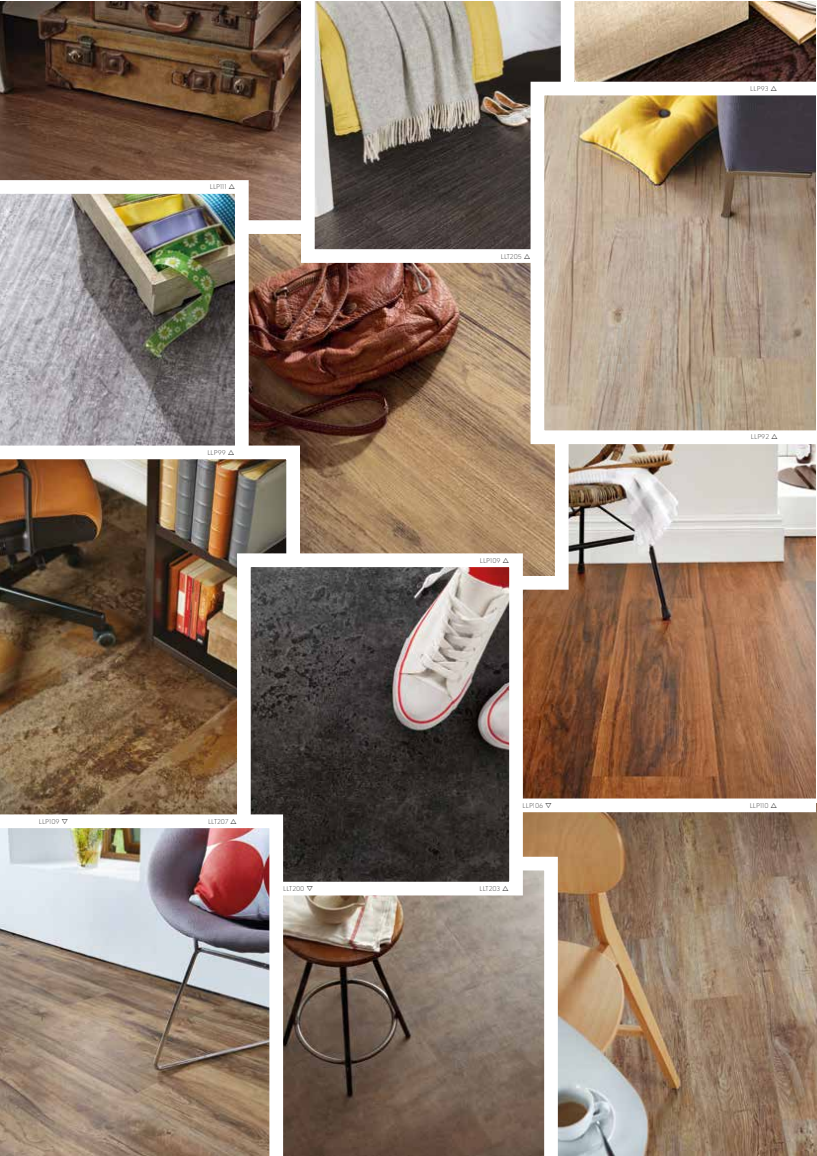

# Why Karndeal LooseLay?



**Quick and easy to install**  
All you need is a sound, smooth, dry and dust free subfloor. **Karndeal LooseLay** can be fitted over most existing hard floors\*.

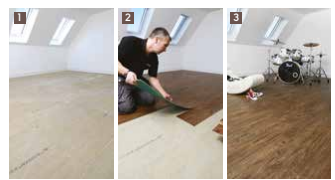

**Acoustic qualities**  
**Karndeal LooseLay** is perfect for projects where you want to reduce noise levels in the room below such as playrooms, bedrooms and garage/loft conversions, without the need for underlay.



**Comfortable underfoot**  
Our products are softer and warmer underfoot than natural wood and stone flooring. Additional cushioning in the backing helps make the product more comfortable underfoot.



**Realistic designs**  
Available in contemporary larger scale planks and tiles, **Karndeal LooseLay** is available in a variety of colour tones and styles.



**Compatible with underfloor heating**  
up to 27°C



**100% recyclable**



**Individually replaceable**  
Should you need to replace a piece, simply lift the damaged plank or tile and replace with a new one.

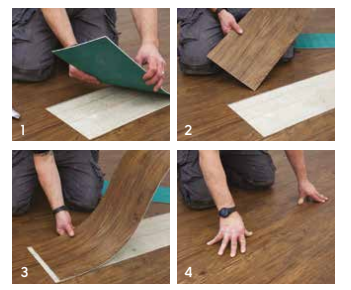

**Durable**  
**Karndeal LooseLay** is extremely hardwearing. Unlike real wood and stone, it won't splinter, warp or crack.



**Low maintenance**  
We use PU technology to ensure that there is no need to apply an additional surface treatment following installation.

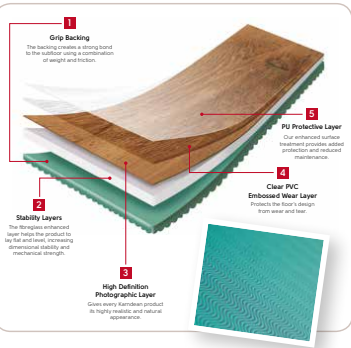

\*Adhesive may be required for some applications, please refer to installation instructions.

# Karndean LooseLay Wood

1050mm x 250mm (41.3" x 9.85")



**Ashland** LLP95 (Series Two) pg 16



**Newport** LLP94 (Series Two) pg 17



**Country Oak** LLP92 (Series One) pg 6



**Traditional Oak** LLP101 (Series One) pg 7



**Vintage Timber** LLP105 (Series One) pg 8



**Weathered Timber** LLP103 (Series One) pg 9



**Hartford** LLP112 (Series Three) pg 28



**Antique Timber** LLP106 (Series One) pg 10



**Heritage Oak** LLP102 (Series One) pg 11



**Rustic Timber** LLP104 (Series One) pg 12



**Cambridge** LLP113 (Series Three) pg 24



**Providence** LLP108 (Series Three) pg 25



**Stamford** LLP109 (Series Three) pg 26



**Winchester** LLP97 (Series Two) pg 18



**Burlington** LLP110 (Series Three) pg 27



**Hudson** LLP99 (Series Two) pg 19



**Salem** LLP96 (Series Two) pg 20



**Boston** LLP111 (Series Three) pg 29



**Dover** LLP93 (Series Two) pg 21

# Karndean LooseLay Stone

500mm x 610mm (19.7" x 24")



**Indiana** LLT202 (Series One) pg 32



**Georgia** LLT206 (Series Two) pg 38



**Colorado** LLT201 (Series One) pg 33



**Texas** LLT207 (Series Two) pg 39



**Arizona** LLT200 (Series One) pg 34



**Madison** LLT203 (Series One) pg 35

# Karndean LooseLay Textile

500mm x 610mm (19.7" x 24")



**Pennsylvania** LLT204 (Series Two) pg 42



**Nevada** LLT205 (Series Two) pg 43

## Colour and Pattern Reproduction

We are careful to make sure our brochures are accurate and printed to very high standards, but photography and printing cannot always create a perfect representation of our products. For this reason we strongly recommend that you look at a sample of any product you are considering before placing your order.

All of our products are inspired by things we have seen in the natural world. Just as variation in colour and detail is part of the unique beauty of natural materials, it is also a feature of many of our designs. This means that with some of our products you will see natural variation when your floor is laid. If in doubt, ask your retailer to show you a larger sample of the product.

We love developing new ideas and improving on our existing designs. This does mean that sometimes products are withdrawn at short notice. We hate to disappoint, and will always try to work with you to find an alternative design that you love just as much.

# Series One Wood

1050mm x 250mm (41.3" x 9.85")



Our Series One collection introduces a palette of popular warm wood tones, from light Country Oak to the rich depth of Rustic Timber.



## Country Oak LLP92

Create a contemporary and open look in your room with the **cool grey hues and rustic grain details** of our Country Oak **Karndean LooseLay** planks.



Country Oak LLP92



Traditional Oak LLP101

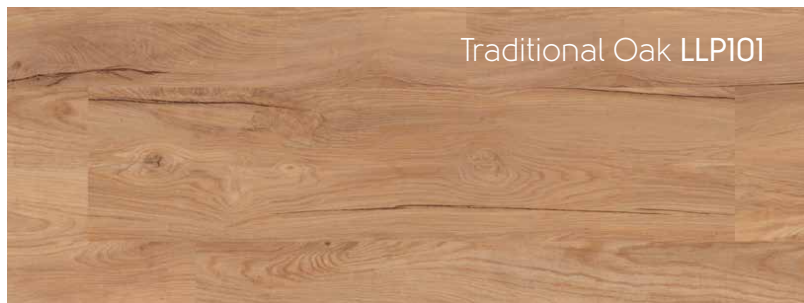



Vintage Timber LLP105



Weathered Timber LLP103



Antique Timber LLPI06

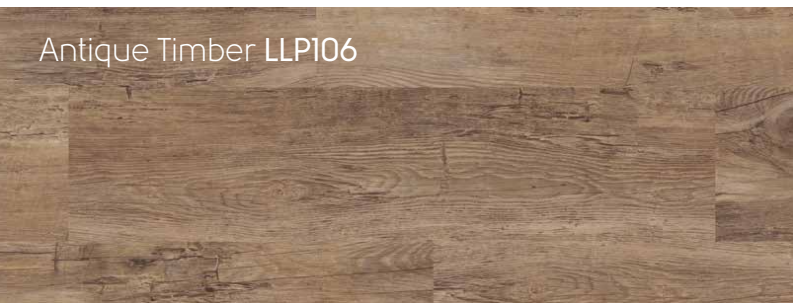

Heritage Oak LLPI02

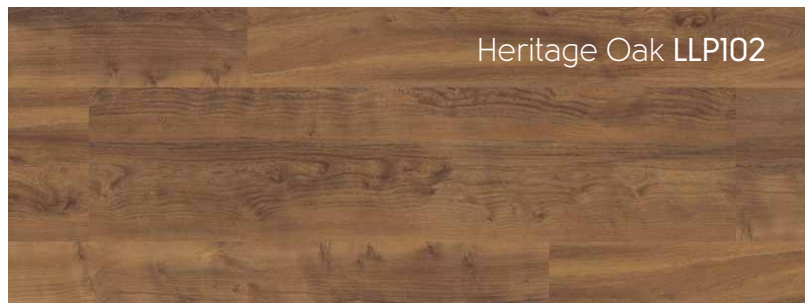



Rustic Timber LLP104

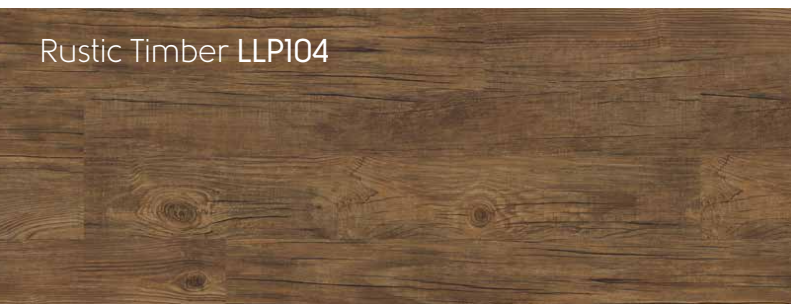

# Series Two Wood

1050mm x 250mm (41.3" x 9.85")



Our Series Two Wood designs feature a hand scraped emboss to reflect the unique grains, texture and finish of natural wood.



## **Dover** LLP93

The **wide planks** and **rich chocolate tones** of our Karndean LooseLay Dover planks will help create an inviting and contemporary open look in your room.



Ashland LLP95



Newport LLP94





Salem LLP96



Dover LLP93

# Series Three Wood

1050mm x 250mm (41.3" x 9.85")



new

Our latest Series Three collection includes popular pale and warm oak tones, fashionable rustics and deep greys.



## Boston LLP111

You can instantly transform a neutral room with the **rich chocolate brown hues** in our Boston planks. Pair with metallic finishes and classic vintage pieces for a luxurious look.



Cambridge LLP113

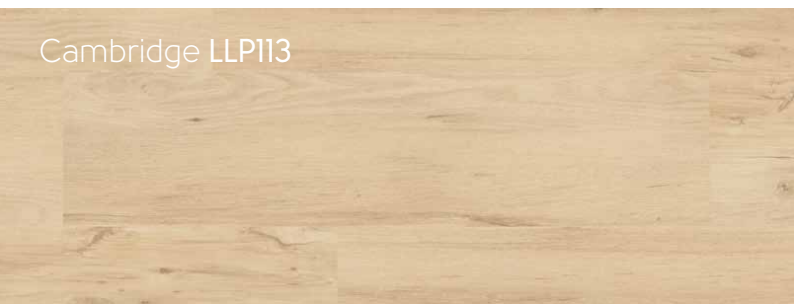

Providence LLP108

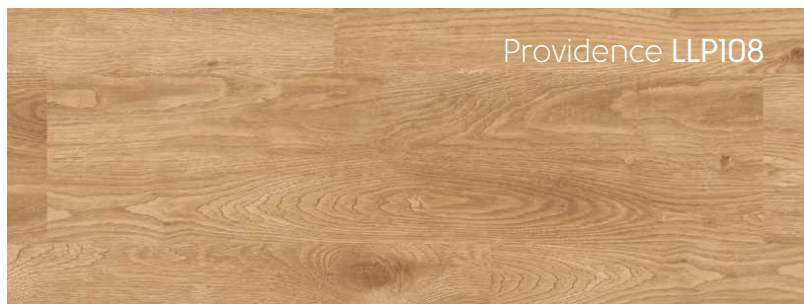



Stamford LLP109

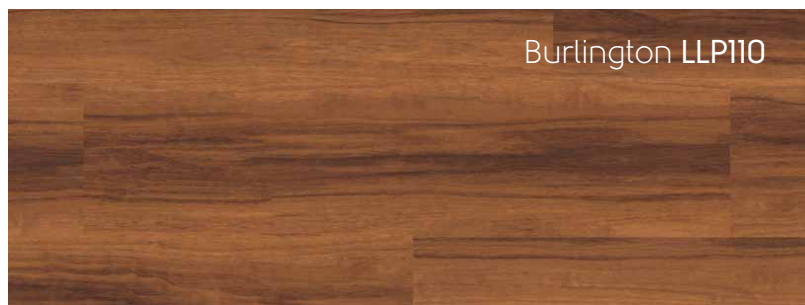

Burlington LLP110



Hartford LLP112



Boston LLP111



# Series One Stone

500mm x 610mm (19.7" x 24")



Our Series One Stone collection includes two modern mid-grey designs as well as cream and black travertine effect tiles.

## Arizona LLT200

With the modern look of **sealed concrete**, our **mid-brown Arizona tiles** make a great base for any decor scheme.



Indiana LLT202



Colorado LLT201





Arizona LLT200

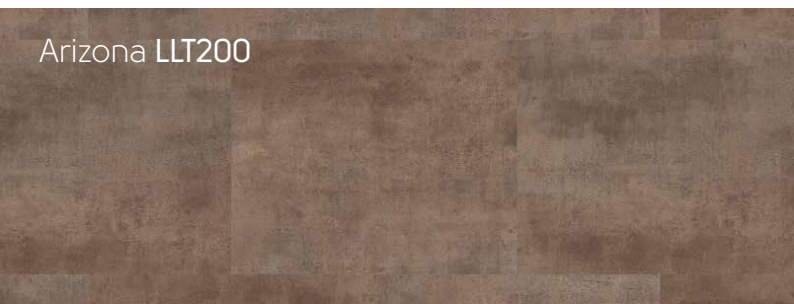

Madison LLT203



# Series Two Stone

500mm x 610mm (19.7" x 24")



Our Series Two Stone designs replicate the striking look of natural slate.

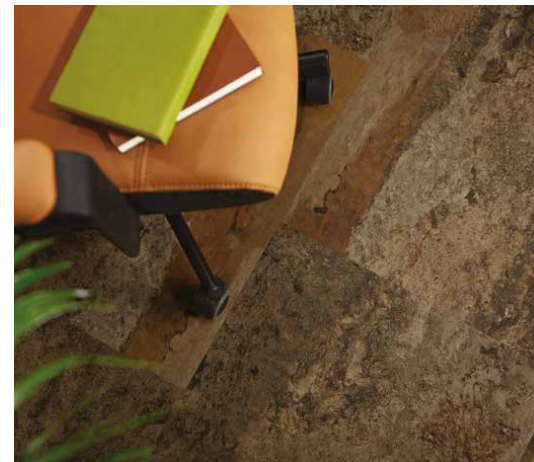

## Texas LLT207

The darkest of our new slate designs, Texas features **warm dark brown tones** and looks great with both traditional and more modern decor styles.



Georgia LLT206



Texas LLT207



# Series Two Textile

500mm x 610mm (19.7" x 24")



Our Series Two Textile range features a linear pattern for a distinct modern look.

## **Nevada** LLT205

Nevada's **smoky charcoal tones** pair perfectly with clean white modern furnishings and pastel colours.



Pennsylvania LLT204



Nevada LLT205

## Things to know about Karndeans LooseLay

Karndeans LooseLay can be installed on any subfloor that is flat, level, smooth and dry. Your fitter must allow at least 48 hours for Karndeans LooseLay to acclimatise to the room it will be fitted in.

We recommend your fitter uses a tackifier or pressure sensitive adhesive to secure Karndeans LooseLay around the edges of the room and at thresholds (Installation guidelines are available at [www.karndeans.com](http://www.karndeans.com)).

Maintaining Karndeans LooseLay couldn't be easier, regular cleaning with a pH neutral cleaner such as Karndeans Clean will help keep your floor at its best.

With a residential guarantee of 15 years, you can rest assured your floor will last for years to come. Unlike real wood and stone, it won't splinter, warp or crack.

## Where to see Karndeans LooseLay

Visiting our showroom or one of our retail partners is the perfect way to look at all of the designs, speak to a flooring expert, and see the friction grip backing in action. You'll also be able to take home Karndeans LooseLay samples so you can match it to the colours in your home, giving you complete confidence you've picked the perfect floor.

### Find a Retailer

Simply visit our website at [www.karndeans.com/FAR](http://www.karndeans.com/FAR) where you can select a local retailer of your choice and arrange for them to contact you.

### Visit our Evesham showroom

Just off the A46 at Vale Park Business Centre, Evesham.

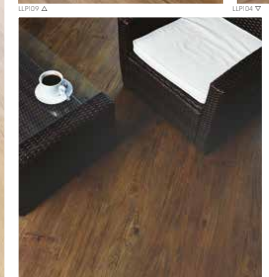
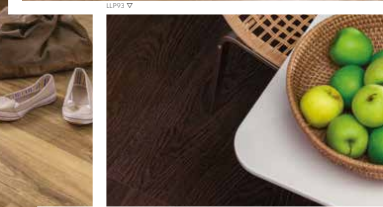
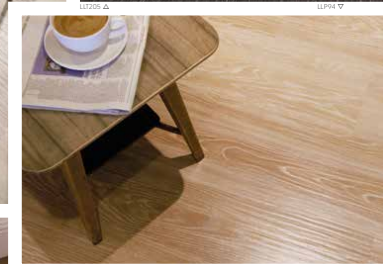

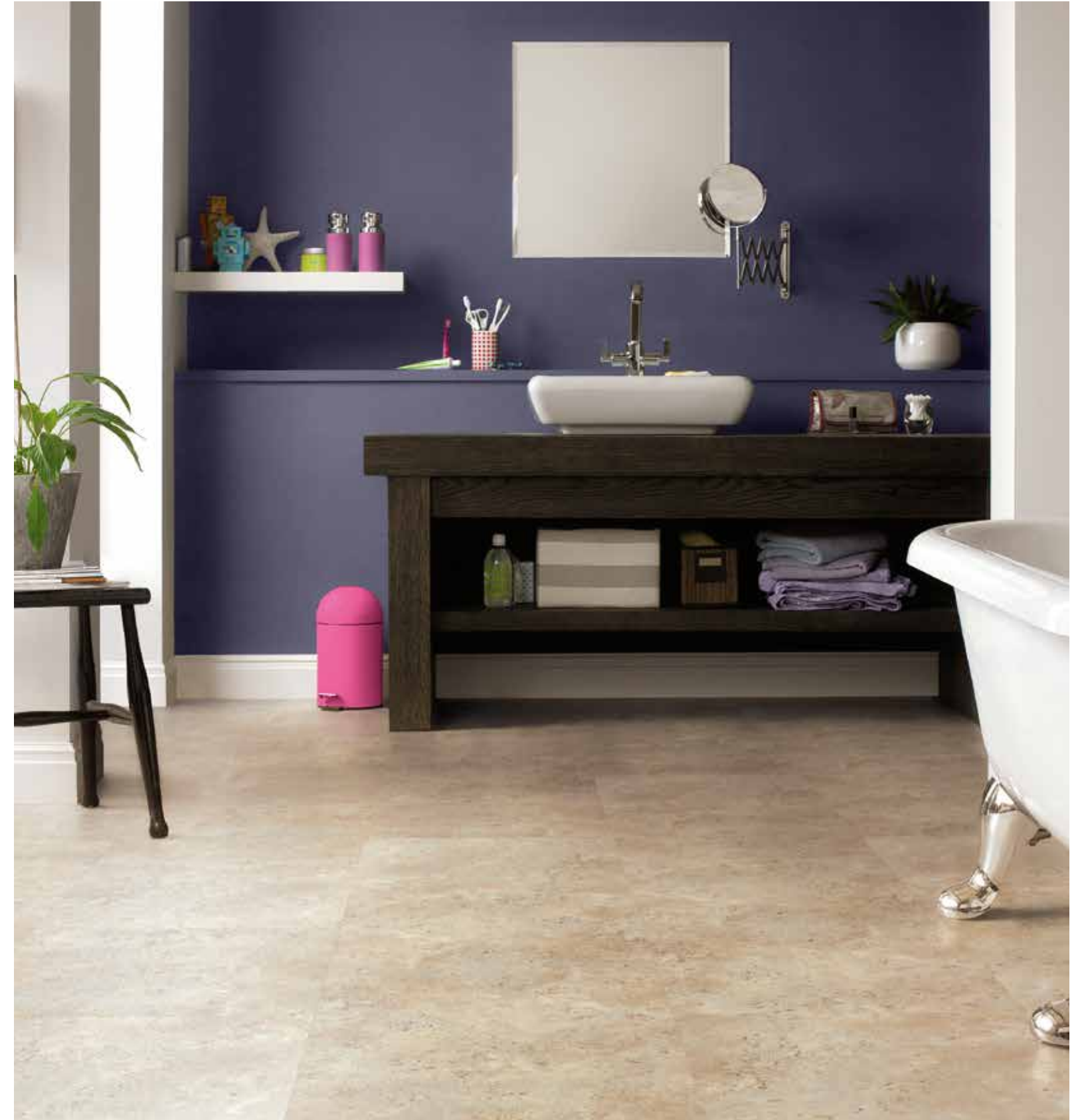

## Contact us...

Crab Apple Way  
Evesham  
Worcestershire  
WR11 1GP

Tel: 01386 820100\*  
info@karndean.co.uk  
www.karndean.com

\*Calls may be recorded for  
training and quality purposes.

Follow us online and see  
what we've been up to:



**Karndean**  
Designflooring



Karndean  
LooseLay