

Job No: F23341  
 Name: ANGELS  
 Address: 6 LONDON WALK  
 W12 9AP  
 Tel:  
 Sheet: 1 OF 2

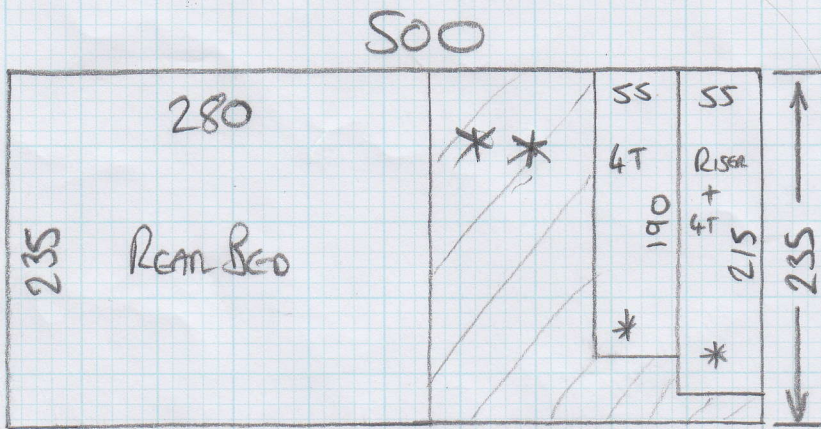

KATSU

130

235 x 500

= 11.75m<sup>2</sup>

\* STAIRS AS 55cm WIDE  
 BOUND RUNNER.

RUNNER IN (2) PIECES -

PLEASE MATCH UP DESIGN

\*\* (PLENTY OF CARPET)

2.15 x 0.55cm

1.90 x 0.55cm

TOP STAIRS

~~RISER = 15 x 70~~  
~~4T @ 41 x 73~~ } NOT THESE

Job No: F 23341  
 Name: ANGEL  
 Address: 6 LANDOR WALK  
 W12 9AP  
 Tel: \_\_\_\_\_  
 Sheet: 2 OF 2

1ST FLIGHT OF STAIRS

RISER = 18 x 70 } AS RUNNER  
 8T @ 43 x 74 } LEAVE 10cm  
 GAP EACH SIDE

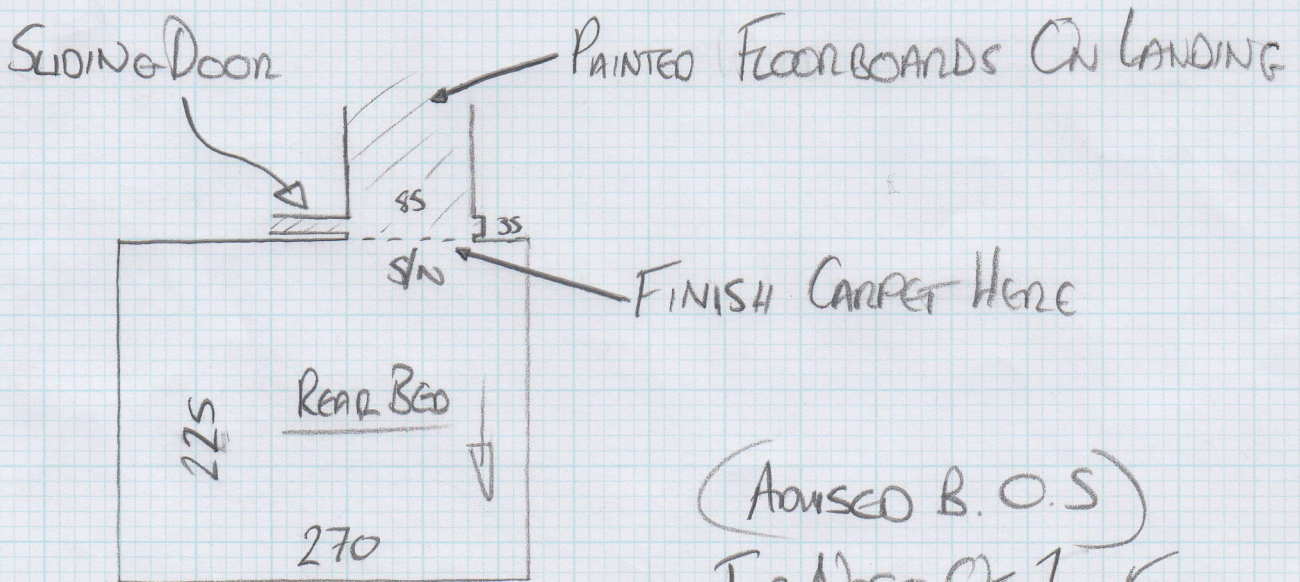

(ADVISED B.O.S)

- TOP NOSE OF 1ST FLIGHT TO BE PAINTED
- LOOSE FLOORBOARDS IN REAR BEO
- NO DOOR HUNG

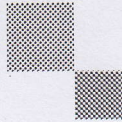

## WHIPPING / BINDING FORM

To be collected by B H Carpets – Tel 020-8665-9110 Fax 020-8665-6611

Customer Name: MR NICK ANGEL

Job No. : F23341

Description of carpet : KATSU 130

Whipping  / Side-Binding  / Top Taping (1/2 & 1/2)

Colour of Binding tape: ORANGE JBH06 Colour of Whipping:                     

Size of Binding tape: 120MM Number of pieces : 2

Sizes To be cut to: 2.15 x 0.55    21.90 x 0.55

Whipping:            metres @ £2.00 per metre = £           

Blind Binding:            metres @ £7.00 per metre = £           

SUPPLY  
Taping Only 8-20 Units @ ~~£6.00~~ per metre = £ 90-20  
3" or 5" Tape 11-00

**Any Queries call**  
Colin John Paul

**Deliver Back to: Unit 19, Riverside Road, SW17**

Mr Carpet Use. (Copy to be faxed to accounts when returned)

Date Collected: \_\_\_\_\_ Collected  
By: \_\_\_\_\_

Date Returned: \_\_\_\_\_ Returned  
By: \_\_\_\_\_

COLLECT WEDNESDAY 26/03/14  
RETURN MONDAY 31/03/14