

Job No: F2A007
 Name: VALMIC PROPERTIES
 Address: 31 CORNWALL COND
 SW7 4AP
 Tel:
 Sheet: 1 of 3

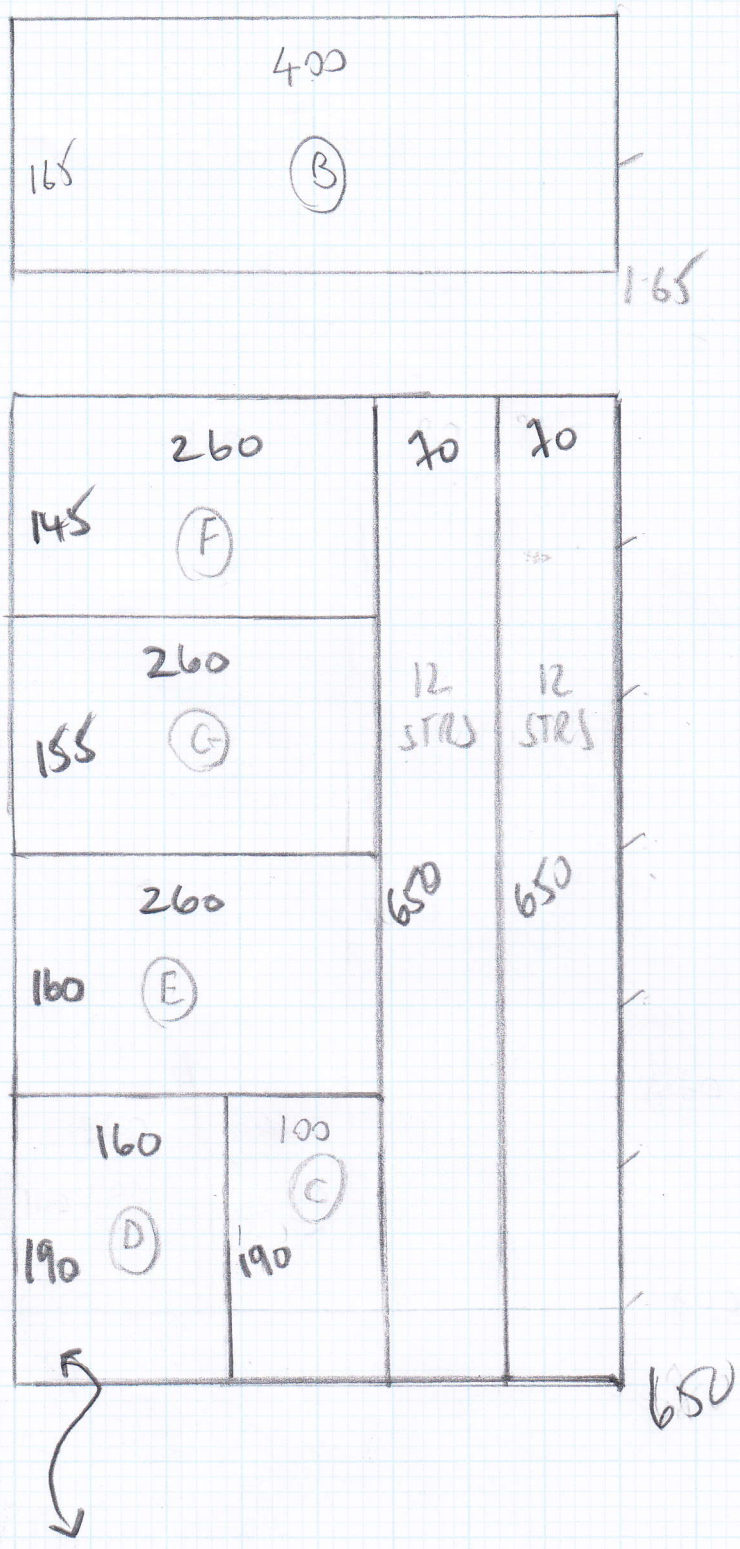

ZEN
 Column 62A

Plan 1 650 x 400
 Plan 2 650 x 400
 LANDING 165 x 400
 B
14.65 x 400

SHARE LANDINGS B, C, D, E, F + G ON SITE

70	70	70	70	120 125 (A)
8 STRJ 410	9+1 STRJ 510	9 STRJ + 1BN 510	10 STRJ 510	25 w3
				70 w8
				80 w7
				70 w1
70 5 STRJ 240				70 125 w2
	60 10x w9	70 BN 2		6x w5
70	80 BN3 105	70 w4		65 w6

650

Job No: **F2A007**
 Name: **VALMIC PROPERTIES**
 Address: **31 CORNWALL GONG**
SW7 4AP
 Tel:
 Sheet: **2 of 3**

Job No: F24007
 Name: VALMVE PROPERTIES
 Address: 31 CORNWALL GARDENS
 SW7 4AP
 Tel:
 Sheet: 3 of 3

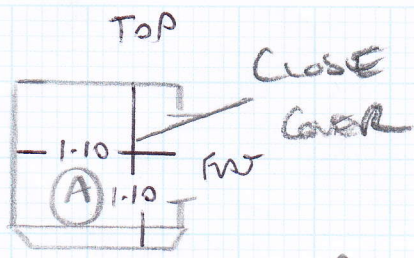

- 9 STRS 74 (R69) RUNNER
 - 1 W 76x60
 - 2 W 98x60
 - 3 W 110x73
 - 4 W 73x63
 - 1 STR 72 (R69)
- CLOSE COVER
 THREE WINDOWS

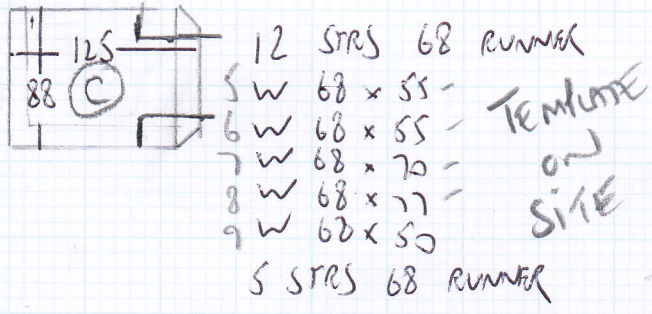
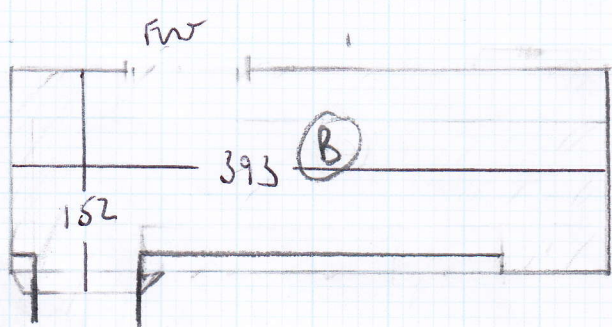

- 12 STRS 68 RUNNER
 - 5 W 68 x 55 -
 - 6 W 68 x 55 -
 - 7 W 68 x 70 -
 - 8 W 68 x 77 -
 - 9 W 68 x 50 -
 - 5 STRS 68 RUNNER
- TEMPLATE ON SITE

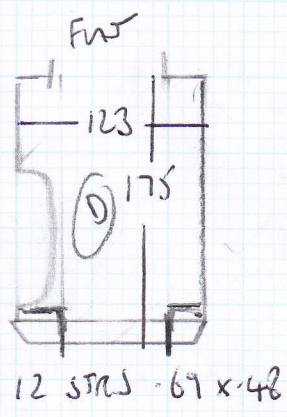
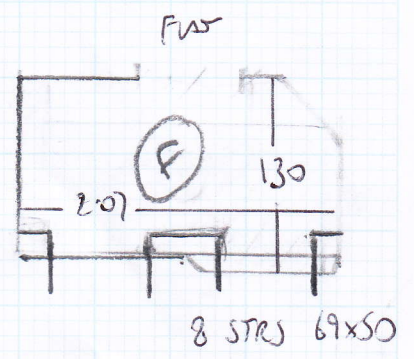

↓ STONE FROM THIS POINT

SHARE LANDINGS TO ACCOMMODATE RUNNERS.
B, C, D, E, F & G

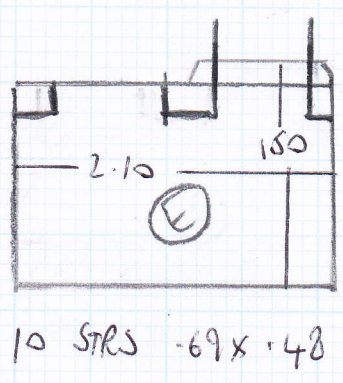

CUT DOWN RUNNERS TO 400MM WIDTH

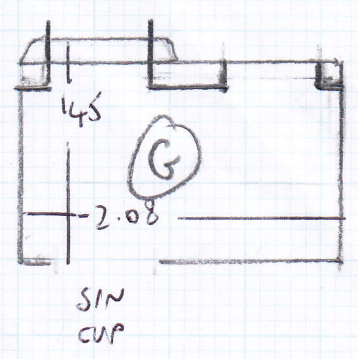

- 9 STRS 69x50
- 1 BN 69x88
- 2 BN 69x60
- 3 BN 69x70

TEMPLATE WINDOWS ON SITE EXCEPT TOP RIGHT - CLOSE COVER

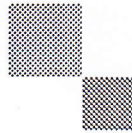

mrcarpet
DESIGNS FOR FLOORS

301 Munster Road
Fulham
SW6 6BJ

Tel Nr: 020-7381-1989
Fax Nr: 020-7385-4006

ROLL BREAKDOWN

Job No: F24007
Customer Name: Valmic Properties
Carpet: Zen
Colour: ZEN 624

Roll 15.00m x 4.00m

Plan 1 6.50m x 4.00m
Plan 2 6.50m x 4.00m
Landing B 1.65m x 4.00m

=====
Total 14.65m x 4.00m
=====

RUNNERS
SIDES ONLY

650 x 70
650 x 70
410 x 70
240 x 70
510 x 70
510 x 70
510 x 70

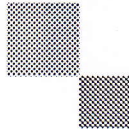

mrcarpet
DESIGNS FOR FLOORS

301 Munster Road
Fulham
SW6 6BJ
T 020-7381-1989
F 020-7385-4006

+ SWINDERS AS PER TEMPLATES

WHIPPING / BINDING FORM

To be collected by B H Carpets – Tel 020-8665-9110 Fax 020-8665-6611

Customer Name: VAMIC PROPERTIES

Job No. : F2A007

Description of carpet : 2000 VELVET 624 GREEN

Whipping / Side Binding / Top Taping (1/2 & 1/2)

Colour of Binding tape: Beige Colour of Whipping : —

Size of Binding tape: 38mm Number of pieces : 12

Sizes To be cut to: 7 x RUNNERS + SWINDERS

Whipping: _____ metres @ £2.00 per metre = £ _____

Blind Binding: 77 metres @ £7.00 per metre = £ 539.00

Taping Only
3" or 5" Tape _____ Units @ £6.00 per metre = £ _____

Any Queries call

Colin John Paul

Deliver Back to: Unit 19, Riverside Road, SW17

Mr Carpet Use. (Copy to be faxed to accounts when returned)

Date Collected: _____ Collected

By: _____

Date Returned: _____ Returned

By: _____

LADINGS X 8 PIECES

AS MAILED

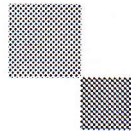

mrcarpet

DESIGNS FOR FLOORS

301 Munster Road

Fulham

SW6 6BJ

T 020-7381-1989

F 020-7385-4006

WHIPPING / BINDING FORM

To be collected by B H Carpets – Tel 020-8665-9110 Fax 020-8665-6611

Customer Name: VALMIC INDUSTRIES

Job No. : F2A007

Description of carpet : ZEN VIKING 62A GREEN

Whipping / Side Binding / Top Taping (1/2 & 1/2)

Colour of Binding tape: _____ Colour of Whipping : _____

Size of Binding tape: 38mm Number of pieces : 8 LADINGS

Sizes To be cut to: AS SUPPLIED -

Whipping: _____ metres @ £2.00 per metre = £ _____

Blind Binding: 20 metres @ £7.00 per metre = £ 140/-

Taping Only
3" or 5" Tape _____ Units @ £6.00 per metre = £ _____

Any Queries call

Colin John Paul

Deliver Back to: Unit 19, Riverside Road, SW17

Mr Carpet Use. (Copy to be faxed to accounts when returned)

Date Collected: _____ Collected
By: _____

Date Returned: _____ Returned
By: _____