

Job No: F24943
 Name: SARAH MAITLAND - GARDEN
 Address: 49D NEW KINGS RD
 LONDON SW 6 4SE
 Tel: 020-7381-1989
 Sheet: 1 of 2

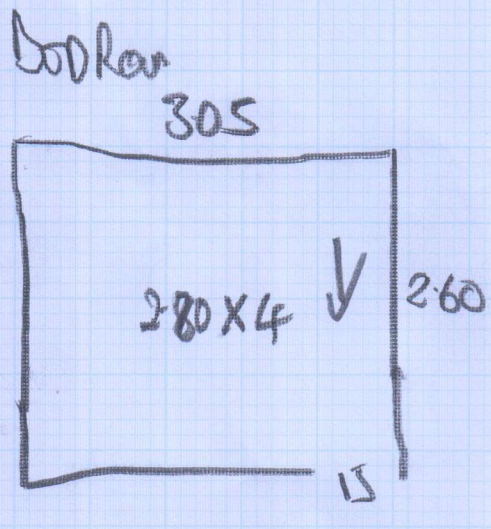

CONCRETE floor
 15 INCH

- 1.502 - 20 X 60
 (3) ST - 47 X 60 (87)
 1/2 LAMP - 110 X 87 X TO BE SHARP

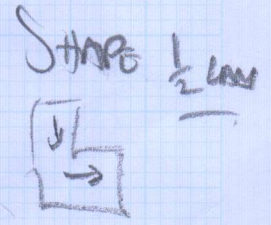

- (2) ST - 47 X 60
 W1 - 70 X 97 X
 W2 - 80 X 120 X
 W3 - 75 X 82 X

- ST (3) - 47 X 60 (87)
 W4 - 70 X 97 X
 W5 - 75 X 120 X
 W6 - 75 X 82 X
 ST (2) 47 X 60 (87)
 1/2 LAMP - 110 X 87 X TO BE SHARP
 2ST - 47 X 60
 10 - 47 X 60

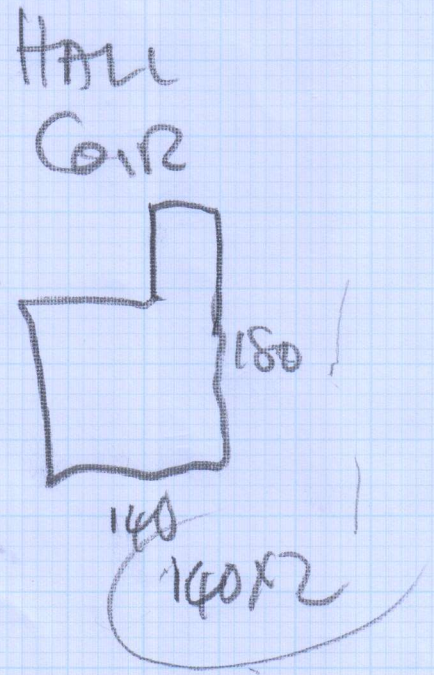

Job No: F 24943
 Name: SARAH NAITHANO-CARON
 Address: 49 D NEW KINGS ROAD
 LONDON SW6 4SE
 Tel: 07976-706734
 Sheet: 2 of 2

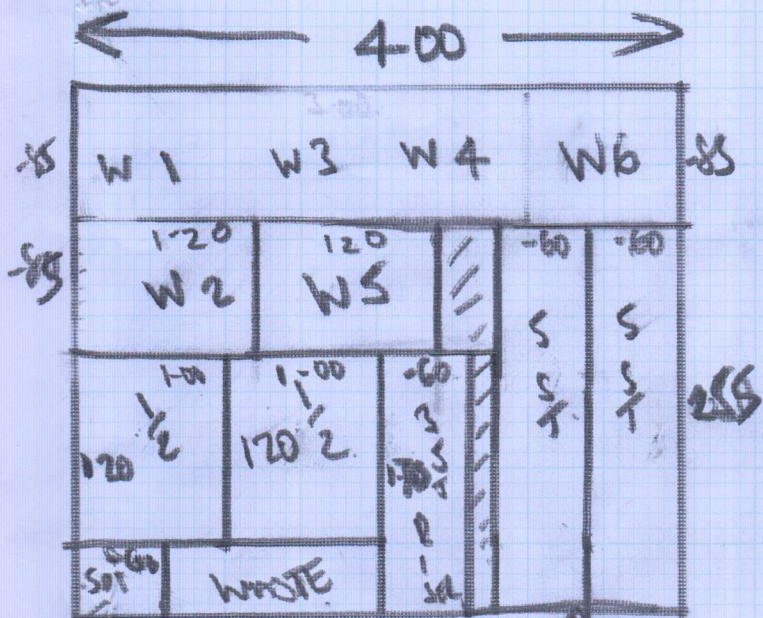

DNOSE
 CUT ON SITE
 CUT ON SITE TO LEAVE UP STAIRS

* CUSTOMER TO ATTEND TO HOLE IN STEP (SEE PHOTO)

LANDING + STAIRS (WOOD)
 3.40 X 4.00
 40 LIN. WHIPPING.
 FITTER CALL OUT TO JAMB WINDOWS + 1/2 LANDING

BEDROOM

2.70 X 4.
 CONCRETE FLOOR
 1 SINGLE STICK GLAZED

ENTRANCE

COIL 1-40 X 2 + FIT

* 12 Shaped
Stairs / Landings
+ Winders

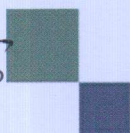

mrcarpet
DESIGNS FOR FLOORS

301 Munster Road
Fulham
SW6 6BJ
T 020-7381-1989
F 020-7385-4006

BH CARPETS - WHIPPING / BINDING FORM

Tel - 020-8665-9110 email: bhcarpets@gmail.com Fax 020-8665-6611

Customer Name: SARAH MAITLAND - CAREW

Job No. : F24943

Description of carpet : MAEDONIA 609/28

Whipping / Blind Binding / Top Taping
~~All Round~~ / Sides only (for Stair Runner) + Shaped landing + winders

Colour of Binding tape: _____

Size of Binding tape: _____

Amount showing on top _____

MUST MATCH
Colour of Whipping : DARKER
STRIDE

Number of pieces: 12

Ready to collect on: 20/06/16 Need back by: 22/06/16

Sizes to be cut to: AS ABOVE

Whipping: 40 metres @ £2.00 linear metre £ 80.00

Apply Tape: _____ metres @ £6.00 linear metre £ _____
(Supplied by MRC)

Blind Taping: _____ metres @ £7.00 linear metre £ _____
(including. Tape)

Trimming Charge (if applicable) £ _____

ANY QUERIES CALL:

Total £ 80.00

John

Graham

Paul

Collect from:
Warehouse / Fulham Shop

Deliver Back to:
Warehouse / Fulham Shop

Mr Carpet Use. (Copy to be faxed to Shop & accounts Dept. when returned)

Date Collected: _____ Collected By: _____

Date Returned: _____ Returned By: _____

Invoice No: _____ Comments: _____