

Job No: F25388
 Name: HOWARD
 Address: FLAT 6 CHURCHFIELD MANS
 321-325 NEW KINGS RD SW6
 Tel:
 Sheet: 1 of 2

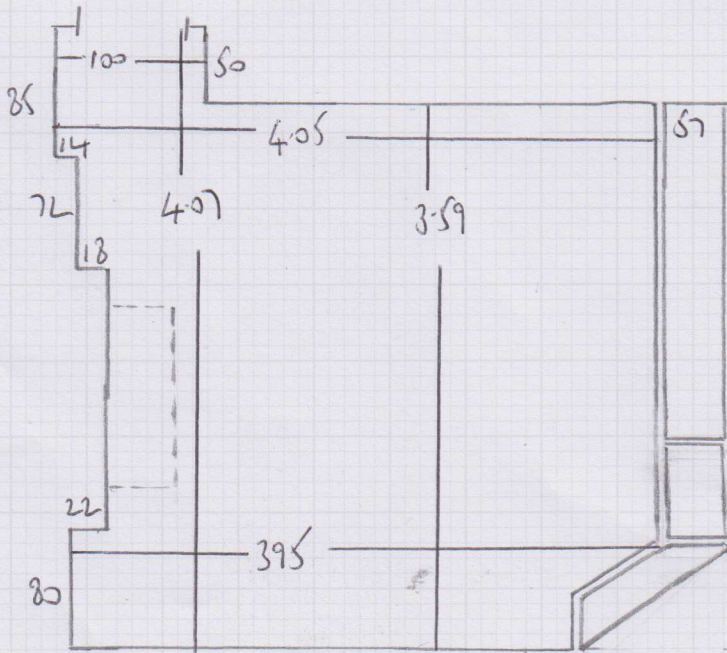
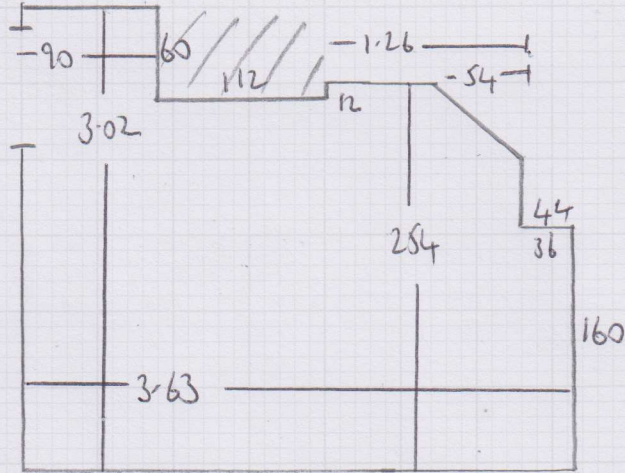

LIVING ROOM RUG
 3.00m x 4.00m

HALL RUGGED
 6.20m x 0.75m

Job No: F25388
 Name: HOWARD
 Address: FW 6 CHURCHFIELD ROAD
 321-325 NEW KINGS RD SW6
 Tel: _____
 Sheet: 2 of 2.

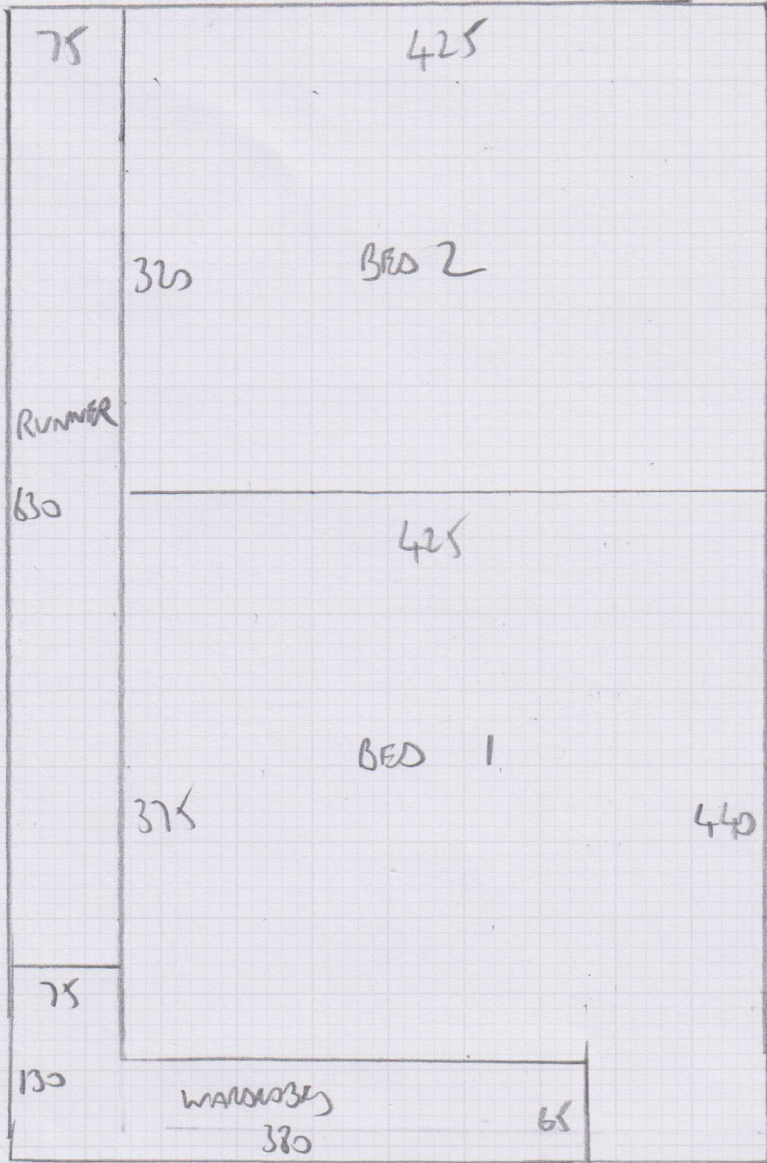

$$7.60 \times 5.00 = 38m^2$$

$$RUC \ 3.10 \times 4.00 = 12.4m^2$$

Whipping & Binding Workshop Instructions



To: **Kasias Carpets Ltd** 07825 156676

Branch: Fulham - Tel: 020 7381 1989 E:fulhambranch@mrcarpet.co.uk

Branch Contact: Graham

Customer Name: Howard

Please quote on invoice

Job No: F25388

Please quote on invoice

Description of Carpet: Fineloop 490

Carpet Finish: Whipping all round

Number of Pieces: 1

Sizes to be cut to: (If applicable) 3.00m x 4.00m

Runner Lengths for Taping: Please check before sewing

Date for collection:

Required back by:

Collection From: Warehouse

Return To: Warehouse

If Tape Selected

Supplied By

Select Supplier (if Appli

Colour of tape:

Size of Tape:

Amount Visible on Top:

If Whipping:

Colour of Whipping: To match

Special Instructions

Sewing charges authorised - Please note only charges authorised in writing will be paid on invoice

Materials	Description	Quantity	Unit Cost	Total
Whipping	Under 3m x 3m	14.00	£2.00	£28.00
	Over 3m x 3m		£2.30	
Standard Taping	Labour Only Under 3m x 3m		£5.00	
	Labour Only Over 3m x 3m		£6.00	
Double Taping	Labour Only Under 3m x 3m		£7.50	
	Labour Only Over 3m x 3m		£8.50	
Faux Suede & Leather	Labour Only Under 3m x 3m		£6.00	
	Labour Only Over 3m x 3m		£7.00	
Mitres Cotton	Per Corner		£2.50	
Mitres Leather	Per Corner		£4.00	
Blind Stitching	38mm Tape Labour & Tape		£9.50	
Hidden Stitching	Additional cost per lin M to above prices (Enter the same quantity as tape quantity)		£1.00	

Materials & other charges

Quantity	Description	Quantity	Unit Cost	Total
	Padding		£1.00	
	Chenille Tape 120mm		£3.50	
	Chrome Tape 120mm		£3.00	
	Cotton Tape 70mm		£2.50	
	Cotton Tape CK 120mm		£3.00	
	Cotton Tape Calibra 120mm		£2.50	
	Cotton Tape HB 120mm		£3.50	
	Faux Leather 120mm		£5.00	
	Faux Suede 120mm		£4.00	
	Goblin GLV 120mm		£3.50	
	Jute 120mm		£2.50	
	Leather 120mm		£12.00	
	Pipeline		£2.50	
	Starline (Linen) LS 120mm		£5.00	
	Superstrong 120mm		£5.00	
	Slim 120mm		£2.50	
	Teakline 120mm		£5.00	
			Sub Total	£28.00
			VAT @ 20%	£5.60
			Total	£33.60

Whipping & Binding Workshop Instructions



To: **Kasias Karpets Ltd** 07825 156676

Branch: Fulham - Tel: 020 73811989 E:fulhambranch@mr-carpet.co.uk
Branch Contact: Graham

Customer Name: Howard **Please quote on invoice**

Job No: F25388 **Please quote on invoice**

Description of Carpet: Finelooop 489

Carpet Finish: Whipping all round

Number of Pieces: 1

Sizes to be cut to: (If applicable) 6.20m x 0.75m

Runner Lengths for Taping: **Please check before sewing**

Date for collection: Required back by:

Collection From: Warehouse Return To: Warehouse

If Tape Selected Supplied By Select Supplier (if Appli

Colour of tape: Size of Tape: Amount Visible on Top:

If Whipping:

Colour of Whipping: To match

Special Instructions

Sewing charges authorised - Please note only charges authorised in writing will be paid on invoice

Materials	Description	Quantity	Unit Cost	Total
Whipping	Under 3m x 3m	14.00	£2.00	£28.00
	Over 3m x 3m		£2.30	
Standard Taping	Labour Only Under 3m x 3m		£5.00	
	Labour Only Over 3m x 3m		£6.00	
Double Taping	Labour Only Under 3m x 3m		£7.50	
	Labour Only Over 3m x 3m		£8.50	
Faux Suede & Leather	Labour Only Under 3m x 3m		£6.00	
	Labour Only Over 3m x 3m		£7.00	
Mitres Cotton	Per Corner		£2.50	
Mitres Leather	Per Corner		£4.00	
Blind Stitching	38mm Tape Labour & Tape		£9.50	
Hidden Stitching	Additional cost per lin M to above prices (Enter the same quantity as tape quantity)		£1.00	

Materials & other charges

Quantity	Description	Quantity	Unit Cost	Total
	Padding		£1.00	
	Chenille Tape 120mm		£3.50	
	Chrome Tape 120mm		£3.00	
	Cotton Tape 70mm		£2.50	
	Cotton Tape CK 120mm		£3.00	
	Cotton Tape Calibra 120mm		£2.50	
	Cotton Tape HB 120mm		£3.50	
	Faux Leather 120mm		£5.00	
	Faux Suede 120mm		£4.00	
	Goblin GLV 120mm		£3.50	
	Jute 120mm		£2.50	
	Leather 120mm		£12.00	
	Pipeline		£2.50	
	Starline (Linen) LS 120mm		£5.00	
	Superstrong 120mm		£5.00	
	Slim 120mm		£2.50	
	Teakline 120mm		£5.00	
			Sub Total	£28.00
			VAT @ 20%	£5.60
			Total	£33.60