

F27456
 CHESTER
 ST TAMMUNITE Rd
 SW16 SW

1-2

195 Tel head 240 MEEL LAND	105 10 LAND 310	100 7 STAND 325	100
195 Tel head 270 MEEL LAND	105 2 STAND WASTE	100 4 STAND 185	10 STAND x RIVER COURT RIVER 510

STANDS + LANDS
 BUSTON
 COURT BAS-024
 ROW 510 x 500
 25 SD MR

Let down to
 60 CM Lumber

TAPE HD 8332

F27AS6
 CHESTER
 57 TANKERVILLE RD
 SW16 5LW

2-2

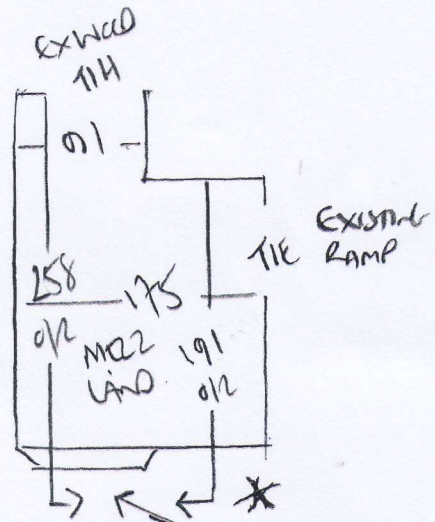
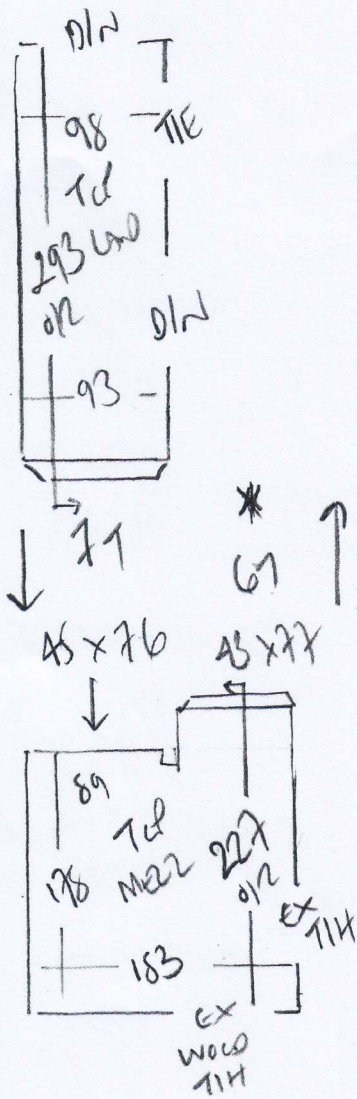

SCOTIA BRIDGE
 TUBE REMOVED
 ON RISER

60cm
 RISSER
 (TAPED) } RISER
 17 x 76
 107
 46 x 76

CONCRETE

FRONT DOOR 85 x 135 140 x 1m
 BACK DOOR 67 x 227 230 x 1m

WOODWORK

UPPER LEVEL FLOOR (MARRAS) ON PULPERS
 NEW SILL TO 185 FRONT FOR RISER