

F28180
 BALBA
 28 KINNUW/LOD
 W68NQ

1 OF 1

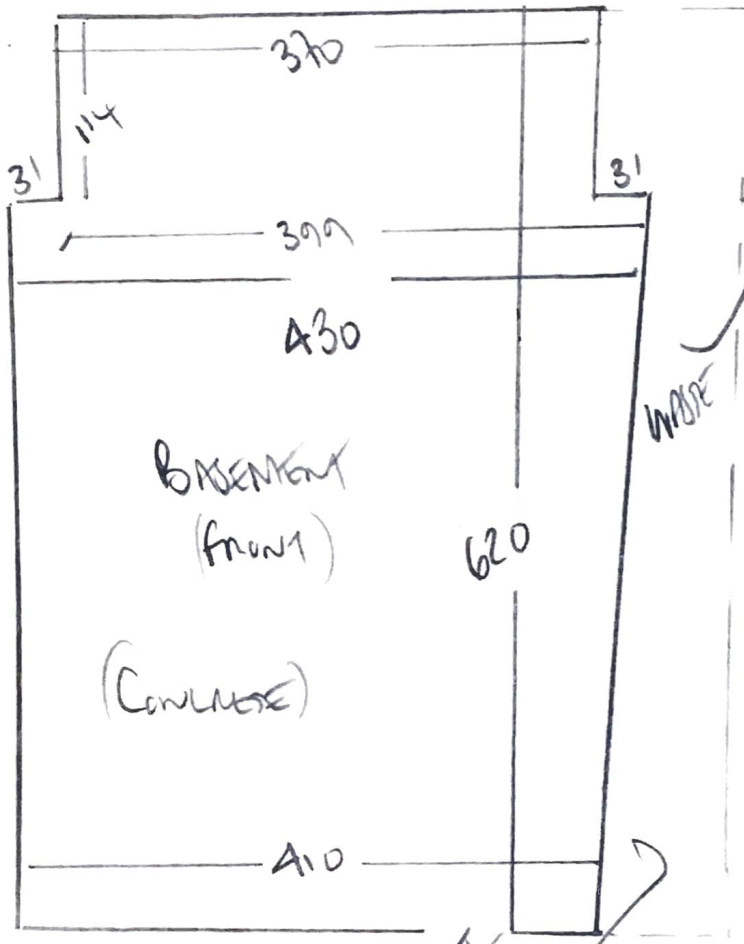

FINE LIFT
 COUCH FOR SOFA

635 x 500

3175 m²

CONCRETE FLOOR
 MUST STICK STEEL + DOUBLE
 WATER PIPE UNDER FLOOR HEATING!

DO NOT PIN ANY GRIPPER
DO NOT PIN DOORBAR!

USE WASTE TO MAKE RUG
 520M x 60CM

- 1) WHIPPED AIR RUND
 - 2) 120MM TAPE x A x MITTED CORNERS.
- 12 LIN METRES TAPE