

F29056
 ELLIS
 54 PERRYMAN STREET
 SW6 3SP

BASEMENT REN

1 OF 3

STEP UP TO MEDIA ROOM

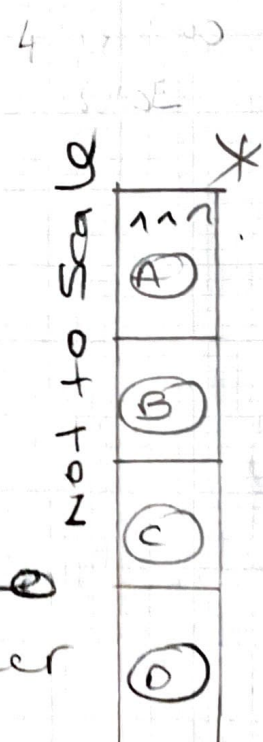
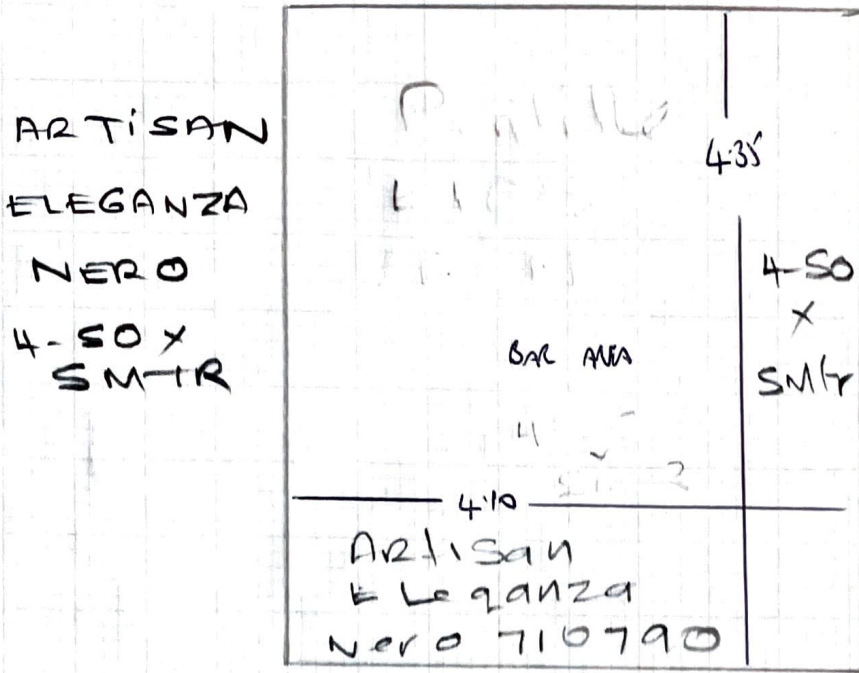

cut down to
 62cm Runner

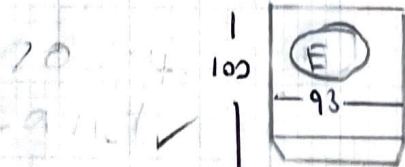

4-00				
70	70	70	70	1-20
(A)	(B)	(C)	(D)	LAND
57	57	62	62	(E)
CM	CM	CM	CM	62
				CM
T	T	T	T	cut
				TO
				1-20
				62 CM

* All
 Runners +
 Landings
 62cm

Must match up
 herringbone

A+B 1st flight 57cm

C+D Bas " 62cm

E Landing = 1-20 x 62cm

MUST MATCH