

F29802  
 COCKCROFT  
 2A ATALANTA ST  
 SW6 3TB

1 of 2

YORK YOR-228

$$\begin{array}{r}
 2.5\phi \\
 3.4\phi \times 4\text{mtr} \\
 1.55 \\
 \hline
 7.45 \quad (29.8\phi\text{m}^2)
 \end{array}$$

COIR TO REPLACE  
 EXISTING MAT.

EXISTING BARS TO BE RE-USED

CUPBOARD PLINTH IN BED 2 TO BE FIXED  
 PRIOR TO YOUR ARRIVAL AS WAS LOOSE  
 TOWARDS THE EN-SUITE BATHROOM END.

F29842  
 Cockcroft  
 2A ATALANTA ST  
 SW6 3TB

2 of 2

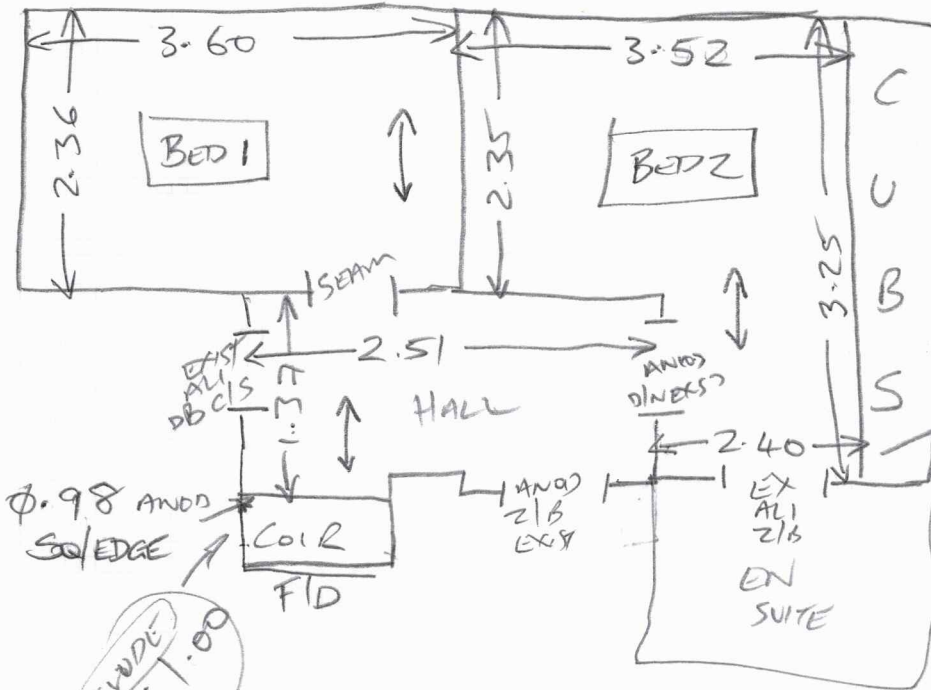

Area: Bed 1  
 Floor: ~~Wood~~ / Conc /       
 S/Edge: Existing / ~~Reqd~~  
 U/lay: Existing / ~~Reqd~~  
 Uplift: Yes / ~~No~~  
 Furn: Yes / ~~No~~  
 Door: OK / ~~Needs Cutting~~  
 UFH: ~~Yes~~ / No  
 Notes:

Area: Bed 2  
 Floor: ~~Wood~~ / Conc /       
 S/Edge: Existing / ~~Reqd~~  
 U/lay: Existing / ~~Reqd~~  
 Uplift: Yes / ~~No~~  
 Furn: Yes / ~~No~~  
 Door: ~~OK~~ / Needs Cutting  
 UFH: ~~Yes~~ / No  
 Notes: BED + CLOTTIES

Area: HALL  
 Floor: ~~Wood~~ / Conc /       
 S/Edge: Existing / ~~Reqd~~  
 U/lay: Existing / ~~Reqd~~  
 Uplift: Yes / ~~No~~  
 Furn: ~~Yes~~ / No  
 Door: OK / ~~Needs Cutting~~  
 UFH: ~~Yes~~ / No  
 Notes:

Area:       
 Floor: Wood / Conc /       
 S/Edge: Existing / ~~Reqd~~  
 U/lay: Existing / ~~Reqd~~  
 Uplift: Yes / No  
 Furn: Yes / No  
 Door: OK / Needs Cutting  
 UFH: Yes / No  
 Notes:

Area:       
 Floor: Wood / Conc /       
 S/Edge: Existing / ~~Reqd~~  
 U/lay: Existing / ~~Reqd~~  
 Uplift: Yes / No  
 Furn: Yes / No  
 Door: OK / Needs Cutting  
 UFH: Yes / No  
 Notes:

INCLUDE  
 \$ 70 + COIL

REUSE BARS  
 REPLACE COIL

QUOTE

- ① YORK YOR-278
- ② GHENT GHL-02