

# Cutting Plan

Job No: F29935  
 Name: Guy & Ginja  
 Address: SIMMONDS  
 54 NETHERAWEN  
 Tel: ED  
 Sheet: W4 2NB  
 1 OF 2

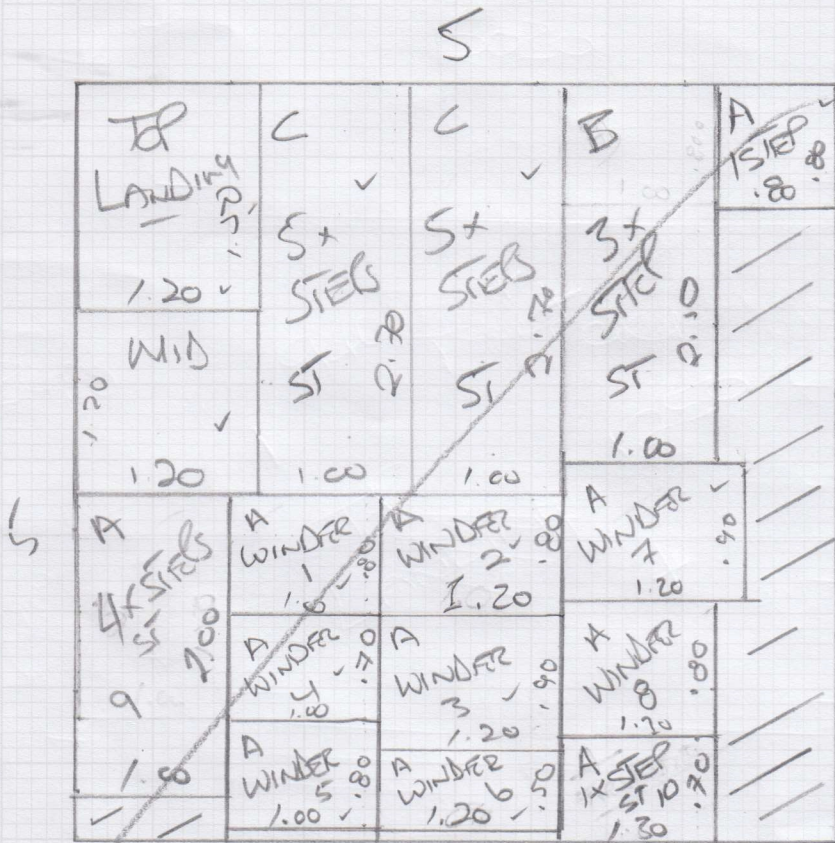

~~5x5 = 25m<sup>2</sup>~~

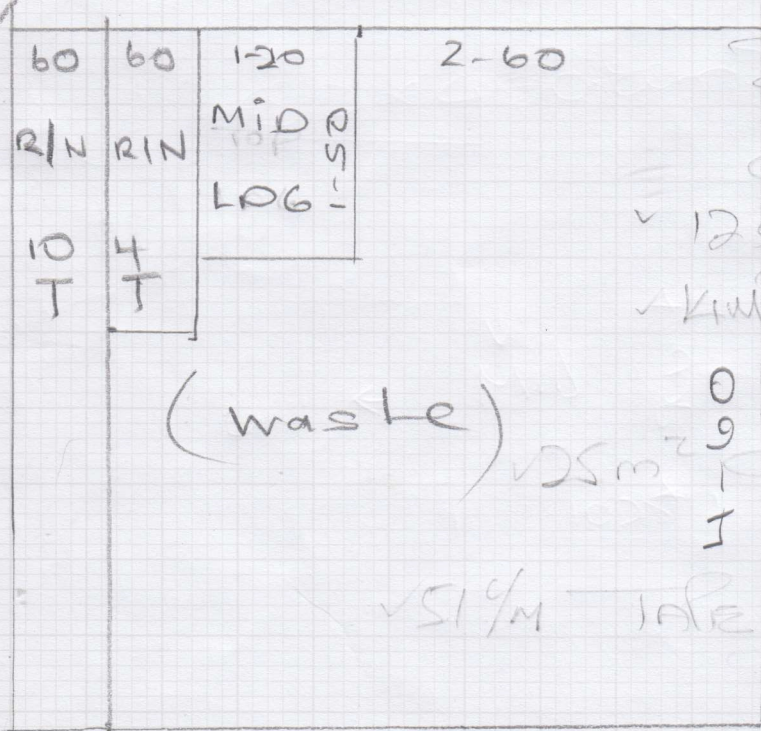

(waste)

Runner to be cut 4-60 x 5m<sup>2</sup> E  
 12 x ZAMBIA E114  
 4 x IMPERIAL (IMPERIAL E40012)  
 1 x IMPERIAL T40010  
 1 x IMPERIAL T40010  
 1 x IMPERIAL T40010  
 1 x IMPERIAL T40010

\* Carpet sent in oversized \*

Job No: F20935  
GSM  
FINANCE LTD  
ST NETHERTON  
RD  
W4 2NB  
20F2

SEIKO  
PARKING

12m  
Imperial  
E 40012

1) BRES OK  
C/CHANGE

EMAIL RUNNER  
SLATE

600 WIDE  
RUNNER

2) CUSTOMER UPLIFT  
GOLFER BOTTOM

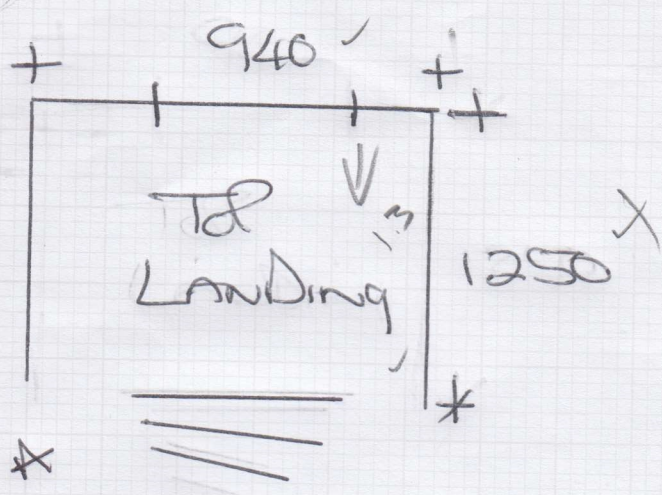

- 1x 790 x 620 First STEP (10) x .48  
TO UNDER  
LANDING ST
- 1x 790 x 480 STR (9) x .35
- 1x 790 x 560 WINDER (1) x .50
- 1x 1090 x 290 WIND (2) x .31
- 1x 1100 x 710 WIND (3) x .781
- 1x 850 x 560 WIND (4) x .51
- 1x 790 x 560 WIND (5) x .50
- 1x 1090 x 290 WIND (6) x .31
- 1x 1090 x 710 WIND (7) x .781
- 1x 840 x 560 WIND (8) x .57
- 3x 790 x 480 STR (9) x 1.08

↓ 1st  
SEC STAIR to  
GROUND

B 3x 800 x 625 STR x

C 860 x 450 x 10 x



|      |      |
|------|------|
| 7.4  | 6.4  |
| 7.4  | 7.4  |
| 7.4  | 50.4 |
| 8.2  |      |
| 6.80 |      |