

THURS 31/10/24

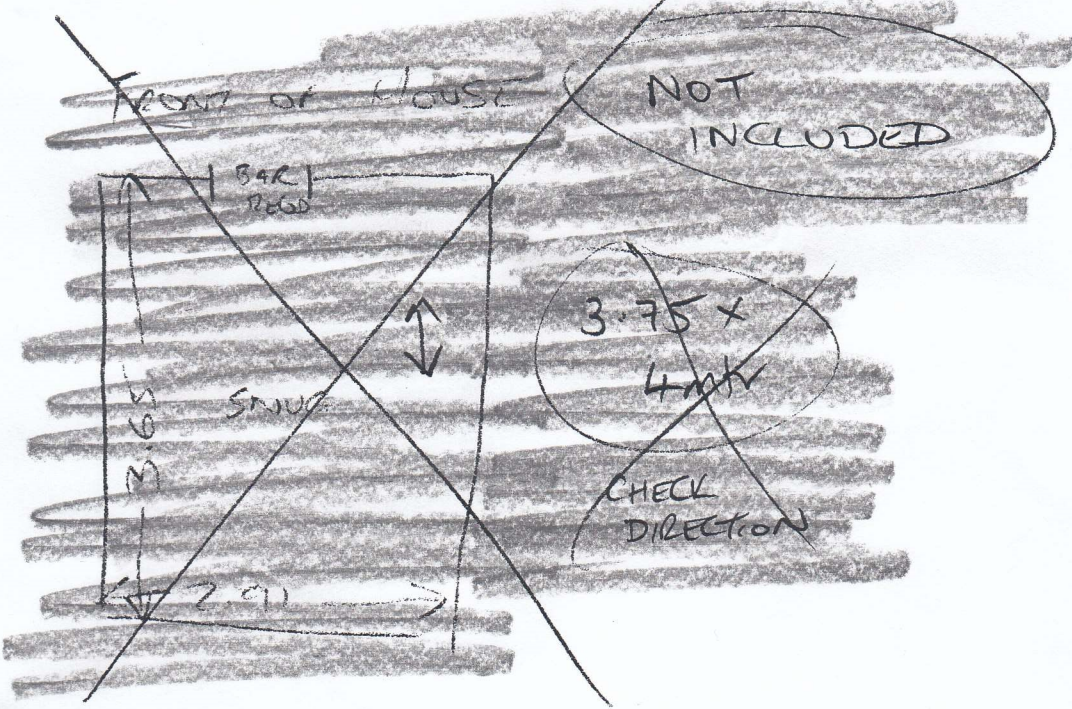

F29947
LITTLE MELLOW
20 REDESDALE S
SW3 4BS

1 of 1

Area: SNUG
 Floor: Wood / ~~Conc~~
 S/Edge: Existing / Reqd / NA
 U/lay: Existing / Reqd / NA
 Uplift: Yes / No / NA
 Furn: Yes / No / NA
 Door: OK / Needs Cutting
 UFH: Yes / No / NA
 Notes:

Area: REDESDALE
 Floor: ~~Wood~~ / ~~Conc~~
 S/Edge: Existing / Reqd / NA
 U/lay: Existing / Reqd / NA
 Uplift: Yes / No / NA
 Furn: Yes / No / NA
 Door: ~~OK~~ / Needs Cutting
 UFH: ~~Yes~~ / No / ~~NA~~
 Notes:

Area: NEW ENGLAND STAMFORD
 Floor: Wood / Conc /
 S/Edge: Existing / Reqd / NA
 U/lay: Existing / Reqd / NA
 Uplift: Yes / No / NA
 Furn: Yes / No / NA
 Door: OK / Needs Cutting
 UFH: Yes / No / NA
 Notes:

Area: ANTIQUE BRASS SIN
 Floor: Wood / Conc /
 S/Edge: Existing / Reqd / NA
 U/lay: Existing / Reqd / NA
 Uplift: Yes / No / NA
 Furn: Yes / No / NA
 Door: OK / Needs Cutting
 UFH: Yes / No / NA
 Notes:

Area: STAIRS
 Floor: Wood / Conc /
 S/Edge: Existing / Reqd / NA
 U/lay: Existing / Reqd / NA
 Uplift: Yes / No / NA
 Furn: Yes / No / NA
 Door: OK / Needs Cutting
 UFH: Yes / No / NA
 Notes:

RETURN UNUSED U/LAY +
ADHESIVE TO WAREHOUSE
FOR NEXT PHASE

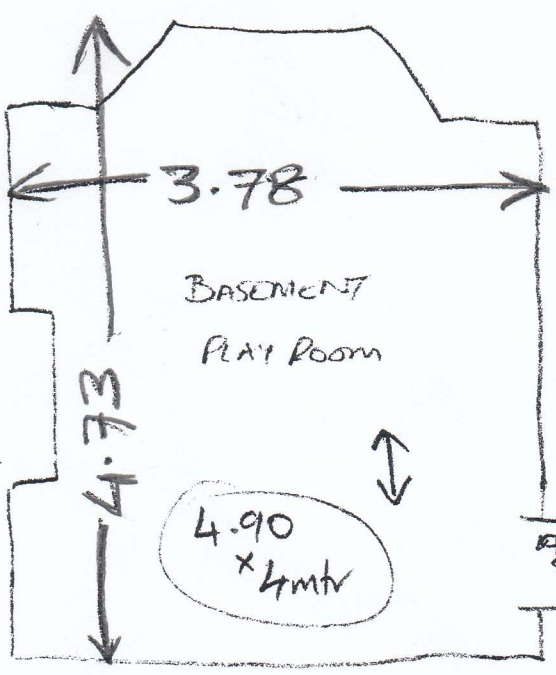

NEW ENGLAND
STAMFORD
4.90 x 4mtr

+ COMPLETE FITTING OF
LANDINGS + TEMPLATE STAIRS
(CHECK 2 STEPS BETWEEN UPPER/LOWER HALL)