

F30579

533388

~~22846~~

Poppin's Nurseries

233 New Kings Rd

1 of 2

Ultima Major

Col. Bluebird

Cut Plan 760x500

= 38M²

~~* REPLACE ALL DOOR BARS TO POLISHED CHROME~~

~~* EXCEPT LIFT ON 2ND FLOOR LND WHERE YOU CAN FIT AN AV. SIGN~~

~~* TAKE 3x9' LENGTHS OF CHROME TILE EDGE THAT TO FIT ON SITE 1x9' LENGTH WILL DO 4x WC DOORS~~

* STAIRS FROM 2ND FLOOR LANDING UP TO THE OFFICES ARE NOT BEING DONE BUT YOU WILL NEED TO OPEN THAT DOOR TO FIT 2ND FLOOR LANDING CARPET UP TO BOTTOM OF THE STAIRS SO ASK JANE FOR THE DOOR AS IT WILL BE LOCKED.

F 30579
~~833388~~
 P284136
 Poppins Nurseries

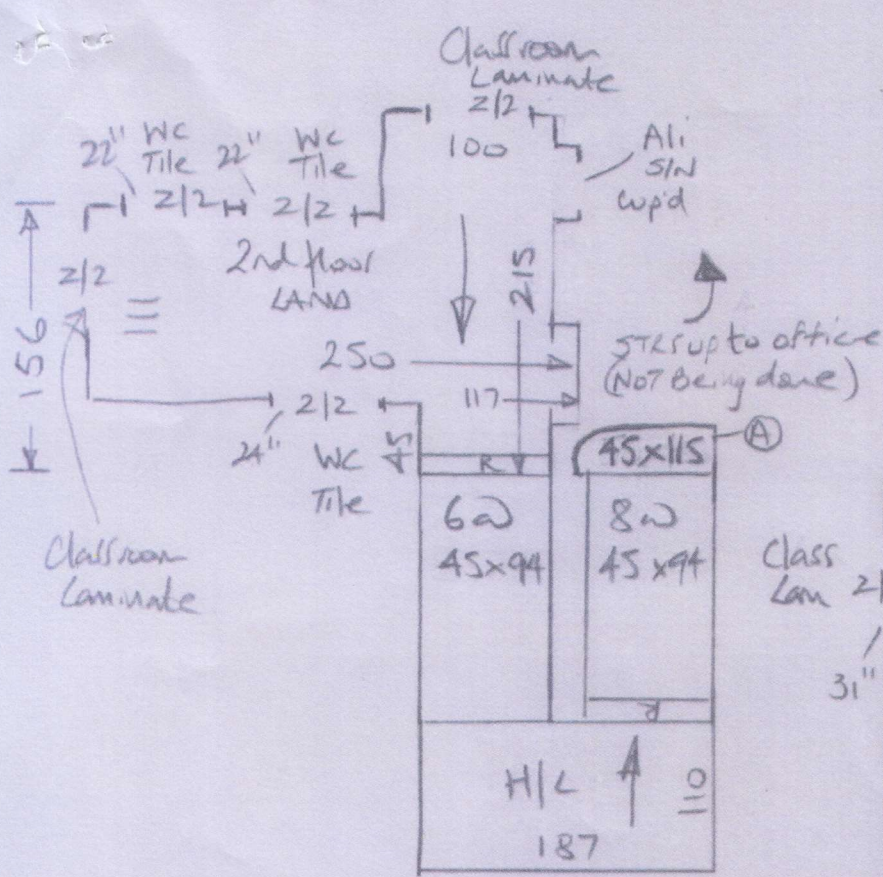

Lot 2

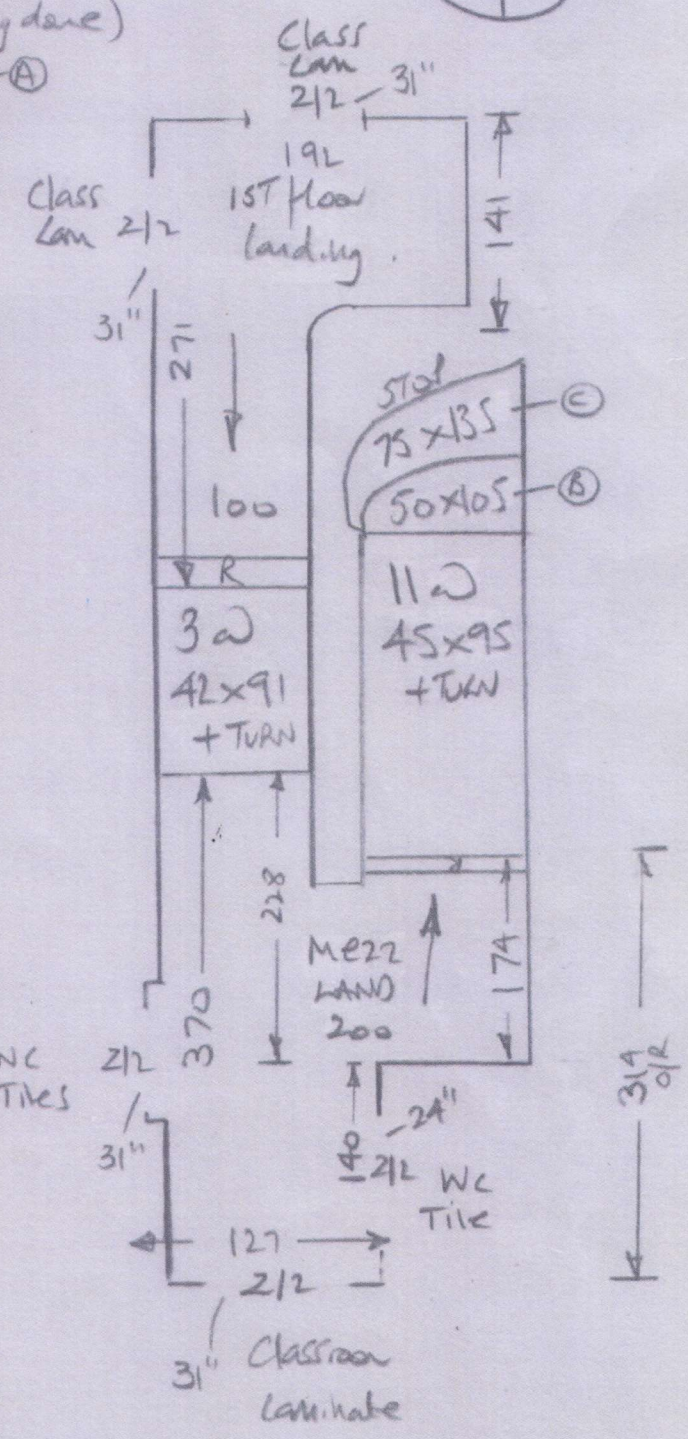

F30579

233 N.K.R

Job No:
Name:
Address:

TOP STAIRS

- w1 = 770
- w2 = 728
- w3 = 638

- 5T {
- 1 = 670
 - 2 = 670
 - 3 = 670
 - 4 = 669
 - 5 = 636

- w4 = ~~764~~ 749
- w5 = 738
- w6 = 650

2ND FLIGHT

2ND LANDING
= 909

- 6T {
- 1 = 938
 - 2 = 938
 - 3 = 937
 - 4 = 941
 - 5 = 939
 - 6 = 902

↑
(OPEN BANISTER)

M/L
= 864

- 8T {
- 1 = 941
 - 2 = 941
 - 3 = 942
 - 4 = 943
 - 5 = 943
 - 6 = 944
 - 7 = 945
 - 8 = 906

1ST FLIGHT

1ST LANDING
= 908

- 3T {
- 1 = 912
 - 2 = 912
 - 3 = 886

M/L
= 839

- 11T {
- 1 = 936
 - 2 = 941
 - 3 = 940
 - 4 = 940
 - 5 = 941
 - 6 = 942
 - 7 = 948
 - 8 = 941
 - 9 = 942
 - 10 = 947
 - 11 = 843

B/N = 1045
D/N = 1315

* 2ND FLIGHTS +
1ST FLIGHTS
ALL OPEN BANISTER
MEASUREMENTS
ARE SIMILAR TO
SPINDLE

B/N = 1134 (TEMPLATE REQ'D)

**accessories
Optimisation Sheet**

GRADUS

Contractor : Mr Carpet Contact : Mr Carpet Order No : Tel : 020 8789 3133 Fax : 020 8780 2140	Distributor : VOLANTE LIMITED Contact : VOLANTE LIMITED Order No : Tel : 0208 9710372 Fax : 0208 9471347															
Site Address : 233 New Kings Road SW6 4XE, SW6 4XE	<table border="1"> <thead> <tr> <th colspan="3">Stock Requirement</th> </tr> <tr> <th>Description</th> <th>Length</th> <th>Quantity</th> </tr> </thead> <tbody> <tr> <td>GR81</td> <td>2750</td> <td>6</td> </tr> <tr> <td>GR81</td> <td>3200</td> <td>4</td> </tr> <tr> <td>GR81</td> <td>2440</td> <td>1</td> </tr> </tbody> </table>	Stock Requirement			Description	Length	Quantity	GR81	2750	6	GR81	3200	4	GR81	2440	1
Stock Requirement																
Description	Length	Quantity														
GR81	2750	6														
GR81	3200	4														
GR81	2440	1														
Measurement Summary Layouts: 11 Waste Factor Saw Cuts: 11 Inc. off-cuts: 6.85% Tot Length: 31740 Exc. off-cuts: 6.85% Tot Cut Length: 29565	Total Labour Cost: £0.00 No of Welded Angles: 0 Additional Trim Lengths: 0															
Comments: Import From Mobile																

Profile Summary : GR81				
Stock Lengths:	Cut Length :	Total Waste:	Not Reusable:	Waste Length:
11	29565	6.85%	6.85%	2175

Layout	Length (mm)	Quantity	Cutting Pattern	Off Cut(mm)
1	2750	1	2 x 944, 1 x 862	0
2	2750	1	1 x 942, 1 x 908, 1 x 900	0
3	2750	1	1 x 941, 1 x 910, 1 x 892	7
4	2750	1	1 x 941, 1 x 909, 1 x 883	17
5	2750	1	2 x 941, 1 x 836	32
6	3200	1	3 x 940	380
7	3200	1	1 x 940, 1 x 939, 1 x 938	383
8	2750	1	1 x 938, 1 x 907, 1 x 904	1
9	3200	1	1 x 938, 2 x 937	388

Please note that optimisation is based on extra 20mm, this is not guaranteed

10	3200	1	1 x 936, 2 x 935	394
11	2440	1	1 x 934, 1 x 933	578

Please note that optimisation is based on extra 20mm, this is not guaranteed