

F30857

2nd call of 5

Notes for Measure

Estimator: Chris

Mrs Aurelie Brelibet, 119 Moore Park Road

1

Date of Measure: Fri, 27 Feb 26

At: 10:30-11:00

Site Address:

119 Moore Park Road
Fulham

LONDON SW6 2HH

CONTACT: As customer details

Mobile	Home	Office
07775-894181		

Customer Address:

119 Moore Park Road
Fulham
LONDON

SW6 2HH

Email:

Areas to be done and Description of Measure

2 x Stairs as Runners

See email she's sent.

Instructions and Estimators comments

Customer has details of carpet she would like and will email it over

Must Read!

Builders on Site

Office Ref: F30857

Mrs Aurelie Brelibet, 119 Moore Park Road

Date of Measure Fri, 27 Feb 26

At 10:30-11:00

Floor: Wood / Concrete / other _____

S/edge: Wood/Concrete/No pin/existing (if existing, allow __ sticks to supplement where necessary)

Sticking Req'd: Yes/No Type: Fastset/Other *NEW*

Underlay: Re-use Existing / New required

Type: 42oz Felt / Fomalux / PU Foam / Luxury PU Foam / LowTog / Durafit

Doorbars: Alloy / Satin Ali / Polished Ali / Anod / Solid Brass / Chrome / Nisheen
Seam/Wood/T/Holds: colour _____

Door Clearance: OK / Low (advise on quote) *Not on*

Uplift: No / Yes (if "Yes" - what type?) _____

Furniture: No/Yes (if YES, please specify the following) - 1 man / 2 men (Fitter to get paid) £ _____ total/per room

Parking Cost: Free / £ 7 per hour

Parking Restrictions: (type) / £ _____

Congestion Zone: No / Yes

Access: Easy / Hard / 2 men req'd / _____ floor?

Runners: Whipping / Binding (if binding, specify type)

Tape size: 1½" / 2" / 3" / 5"

Style: Top taping / Side binding

Stairrods: Type _____ Nr _____ Size _____

cust to advise on email

Must Read: Builders on Site



Job No:

Name:

Address:

Tel:

Sheet:

of:

Brelibet

F30857

Top floor

Riser @ 35x96

W1 = 85x106

W2 = 105x118

W3 = 70x70

5 @ 50x70



Lower floor

Riser @ 30x71

W4 = 58x71

W5 = 63x92

W6 = 85x97

W7 = 63x72

6 @ 50x74

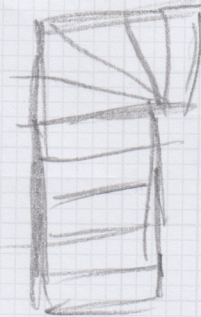

Small Hall? = 54x76 COR MATT