

F30877

2nd call of 4

Notes for Measure

Estimator: Chris

Lucy Peel, 5 Hauteville Court Gardens

Date of Measure: Fri, 27 Mar 26

At: 12-1pm

Site Address:

5 Hauteville Court Gardens

Customer Address:

5 Hauteville Court Gardens

LONDON

W6 0YF

LONDON

W6 0YF

CONTACT:

As customer details

Mobile	Home	Office
07586-129091		

Email:

lucypeel@yahoo.co.uk

Areas to be done and Description of Measure

Bedroom

Instructions and Estimators comments

Lulworth Col LW-33

Must Read!

Not entered

Office Ref: F30877

Lucy Peel, 5 Hauteville Court Gardens

Date of Measure Fri, 27 Mar 26

At 12-1pm

Floor: Wood / Concrete / other Realwood

S/edge: Wood/Concrete/No pin/existing (if existing, allow \_\_ sticks to supplement where necessary)

Sticking Req'd: Yes/No Type: Fastset/Other

Underlay: Re-use Existing / New required

Type: 42oz Felt / Fomalux / PU Foam / Luxury PU Foam / LowTog / Durafit

Doorbars: Alloy / Satin Ali / Polished Ali / Anod / Solid Brass / Chrome / Nisheen Seam/Wood/T/Holds: colour \_\_\_\_\_

Door Clearance: OK / Low (advise on quote) 9mm - told cust to get Carpenter

Uplift: No / Yes (if "Yes" - what type?) \_\_\_\_\_

Furniture: No/Yes (if YES, please specify the following) - 1 man / 2 men (Fitter to get paid) £ \_\_\_\_\_ total/per room 1x DBL BED crew

Parking Cost: Free / £ 7 per hour upto 4hrs

Parking Restrictions: (type) / £ \_\_\_\_\_

Congestion Zone: No / Yes

Access: Easy / Hard / 2 men req'd / 2d floor?

Runners: Whipping / Binding (if binding, specify type)

Tape size: 1½" / 2" / 3" / 5"

Style: Top taping / Side binding

Stairrods: Type \_\_\_\_\_ Nr \_\_\_\_\_ Size \_\_\_\_\_

Must Read: Not entered

Office Ref: F30877

Mr Carpet (London) Ltd



Job No: \_\_\_\_\_  
Name: Peel.  
Address: F30877  
Tel: \_\_\_\_\_  
Sheet: \_\_\_\_\_

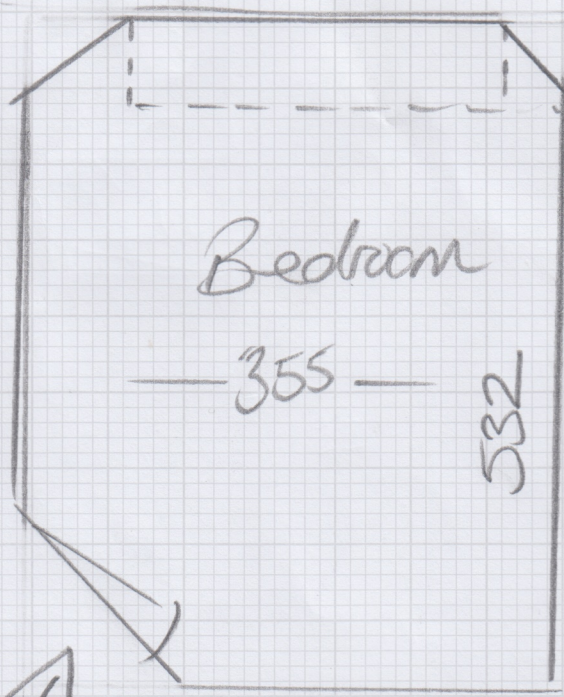

Single to existing wood  
Threshold

Door Very Low. — total <sup>height</sup> to  
— soak