

STAIRCASE

TOP STEP + RISE

55 x 85

WRAP 9 @ 65 x 85

H/L 120 x 220 + ^{ALI} S/N 85

3 @ 43 x 130

~~APPROX RUG SIZE
250 x 180~~

NOT REQUIRED

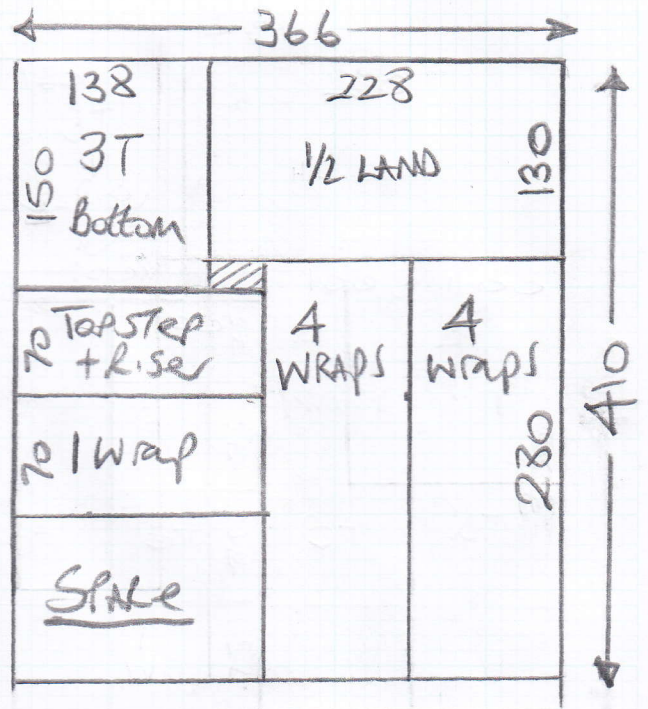

$$= 410 \times 366 = 15m^2$$

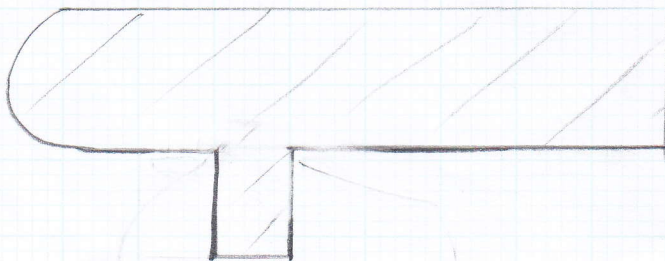

See photo's attached

Mr Carpet (Putney Branch)

P26538

Al-Chalabi

From: Christine Jones [christine.uk@me.com]

Sent: 17 June 2015 09:57

To: Mr Carpet (Putney Branch)

Subject: Re: Stair Carpets

Massive apology for being so late in getting this info to you.



P26538
Al-Chalabi



Sent from my iPhone

On 9 Jun 2015, at 17:04, Mr Carpet (Putney Branch) <putneybranch@mr-carpet.co.uk> wrote:

Hi Christine,

As discussed please can you email me some photos of you staircase so I can work out how best to cover them with carpet & work out a quote

Many thanks
Nigel

Mr Carpet Ltd
70 Lower Richmond Road
Putney
SW15 1LL
T: 020 8789 3133
F: 020 8780 2140
E: putneybranch@mr-carpet.co.uk
www.mr-carpet.co.uk

Interiors Monthly - Best Flooring Retailer - Winners 2013

 Please consider the environment before printing this e-mail