

New Plans

P26860
GEORGE

1 of 2

Hanoi Special

Col. 638/32

Cut Plan 560×400
 $= 22.40m^2$

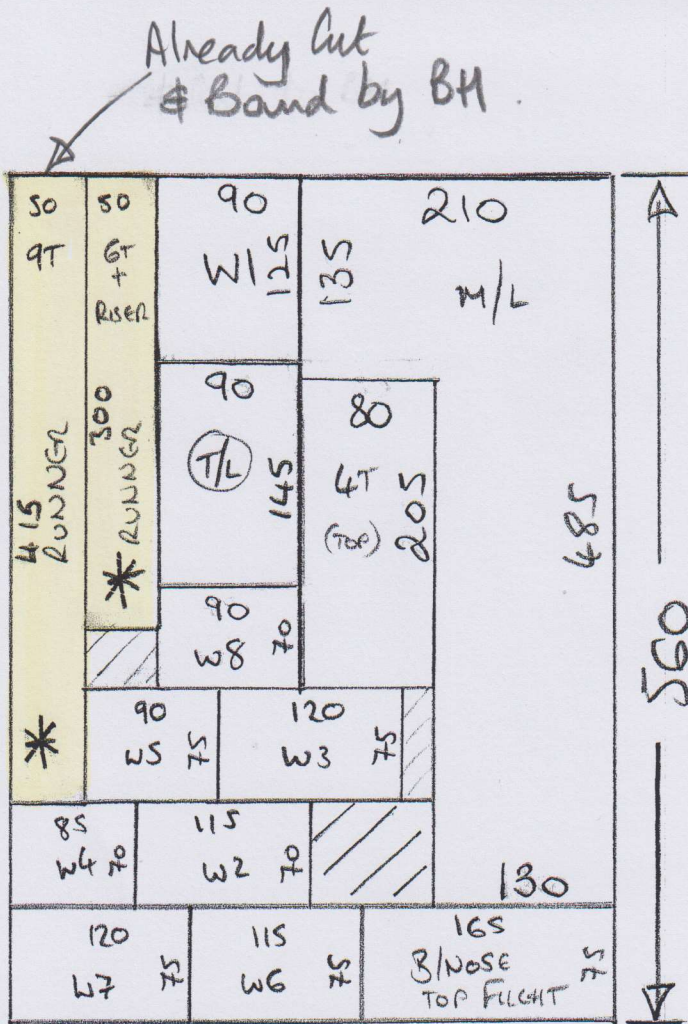

Plan is tight as it had to be adjusted to allow for increased size of M/L since we measured.

* 26/2 (Mike)

Cut Runners to exact sizes & send to BH for Binding ASAP.

MARK up Rest of Cutting Plan & Store it with unfulfilling on 9/3 (Grant)

* TAKE Runners for 1st Flight

P26860
 GEORGE

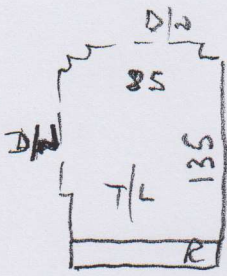

(20/2)

- W1 60 x 80 ✓
- W2 60 x 105 ✓
- W3 65 x 110 ✓
- W4 60 x 75 ✓
- 4@ 46 x 75 ✓
- W5 60 x 80 ✓
- W6 60 x 105 ✓
- W7 65 x 110 ✓
- W8 60 x 75 ✓
- B/N 46 x 105 ✓

Full Width
 on luxury
 PU foam

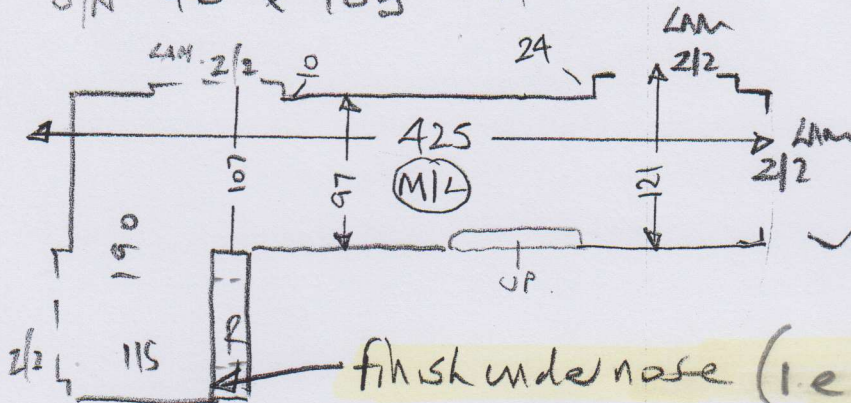

- Riser 20 x 77
- 14 @ 44 x 77
- B/N 45 x 90
 (60cm to curve)

50cm Band Runner
 laid on formalux

* Runner to have 4cm tape
 on both sides.