

Ultragrip Project - Leat 1614

mrcarpets
 Job No: P26935
 Howard de Walden
 Address: Flat 8
 11 Bullstrode St
 W1U 2JE
 Tel:
 Sheet: (4th floor - Rear)

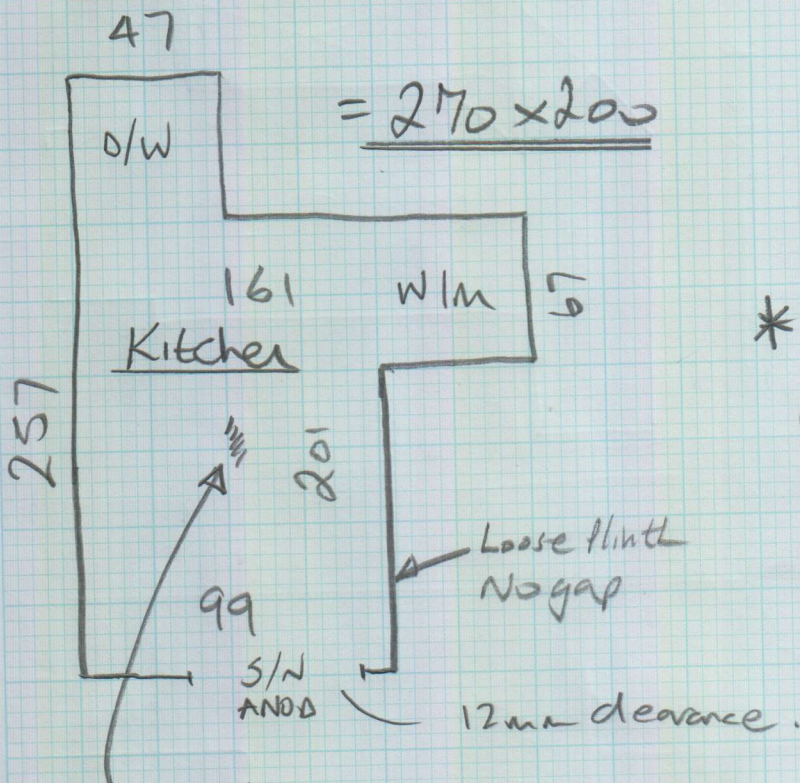

Dip in floor
 Chipboard has given way
 & needs repair.

(Builder to repair floor & lay new plywood)

* New kitchen to be installed (same layout as existing)

* Builder to uplift ex c/floor & lay plywood over damaged chipboard. SKIN with feather first as nec.

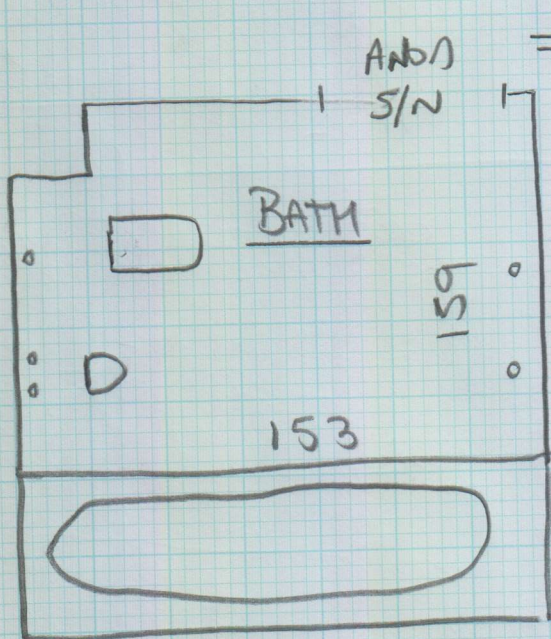

uplift ex c/floor
 laid over plywood screwed down (some screw heads visible through ex vinyl)

* SKIN with feather to cover screw heads

* Apply Mastic Sealant all round.
 Flat is at rear of building. Turn left out of lift