

Pha

Phase 1 - 24/5

Phase 2 - ATEV DATE

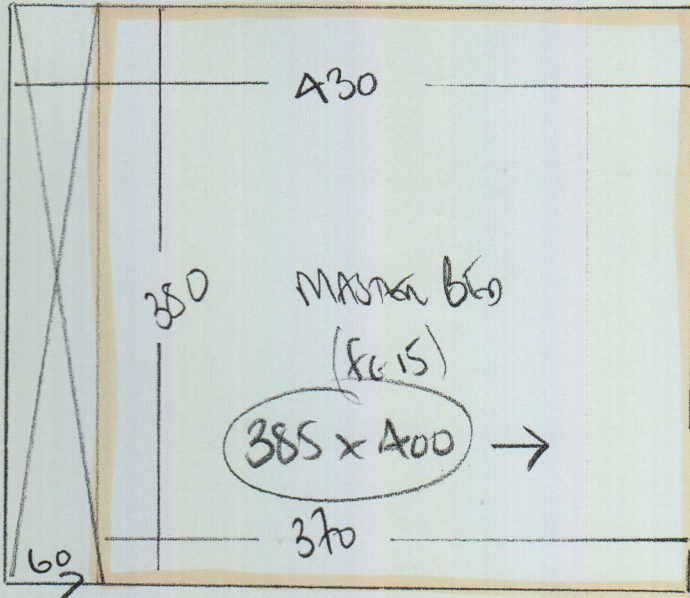

P 26994
 VUKOVITZ
 RAY 6 ST KENNEDY
 6365 PUNNETT
 SWISS BANK.

LOK 1

fit 9mm Shim
 + GULLER on top
 + BUT (ANDER TO WOOD) IN HALL

WARDROBES NOT IN YET AS
 EXISTING WARDROBES TO BE REMOVED

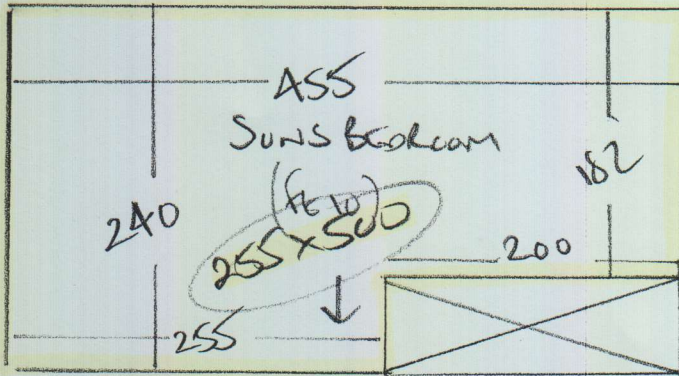

fit
 6mm Shim
 + BUT TO WOOD IN HALL

~~CUSTOMER WOULD LIKE
 RUB FOR HALLWAY
 800M x 1500M OR
 MADE UP TO 1000M x 1500M
 BUILD STRUCTURE~~

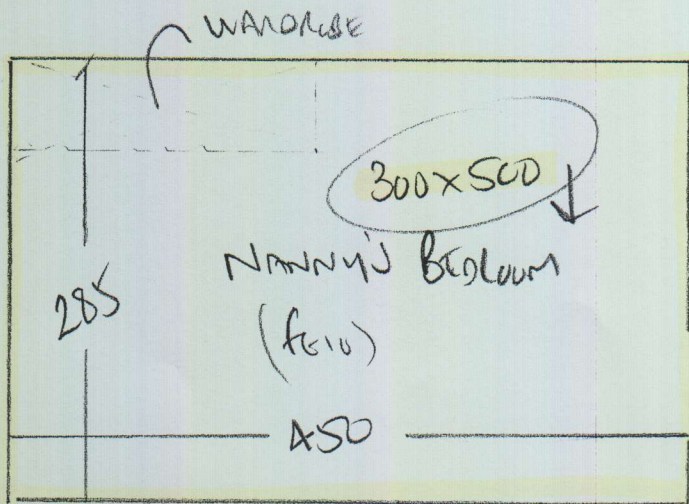

fit 6mm Shim
 + BUT TO WOOD IN HALL

WOOD FLOORS - QUADRANT BEADING AROUND MUST BE REMOVED.
 ADVISED CUSTOMER TO REMOVE BEADING BEFORE DECORATING.
 UNITS BY GULLER / DECORATIVE.