

P27078
WELL4EVER CLINIC

(LOF2)

HAWTHORN II

 - NIGHT SHADE

 390 x 400

(= 15.6m²)

2/6 - Billy

* CUT DOWN AT WAREHOUSE & *
 SEND FOR WHIPPING ASAP

(WAITING AREA RUG - 85 x 152
 TREATMENT ROOM RUG - 165 x 230)

Supply Whipped Rugs

Treatment Room Rug - 165 x 230 - Ex 1s Sisac + Narrow Binding

Waiting Area Rug - 85 x 152

PL7078 Well 4600 Coir

2 of 2

Riser = 18 x 76

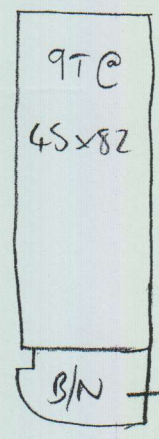
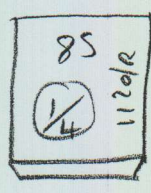
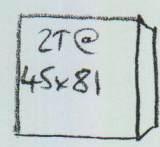

B/N 41 x 95 (WIRE AT ONE SIDE)

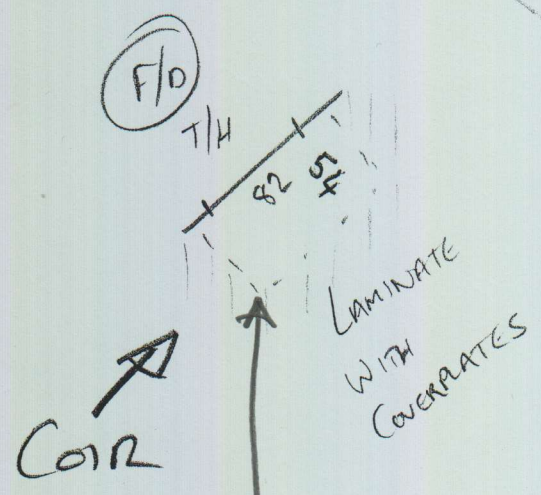

HAS CARPET IN @ PRESENT SUGGEST COIR?

Mitre New C/Plates around Coir Mat

2/6 - Billy
Cut Rugs to exact
Sizes shown below &
Send to BH ASAP.

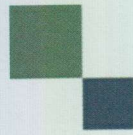

mrcarpet

DESIGNS FOR FLOORS

70 Lower Richmond Road

Putney

SW15 1LL

T 020-8789-3133

F 020-8780-2140

BH CARPETS - WHIPPING / BINDING FORM

Tel - 020-8665-9110

email: bhcarpets@gmail.com Fax 020-8665-6611

Customer Name:

Well4ever Clinic

Job No. :

P27078

Description of carpet :

Hawthorn II - Night Shade

Whipping / Blind Binding / Top Taping

All Round / Sides only (for Stair Runner)

Colour of Binding tape: _____

Size of Binding tape: _____

Amount showing on top: _____

Colour of Whipping: To Match

Number of pieces: 2

Ready to collect on: 3 / 6 / 16 Needed back by: 8 / 6 / 16

Sizes to be cut to: 85 x 1.52 & 165 x 2.30

Whipping: 12.65 metres @ £2.00 linear metre £ 25.30

Apply Tape: _____ metres @ £6.00 linear metre £ _____
(Supplied by MRC)

Blind Taping: _____ metres @ £7.00 linear metre £ _____
(including. Tape)

Trimming Charge (if applicable) £ _____

ANY QUERIES CALL:

Nigel Canice Jack

Total £ 25.30

Collect from:

Warehouse / Putney Shop

Deliver Back to:

Warehouse / Putney Shop

Mr Carpet Use. (Copy to be faxed to Shop & accounts Dept. when returned)

Date Collected: _____ Collected By: _____

Date Returned: _____ Returned By: _____

Invoice No: _____ Comments: _____