

Job No: P27230
 Name: K OSON
 Address:
 Tel: 1 of 3
 Sheet:

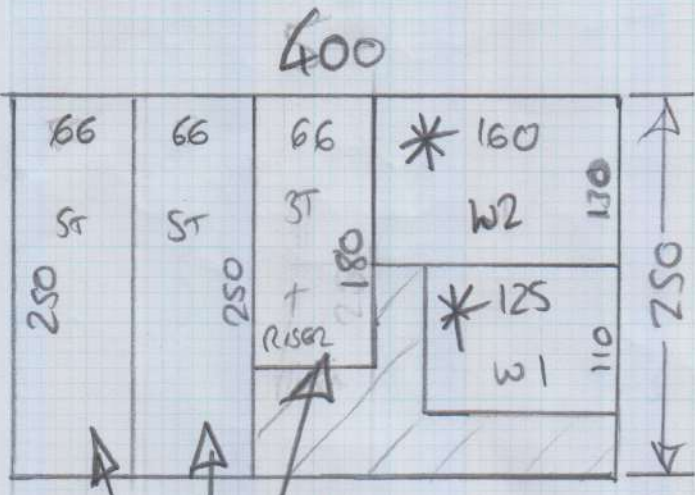

Mississippi stripe
NS/10 Black/Silver
 250 x 400

= 10m²

Cut to 66cm Matching stripes between all 3 Pieces. (TAKE to site when shaping winders)

* Shape these 2 steps on site
 Agree lay out with customer on site
 (See photo on page 3)

Job No: P27230

Name: WISSON

Address:

Tel:

Sheet:

2 of 3

Riser = 17 x 84

Finish under note

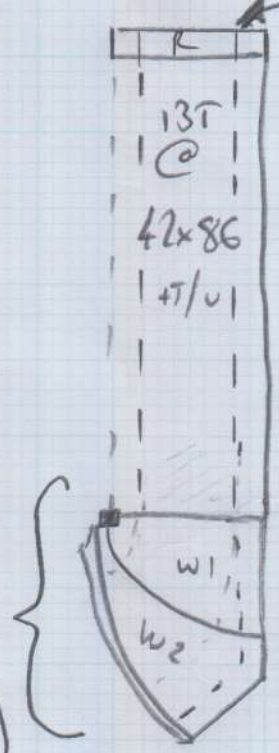

* Agree
Arrangement
with Cust.
before cutting

W1 = 87 x 105

(CAP = 72 x 105)
(BAND = 16 x 106)

W2 = 89 x 140 - TREAD ONLY

X (BAND = 18 x 143 - NOT RISER)

66cm Wide
RUNNER

P27230
Kidson

30/3

EQUAL
GAP.

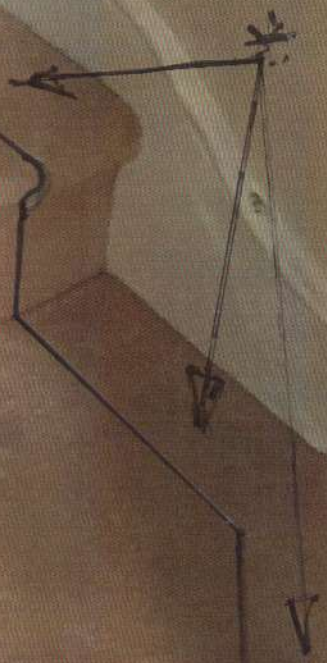

Proposed
Layout

↑
Finish under
Nose