

P28010
Dalrymple-Hamilton

1 of 3

Boston
Col. B02-022

- Lott bed 455 x 500
- Gym 385 x 500
- 1st flr Master 365 x 500
- Cut Plan 1015 x 500

$$2220 \times 500 = \underline{\underline{1110000}} \text{ M}^2$$

ordered 1 Roll
@ 2310 x 500m

* = Cut runners to 63cm @ WH
 ** = Shape these winders on site so they have an equal gap at sides
 (11.50cm gap on lower stairs / 9.50cm gap on upper stairs)

* Lowtog rubber to all the areas on this page

P28010
DALRYMPLE

2 of 3

Northern

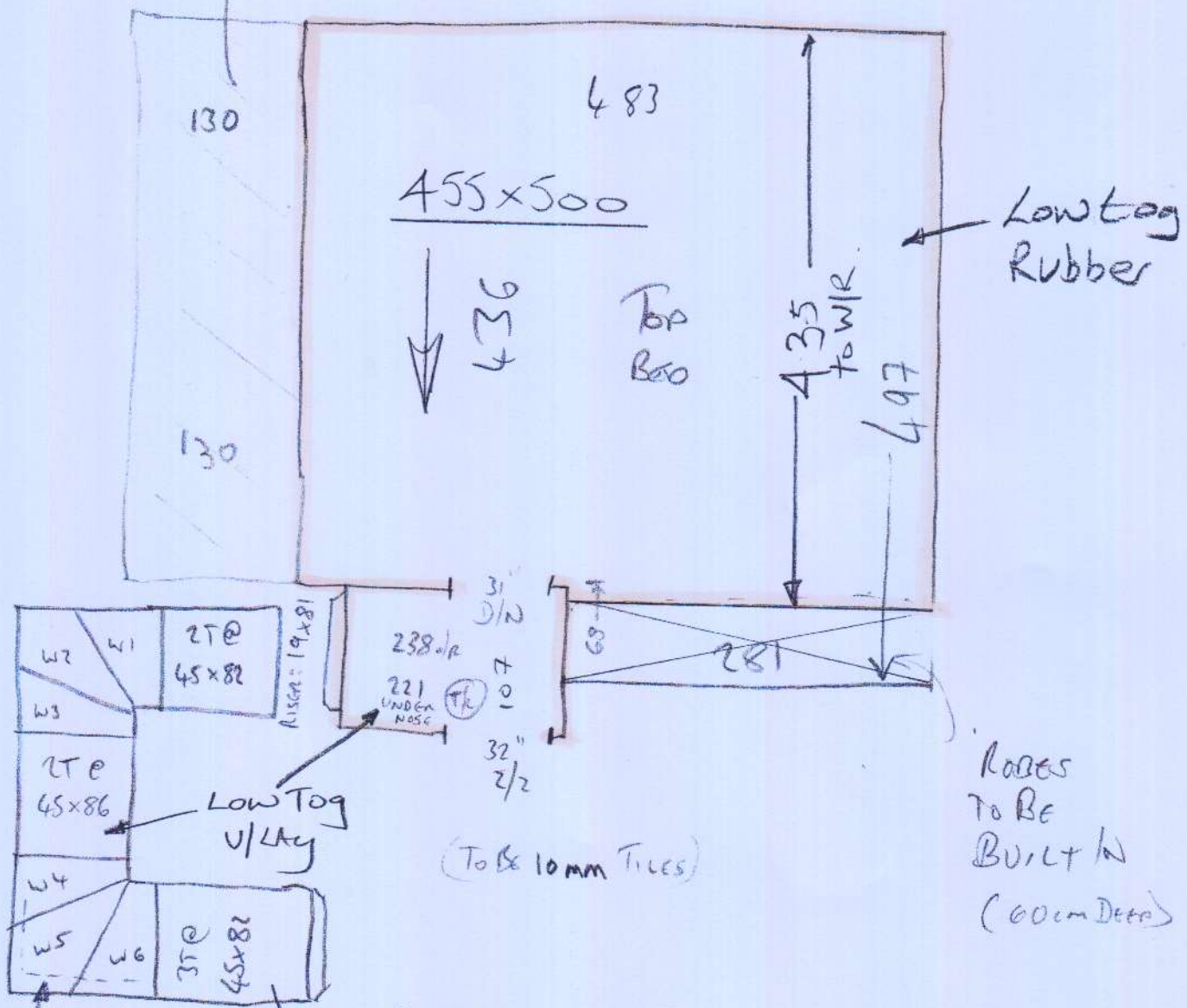

Rises To Be BUILT IN (60cm Deta)

- W1 = 68x94 ✓
- W2 = 77x115 ✓
- W3 = 77x82 ✓
- W4 = 68x96 ✓
- W5 = 78x116 ✓
- W6 = 75x78 ✓

Phase 2 - 14/12

P28010
DALLYMPLE

3 of 3

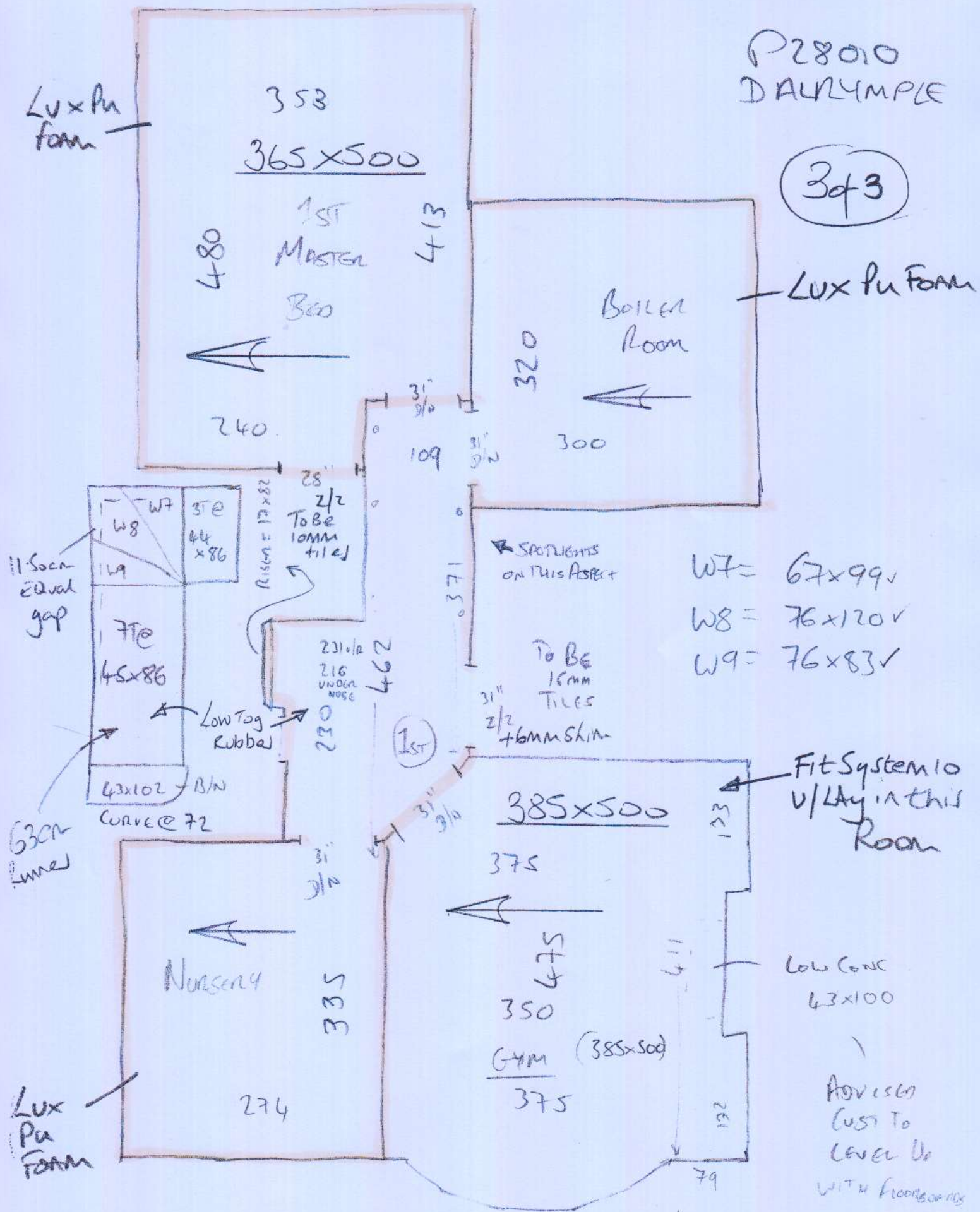

- WF = 67x99v
- W8 = 76x120v
- W9 = 76x83v

Fit System 10 v/Lay in this Room

Low CONC
43x100

ADVISED CUST TO LEVEL UP WITH FLOOR OF 105

(Approx 20mm)