



P28286
Jastrzebska

1 of 2

Soft Velvet

Col. SV-670

Cut Plan 425×500
 $= \underline{\underline{21.25m^2}}$

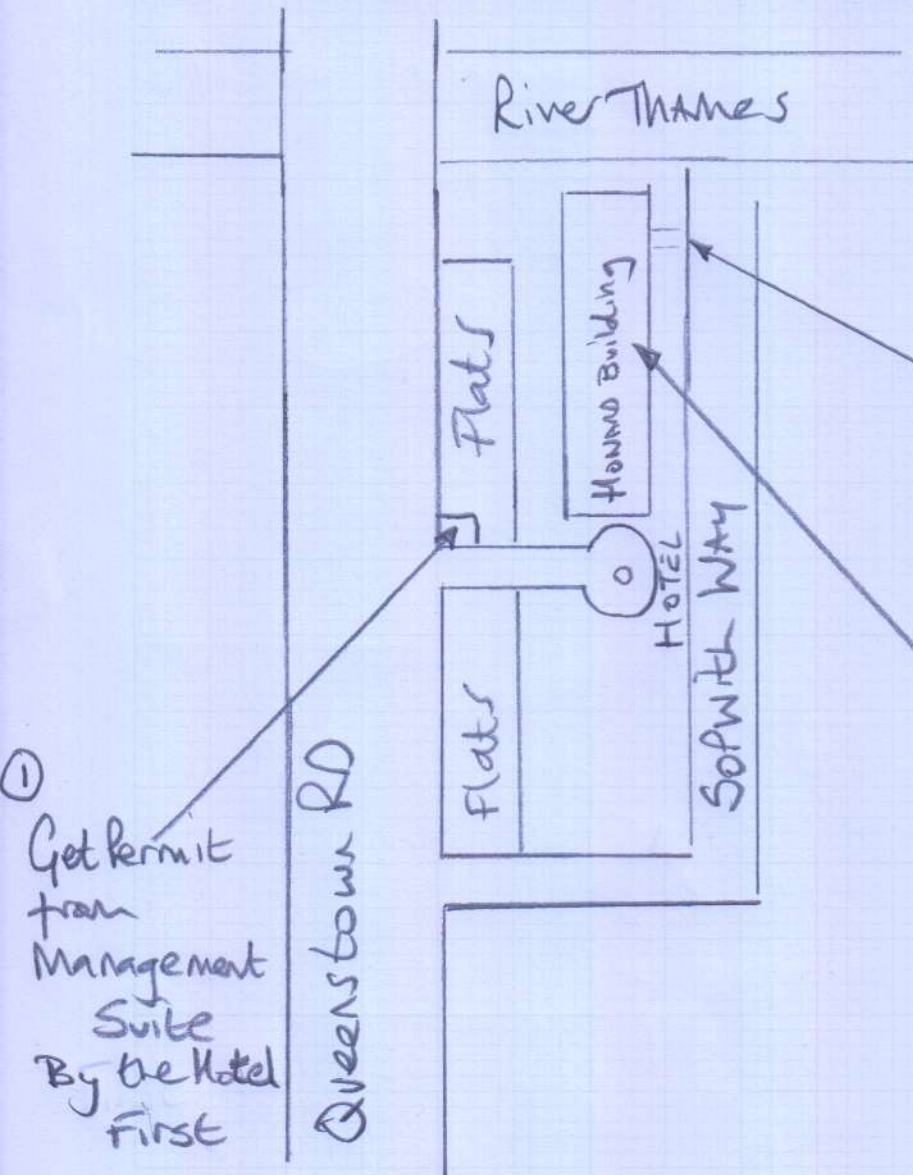

② PARK in Loading Bays
IN SERVICE ROAD
Behind Hawmo &
BUZZ Intercom on
on Metal Gate

③ UNLOAD CARPET
through Car Park
P1 & through
door to Hawmo 3
(Red Colour)

Flat is on 7th Floor

* Ring When on way to advise ETA.

Job No: P28286

Name: Jastrzebska

Address:

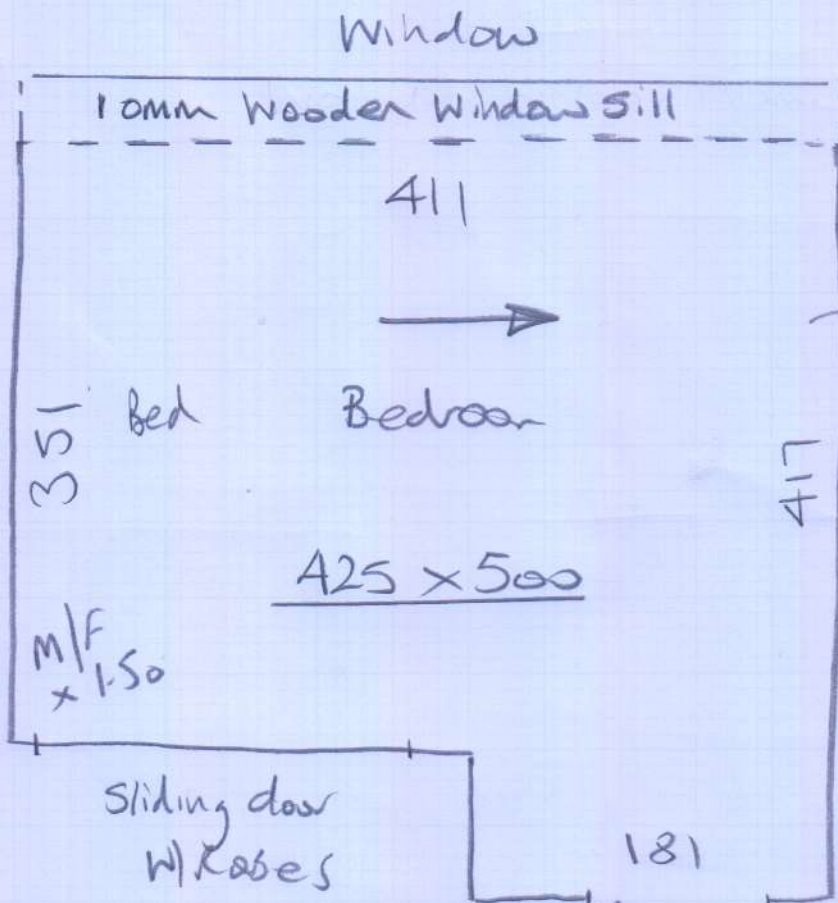

2 of 2

Boxes etc
Customer to clear

All 2/2
would be
Better

EX 33" Re-stick if nec.
Laminate T/H

10mm laminate
IN Hall

Door a bit low (Advise on Quote)

Re-use ex spe (Nailed to Concrete floor)
allow to re-stick where loose