

Job No: P28549

Name: BENCE

Address:

Tel: (0)2

Sheet:

Soft Velvet

-SV-670

305 x 400

= 12.2m<sup>2</sup>

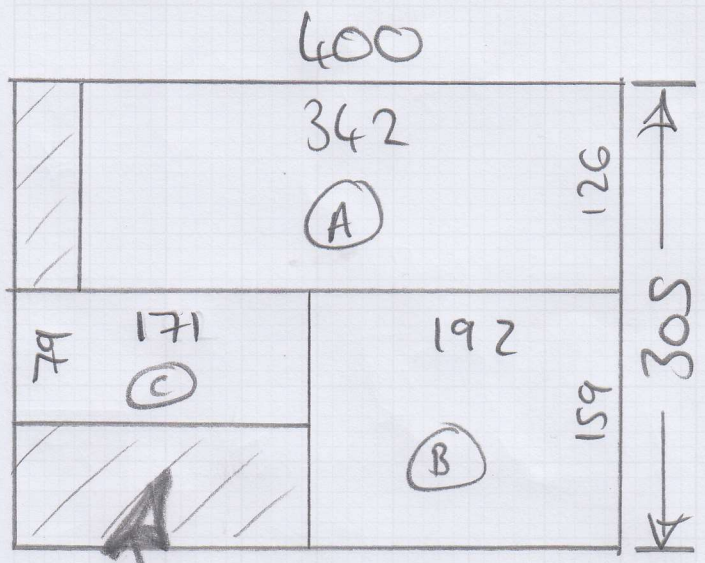

RETURN WASTE

29/8 KASIAS TO COLLECT,  
CUT DOWN & WHIP AROUND.

31/8 LAY OUT AT PROPERTY  
& GLUE UNDERLAY BENEATH  
(DO NOT STICK TO FLOOR!)

Job No: P28549

Name: BENICE

Address: 2062

Tel:

Sheet:

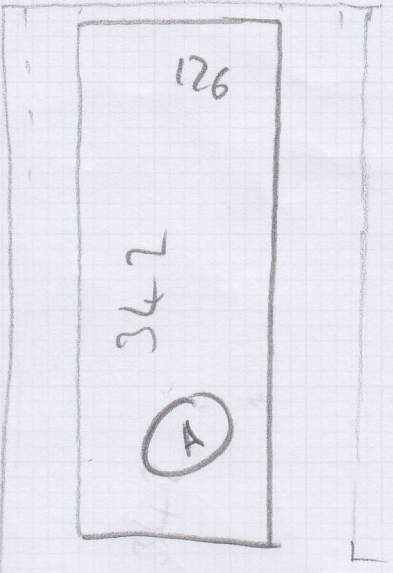

STUDY AREA

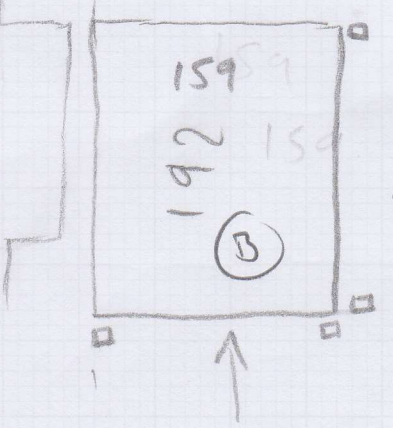

FRONT TV AREA

To FRONT OF SOFALOGS

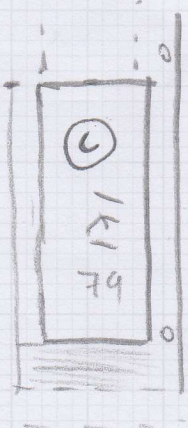

HALLWAY

to line possible  
with direction

# Whipping & Binding Workshop Instructions



**To:** Kasias Karpets Ltd **07825 156676**  
**Branch:** Putney - Tel: 020 8789 3133 E:putneybranch@mr-carpet.co.uk  
**Branch Contact:** Jack

**Customer Name:** Bence **Please quote on invoice**

**Job No:** P28549 **Please quote on invoice**

**Description of Carpet:** Soft Velvet - SV-670

**Carpet Finish:** Whipping all round

**Number of Pieces:** 3

**Sizes to be cut to:** (If applicable) A= 1.26 x 3.42m B= 1.59 x 1.92m C= 0.79 x 1.71m

**Runner Lengths for Taping:** Please check before sewing N/A

**Date for collection:** 29 August 2018 **Required back by:** 30 August 2018

**Collection From:** Warehouse **Return To:** Warehouse

<b>If Tape Selected</b>	<b>Supplied By</b>	Select Supplier (if Appli
<b>Colour of tape:</b>	<b>Size of Tape:</b>	<b>Amount Visible on Top:</b>
<b>If Whipping:</b>		
<b>Colour of Whipping:</b> To Match Carpet		

**Special Instructions - PLEASE CUT TO SIZES SHOWN ABOVE (£10 Cutting Charge added to order) + PLEASE RETURN WASTE**

**Sewing charges authorised - Please note only charges authorised in writing will be paid on invoice**

Materials	Description	Quantity	Unit Cost	Total
Whipping	Under 3m x 3m	21.40	£2.30	£49.22
	Over 3m x 3m		£2.50	
Standard Taping	Labour Only Under 3m x 3m		£6.00	
Double Taping	Labour Only Under 3m x 3m		£8.50	
Faux Suede & Leather	Labour Only Under 3m x 3m		£7.00	
Mitres Cotton	Per Corner		NOT APPLICABLE	
Mitres Leather	Per Corner		NOT APPLICABLE	
Blind Stitching MACHINE	38mm Tape Labour & Tape		£8.00	
Blind Stitching HAND SEWN	38mm Tape Labour & Tape		£10.50	
Hidden Stitching	<b>Additional cost per lin M to above prices</b>		NOT APPLICABLE	
	<b>(Enter the same quantity as tape quantity)</b>			

Materials & other charges	Description	Quantity	Unit Cost	Total
<b>Quantity</b>				
Padding	Per Lin M		£1.00	
Chenille Tape 120mm	Per Lin M		£4.00	
Chrome Tape 120mm	Per Lin M		£3.50	
Cotton Tape 70mm	Per Lin M		£3.00	
Cotton Tape CK 120mm	Per Lin M		£3.50	
Cotton Herringbone HB 120mm	Per Lin M		£4.00	
Linen Twill Tape	Per Lin M		£5.50	
Faux Leather 120mm	Per Lin M		£5.50	
Faux Suede 120mm	Per Lin M		£5.50	
Goblin GLV 120mm	Per Lin M		£4.00	
Jute 120mm	Per Lin M		£3.00	
Leather 120mm	Per Lin M		£12.50	
Pipeline	Per Lin M		£3.00	
Starline (Linen) LS 120mm	Per Lin M		£5.50	
Superstrong 120mm	Per Lin M		£5.50	
Slim 120mm	Per Lin M		£3.00	
Teakline 120mm	Per Lin M		£5.50	
			<b>Sub Total</b>	£49.22
			<b>VAT @ 20%</b>	£9.84
			<b>Total</b>	£59.06