

mrcarpet

DESIGNERS FOR EXPORT

Job No: P28722

Name: Hdwe

Address:

Tel:

Sheet:

1 of 3

Sudbury Twist  
Col. 633/48

Cut Plan ①  $610 \times 500$   
 $= \underline{30.50m^2}$

\* Keys from: - Howard de Walden  
23 Queen Anne St  
W1G 9DL

Study  $215 \times 400$   
 $= \underline{8.60m^2}$

Total = 39.10m<sup>2</sup>

\* Must Hoover flat &  
Communal areas on  
Completion.

Secura 2164  
Col. Powdered Concrete

\* Please protect the New  
Wood flooring in the  
Hall with Raofelt whilst  
Working in the flat.

Bathroom  $180 \times 300$   
 $= \underline{5.40m^2}$

Job No P28722

Name: Hdwe

Address:

Tel:

Sheet:

2 of 3

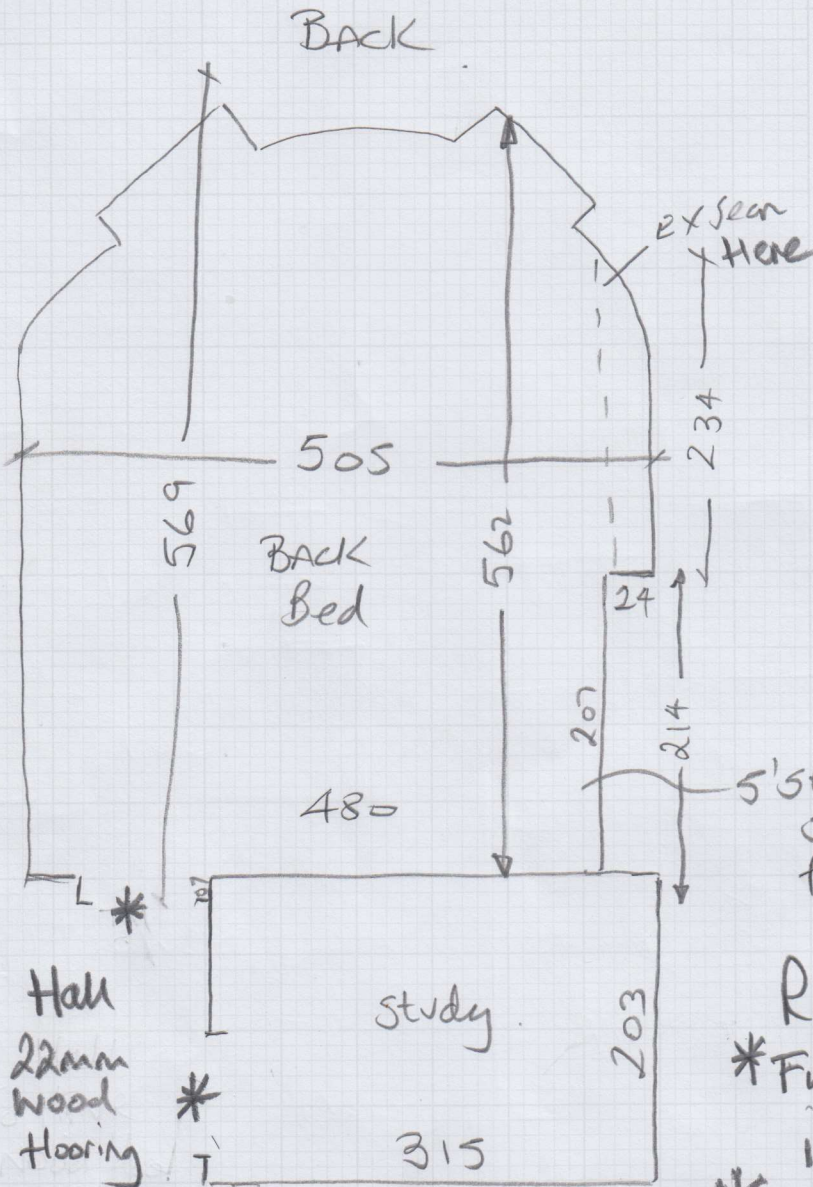

Hall  
22mm  
Wood  
Flooring

- Re-use mostly ex/sle
- \* Fit up to 22mm wood in Hall.
- \* Fit new u/Lay T/OT.

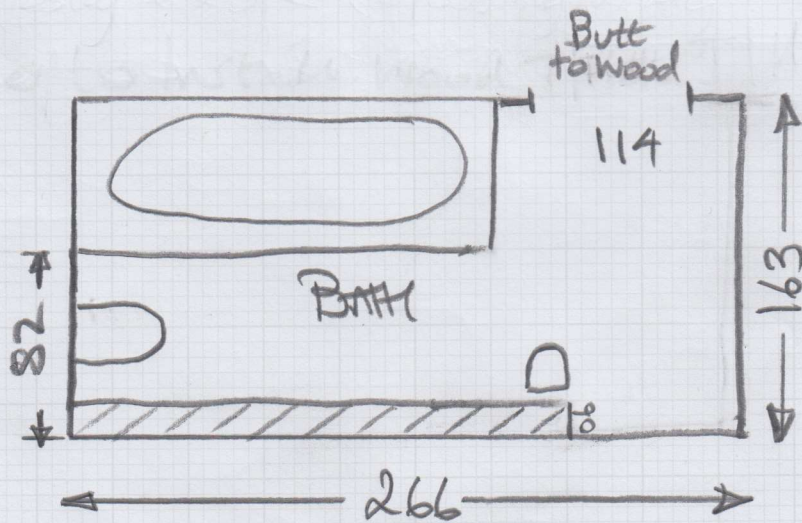

- UPHUT ex cl/fo
- 2 Layers
- Lay 6mm ply
- \* Apply White mastic around the edges & around Sanitaryware.

P28722  
Hdwe

# Devonshire Place

Approximate Gross Internal Area = 842 sq ft / 78.2 sq m



3 of 3



\* Must leave flat & common parts clean & tidy on completion

## Second Floor

Not to scale, for guidance only and must not be relied upon as a statement of fact. All measurements and areas are approximate only and have been prepared in accordance with the current edition of the RICS Code of Measuring Practice.