

- Room Has Conc. Sub-floor, Approx 20mm From Wooden Threshold The Conc/Screed Runs Over The Start Of The Floorboards & Is Now Crumbling On The Left Hand Side.
- Cust To U/LIFT CARPET ONLY.
- RE-USE EX U/LAY AS IT IS STUCK TO THE CRUMBLING CONC/SCREED.
- CONC/SCREED IS HIGHER ON RIGHT HAND SIDE THAN THE LEFT.

Job No: P28881  
 Name: EKO  
 Address: (10F1)  
 Tel:  
 Sheet: of:

SUPER STAIN FREE TWIST

- FOG

225 x 400

(= 9m<sup>2</sup>)

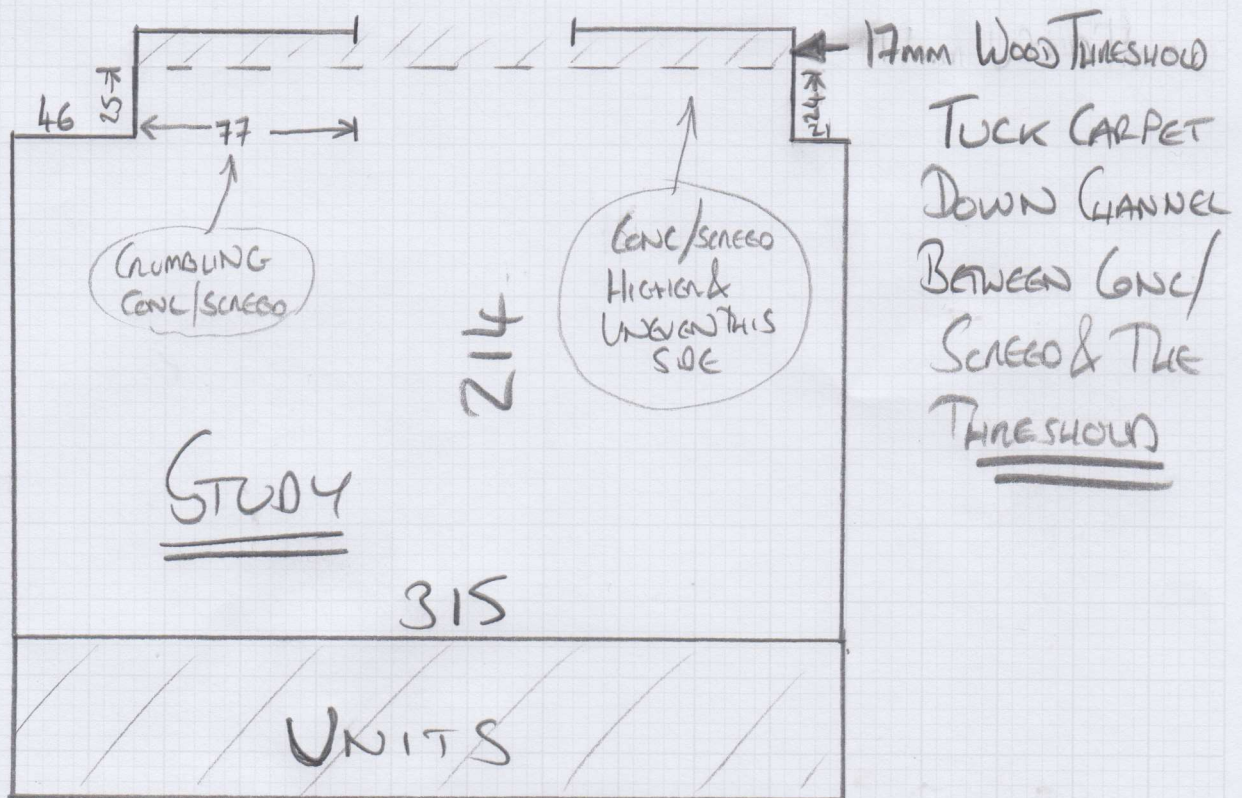

\* FIT AS BEST POSSIBLE - CUSTOMER ADVISED IT WILL NOT BE PERFECT.

+ ASK CUST IF HE WANTS THE WASTE PIECE?!