

Phase 1 - 14/8 = Cut Runner/shape B/N's P28936

Phase 2 - 22/8 = Fit ALL S/L except Runner 19 Rocks lane LTD

Phase 3 - ~~21/8~~ = Fit Runner + PLAYROOM  
2/9 + EXTRA

1 of 3

Cotswold Rib

Col Shipton

Cut Plan ④ 800x400  
= 32m<sup>2</sup>

4T + Riser From Hall To Kitchen  
IF YOU HAVE ENOUGH SPARE TO DO THEM,  
PLEASE ADVISE SHOP + CUSTOMER - EITHER FIT  
FULL WIDTH & MUST PAY CASH DIRECT ON CUT TO  
400 RUNNERS THROUGH SHOP.

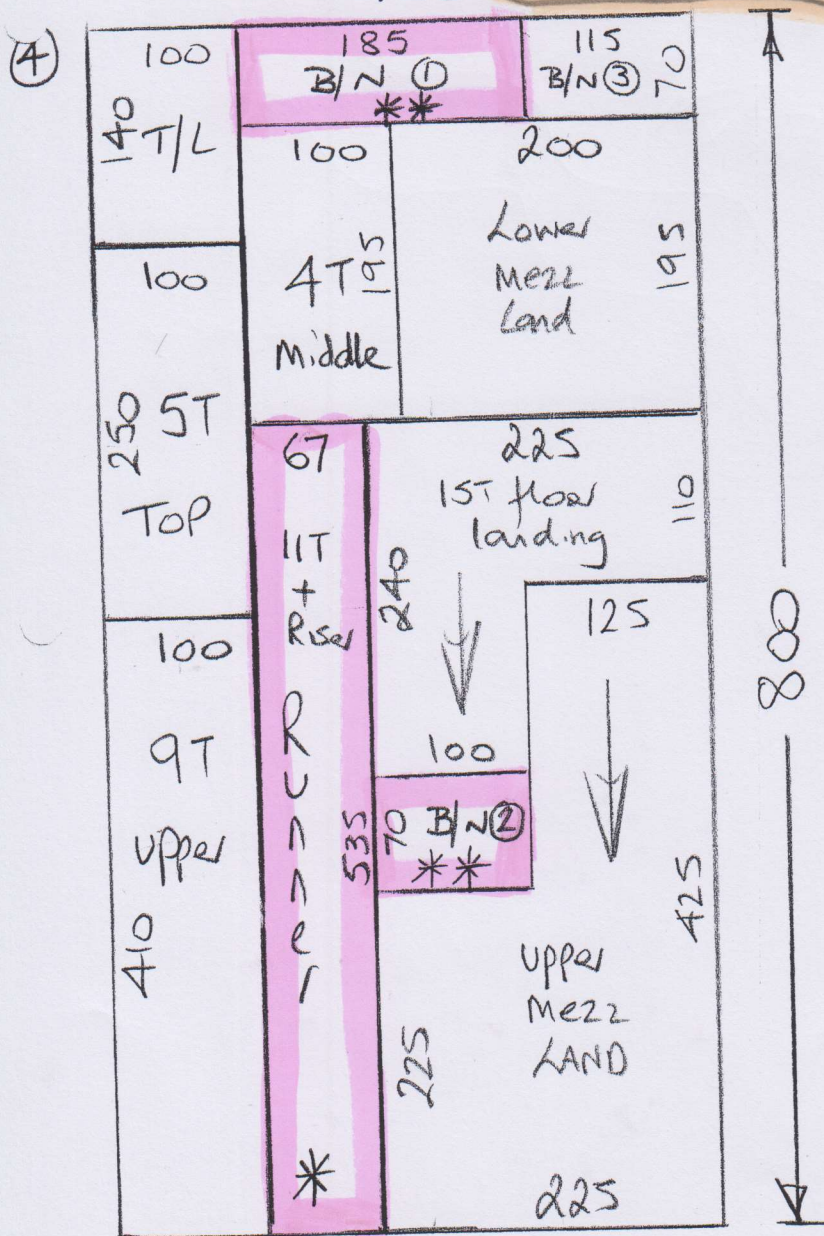

Binding tape = 13.5ohm  
(Acmtape showing outer)

\* Cut Runner 2 WITH  
to exactly 67cm

\*\* Shape 2 Bottom  
B/Nose's on site

\*\* Fit Treads & Risers  
Separately & finish  
under nose of Bottom  
Bullnose

(Bottom Riser to be  
painted)



Lower Ground floor

P29186  
19 Rows LANE 600  
19 Rows LANE  
SWIBOODS

3 of 3

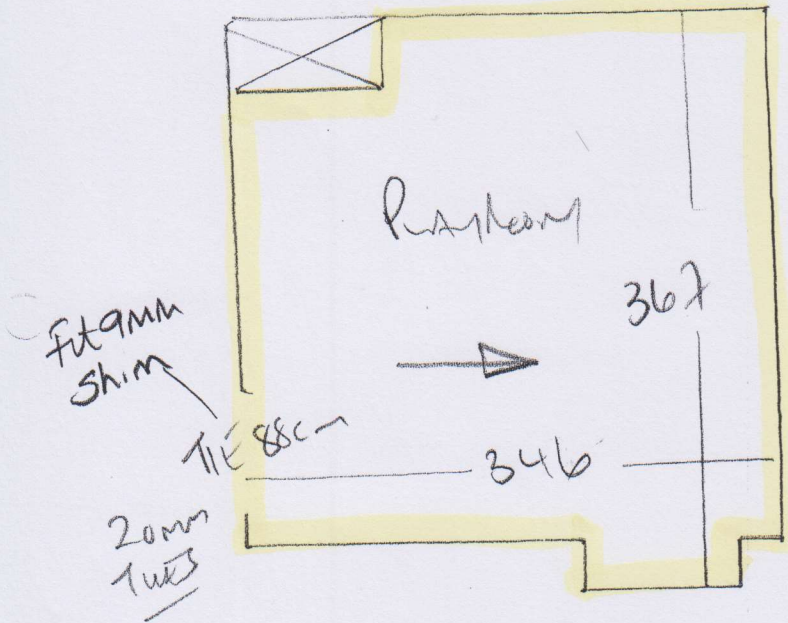

Duct, Col. Duct-19  
Playroom 370 x 400  
= 14.80M<sup>2</sup>

Concrete frame  
Ultra Hane  
Spice Stack + Low 10G vlay