

mrcarpet
 Job No: P28961
 Name: MCGANN
 Address:
 Tel: (10P2)
 Sheet: of

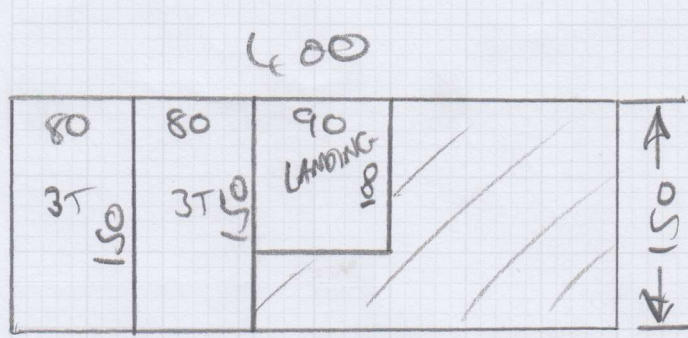

MALABAR (ALBONAN)
-Buckwheat (ALB-025)

150 x 400

(-6m²)

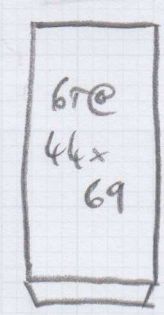
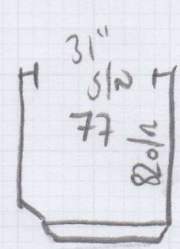

- Cust To UPLIFT & DISPOSE OF EX. CARPET + U/LAY (MORIS)
- RE-USE EX. S/E
- ALL NOSES CURRENTLY HAVE NOSINGS FITTED BENEATH CARPET & U/LAY.
- Cust TO PATCH IN HANDBOARD TO THROAT (S) TO REMOVE RIDGE!

(+Remedial Work — See PAGE 2 of 2)

1st floor

- RE-SMETCH 1st floor LANDING CARPET TO FIT AS BEST POSSIBLE. (STARTING TO DELAMINATE IN MIDDLE!)
- FIT EASYSKIM AT 1st floor Bathroom Doorway AS BEST POSSIBLE (USE EX. BAR)

mrcarpet
Job No: P28961
Name: McCANN
Address:
Sheet: of:

2 of 2

BASMENT

- PATCH IN CUSTOMER'S OWN SPARE CARPET TO WHERE BOILER HAS BEEN REMOVED
- THIS WALL & SKIRTING HAS BEEN FITTED ON TOP OF EX. CARPET.
- CUT THRU CARPET & U/LAY AT SKIRTING TO PULL BACK CARPET & SEAM IN BOILER PATCH, THEN FIT NO PIN S/E & RE-FIT CARPET.

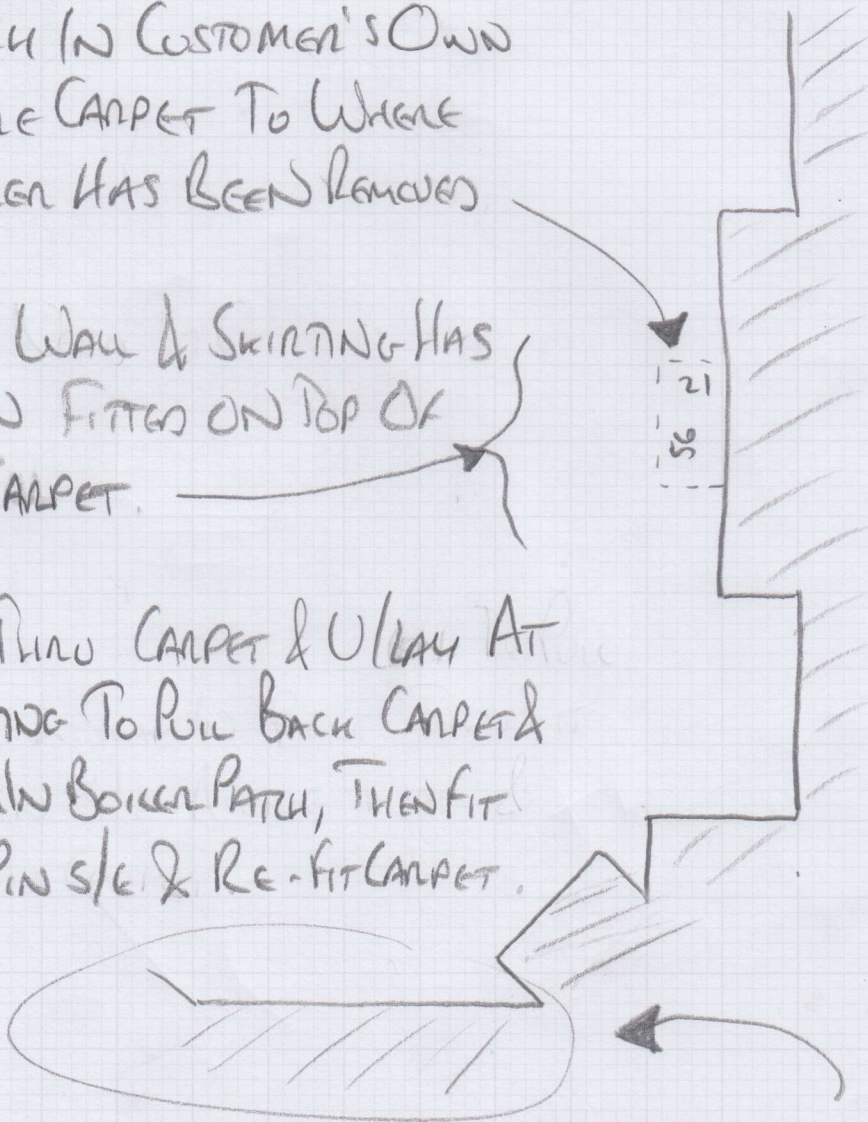

- CUST MAN ASK FOR YOU TO RE-SMETCH THIS AREA BUT CARPET IS DE-LAMINATED