

# Phase 1 - 13/8 (2nd Call)

~~THEO'S Bedroom \* Ring on way~~

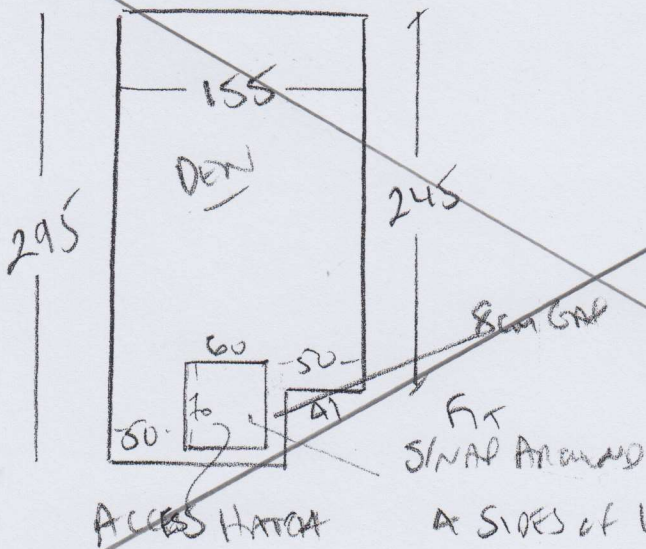

P 29166  
DAVIES  
18 CHURCH ROAD  
SW13 9TH

10/1

Obsession  
Col. 734 Ashes

165 x 400 = 6.60m<sup>2</sup>

1 x 900mm + 1 x 2.71m (Allows for MITRES)

## Phase 2 - Cut CARPET on 14/8

Fit 2 steps + 2 B/NOSES (TBC)

1st Run of STAIRS

Bottom 4 STEPS =  $\frac{\text{Sisal ORIGINAL} - \text{Platinum E108}}{2} = 150 \times 400 = 6\text{m}^2$

2T

45 x 100 WHITTEN EDGE ON RIGHT HAND SIDE

Bn 2

TO MATCH BAUSTRIDE

48 x 110

Bn 1

70 x 135

CARP BAND  
NO WHITTEN

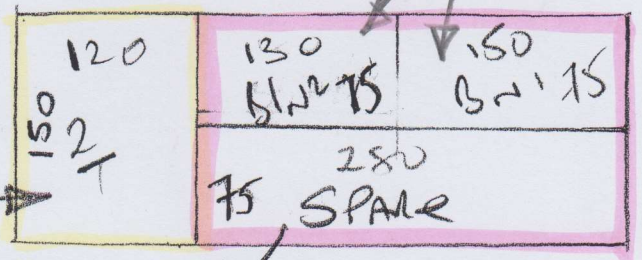

MARK UP  
# STAIR  
DWH

\* Cut 2 DWH & send to KK  
to HAVE WHIPPING Applied to R/H side only

Leave with Customer