

P29169
Hacker
45 Bloomwood
Swilbhu

1 of 1

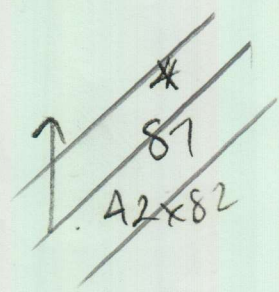

Bella Donna
Col. VMK. 880 Pearl
= 320 x 500

- w1 65 x 92
- w2 75 x 105
- w3 60 x 67

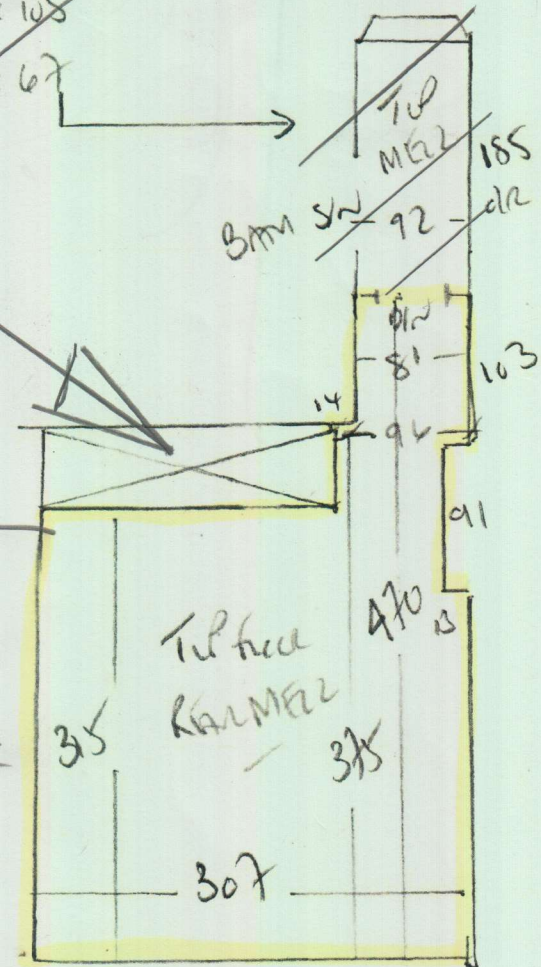

* Allow new spe as Customer
May remove ex spe to
Mastic Gap under skirtings
Quote 8mm per foam.
+ option for 10mm foam
Customer May do up lift/dispac
So quote self
Floor is H/Boarded already