

Seaming Plan

P29669
Dunleavy

(1 of 2)

Wool Berber

Col. TAWNY

Hall Section (A) 105 x 400

" " (B) 190 x 400

" " (C) 160 x 400

455 x 400

= 18.20m²

u/kay = 15m²

Coir Matting - Natural

Front Door = 90 x 100

Premier Trims - SATIN NICKEL

Double ZTM 9 - 2 @ 90cm

Single 9 - 3 @ 90cm

Square - 1 @ 90cm

+ Standard Ali S/N for Cupd

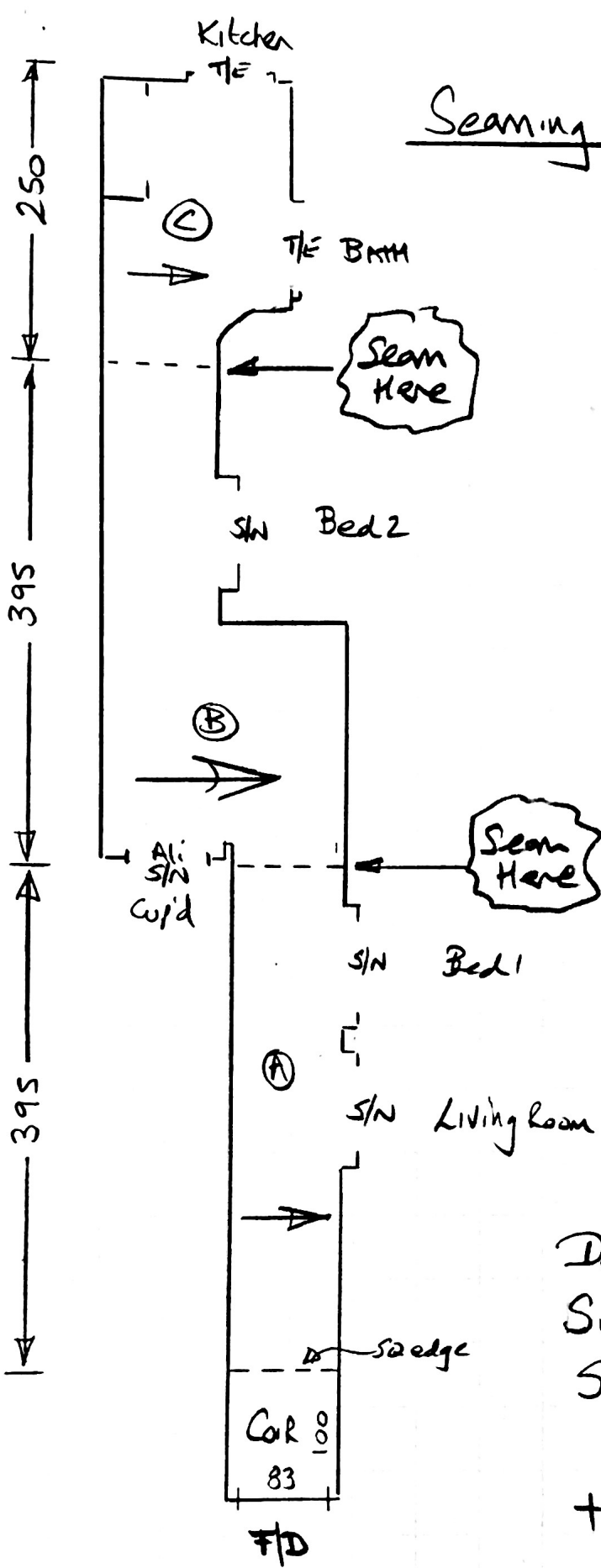

P29669
Dunleavy

2 of 2

ALTERNATIVE FLOORING

WOOD BELLETT

TANNING

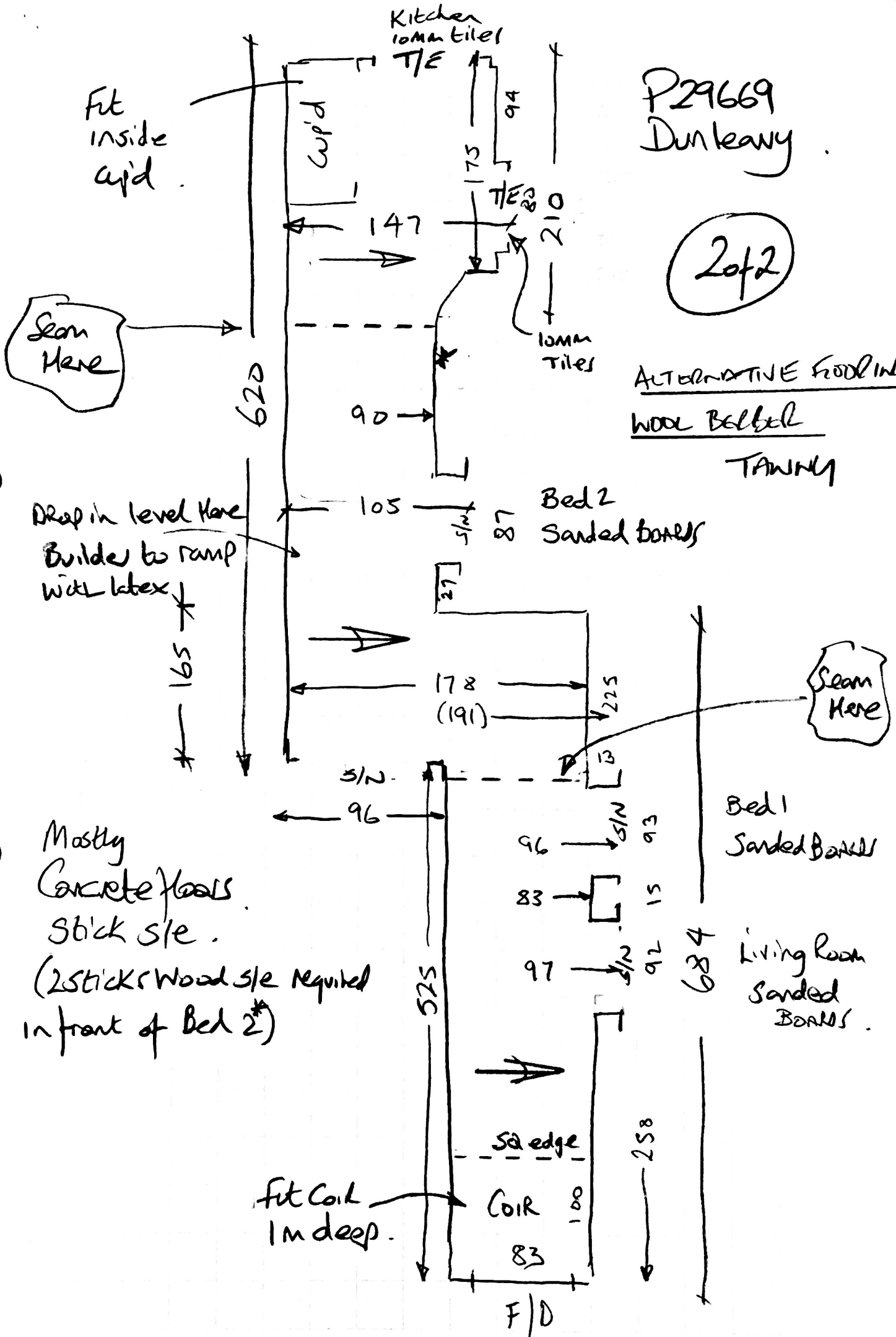

Mostly
Concrete floors.
Stick s/e.
(2 sticks wood s/e required
in front of Bed 2*)