

Communal Hall + Lobby to upper flat

P29916
MTN Property

10f1

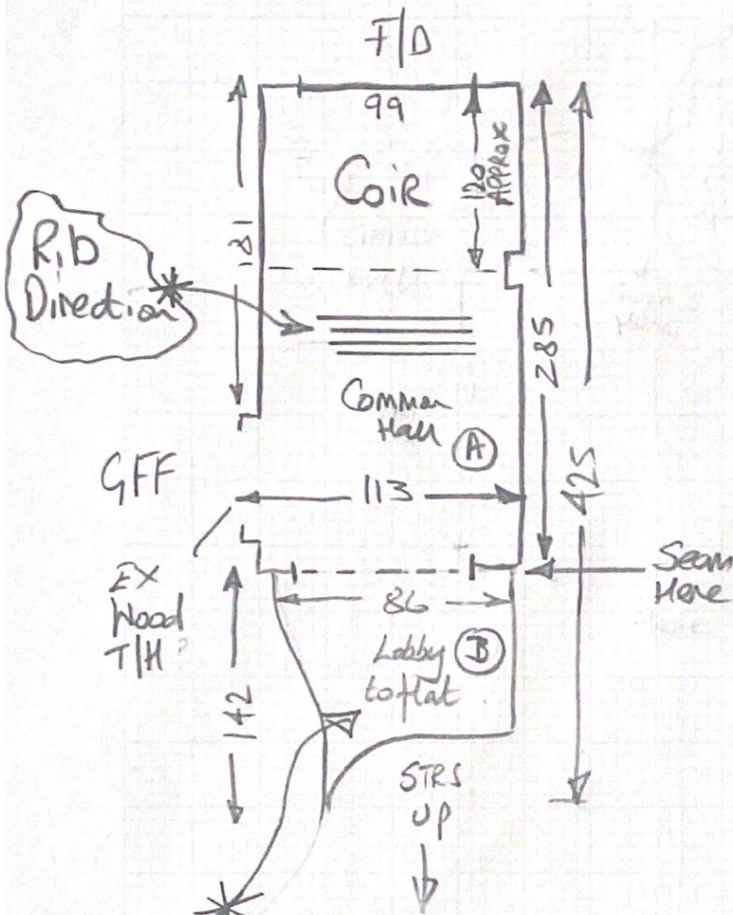

Hippo Ribbed Matting
Col. PEBBLE

Comm Hall (A) 120×200
Lobby to flat (B) 95×200
 215×200
 $= 4.30m^2$

6mm ply = 55 sheets

Any Hippo Ribbed over
6mm ply so total height
is 18mm to match up
with 17mm Coir at entrance.

Coir Matting
Col. NATURAL
 $= 1.30 \times 100$
 $= 1.30m^2$

* Agree exact depth of
mat with customer
before fitting.