

SB QUOTE

Top Floor

P25686
Kat Project

4 of 7

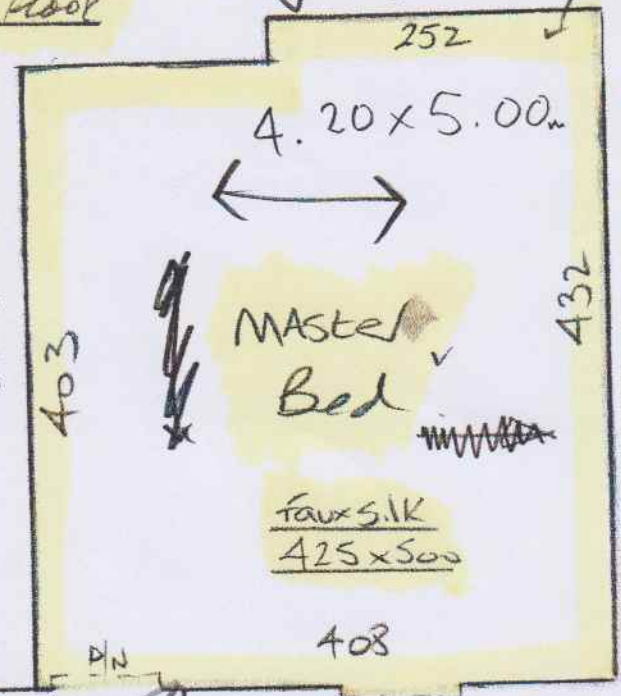

~~Put some foam
on stairs only
low tog up to
all other areas~~



18mm TILE
6mm Shim
+2/2
EN-5076

5 @ 46 x 79
9 @ 47 x 79

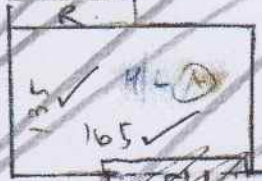

Blind to
be painted

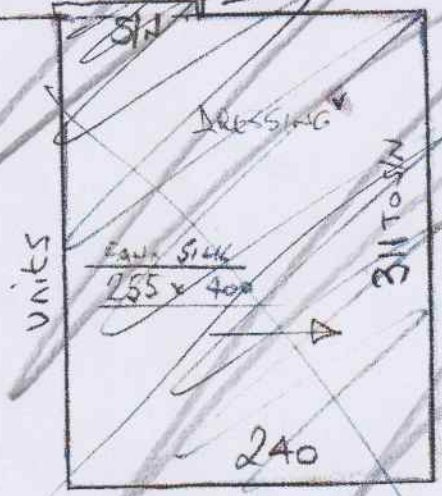
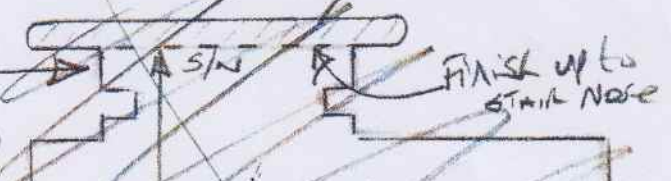

* CARPET to run
up to here

* Stick Sledge to all chipboard floors
where pipes are marked on floors.