

ALAN 22nd July 15.

**Fitting Instructions - R16834 – PLEASE READ – RING DG BEFORE GOING TO SITE**

Sheridan Construction – 19 Grays Lane, Ashted, Surrey

1 of 3

Ring Siobhan when leaving previous job for access – Number on Worksheet

**Alan**

(The labour for fitting the top landing is not on this worksheet as it has been held for payment from Mike Cole's last visit but will be added and paid to you).

**Carpets to take**

8.40m x 5m – WASTE TO STAIRS

Part 6.50m x 5m (Filler and stairs see plan)

Part 8.60m x 5m (Waste cut from centre of first floor landing USE FIRST for stairs)

**2.45m x 5m ONLY USE FOR STAIRS IF INSUFICIENT WASTE FROM LAND & 6.50m piece  
If not used return to warehouse please**

**This job has the following items to be completed.**

1. Top floor Landing fit on existing prepared areas (waste to stairs)
2. Master bedroom – fit 6mm ramps at bathroom tiles and finish carpets at tiles
3. Garage annex – Fit double nap at junction between bedroom & landing carpet and tile edge at gym door.
4. Template stair runners from ground to top floor. See notes below

**Stair Runner instructions**

**Cut stair runner 900mm wide** ready to whip both edges. Fit under nosing on bottom steps and leave riser exposed.

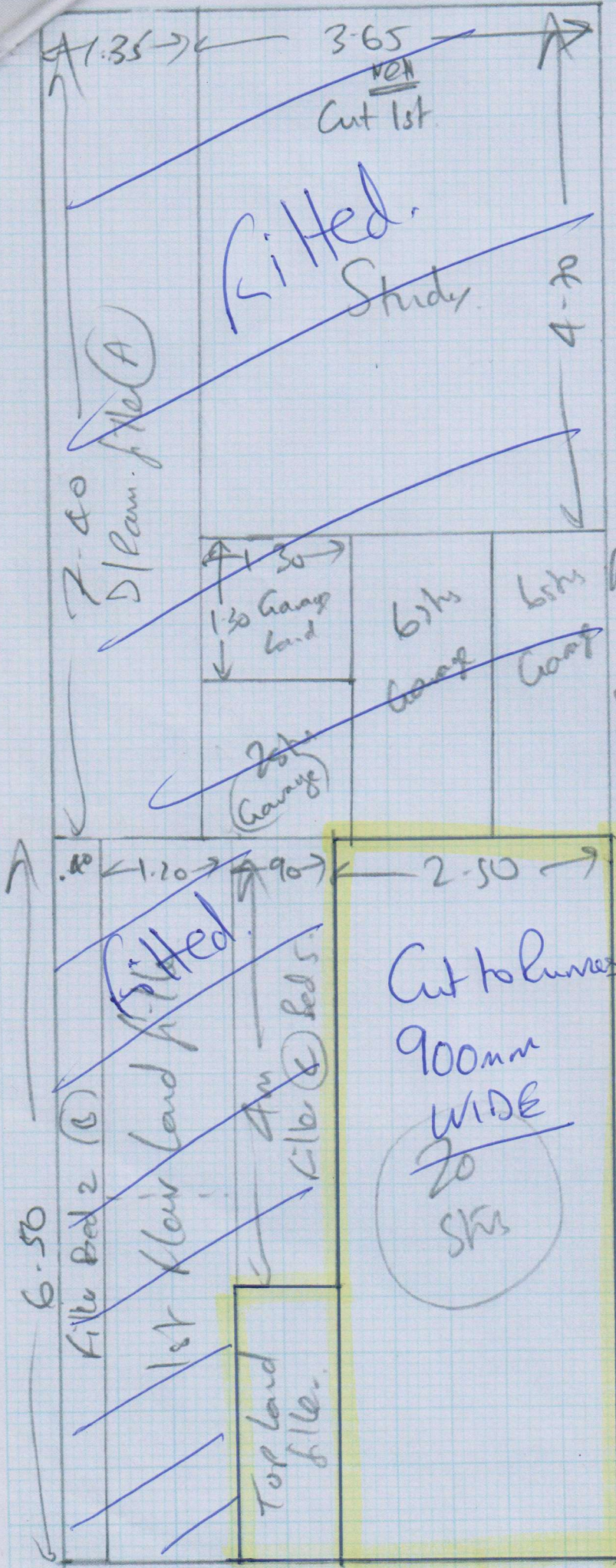

mrcarpet  
 Job No: R16834  
 Name: Sherida Carchucka  
 Address: 19 Crayslane Ashlead  
 Tel:   
 Fax:   
 Email:   
 2 3

- LULWORTH LW/27 POLAR WHITE
- ~~Cinema 5.55 x 5m~~
  - ~~Dining Room 7.40 x 5m + CIB~~
  - ~~Bed 2 6.40 x 5m + CIB~~
  - ~~Bed 3 4.80 x 5m~~
  - ~~Bed 4 4.80 x 5m~~
  - ~~1st floor land 8.60 x 5m + CIB~~
  - ~~Bed 5 7.90 x 5m~~
  - ~~Stn x 20 2.40 x 5m~~
  - ~~Bed 6 5.80 x 5m~~
  - ~~Kids Room 7.40 x 5m + CIB~~
  - ~~Shower fill 6.40 x 5m~~
  - ~~Top Land 8.40 x 5m~~
  - ~~1st floor land 3.20 x 5m~~
  - ~~Plan 7.40 x 5m~~
  - ~~Part PLAN 6.50 x 5m~~
  - ~~Entrance 2.95 x 5m~~

96.10  
 480.50m<sup>2</sup>

Car 1.10 x 2m rear door

