

R17537  
FRASER  
AN INDEPENDENT  
SW20 810

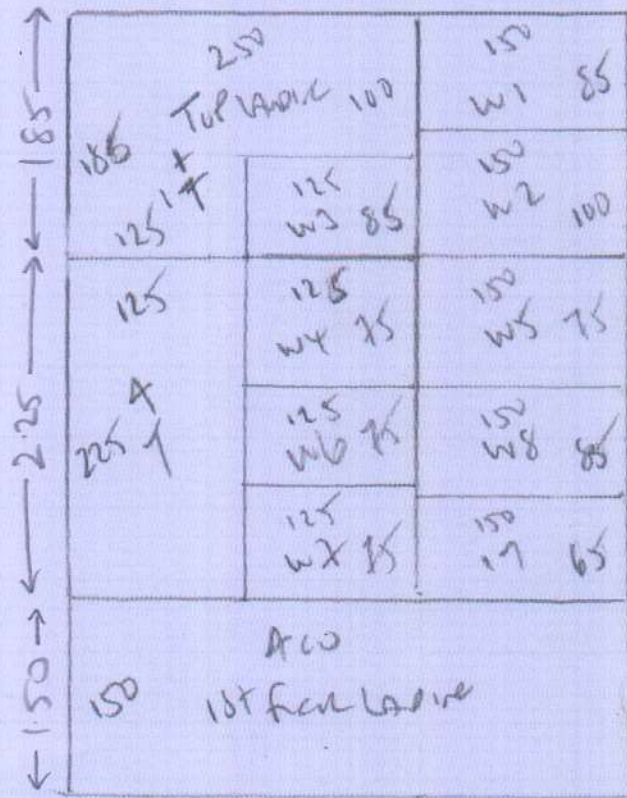

Abbey Green  
FERRIS ROAD  
9/38258

500

500 x 400

2240m<sup>2</sup>

$$\begin{array}{r} 1.85 \\ 2.25 \\ 1.50 \\ \hline 5.60m \end{array}$$

Then -  
GROUND FLOOR TO HT FLOOR  
SHALL REMAIN AS EXIST  
AS SAME LANDS - FIXED  
BY MRC R16219 (2012)

10F2

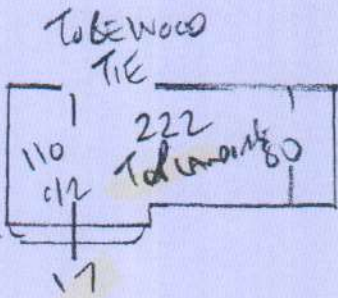

46 x 86

w1 70 x 98

w2 85 x 108

w3 70 x 67

A1

46 x 68

w4 62 x 80

w5 68 x 96

w6 66 x 67

17

46 x 68

w7 64 x 80

w8 71 x 106

\*

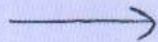

Landings and top stairs  
only

R17539  
FRASER  
AQ TREMUR LAD  
SW20 810

IF  
HAWANA 'CLEARANCE'  
LOCAL HAWAIA

~~To Have~~

~~B12 42 x 85~~

~~107~~

~~42 x 74~~

~~w11 65 x 72~~

~~w10 87 x 120~~

~~w9 70 x 107~~

~~17~~

~~45 x 93~~

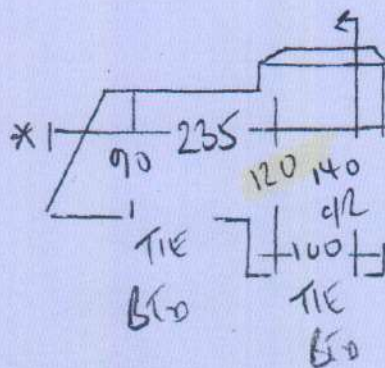

2022