

R17668
 MRS F. CAREY
 15 DUNMORE ROAD
 RAYNES PARK
 SW20 8TN

Havewood NTHAR-04

5.35 x 4m
 3.00 x 4m

Bottom stairs:
 Cut off runners +
 send for taping

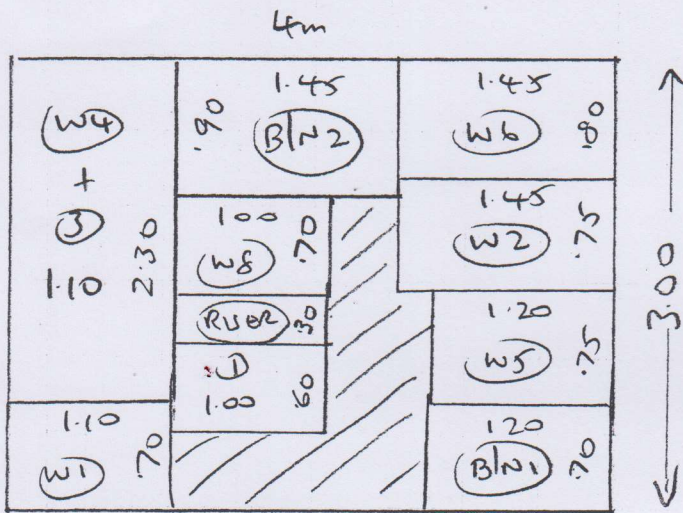

5.30 x 60cm
 1.70 x 60cm
 L-SHAPE (1/4 land) 1.20 x 1.00
 100
 60cm
 120
 60cm

PART 1 : CUT RUNNERS

1 or 2

Whipping & Binding Workshop Instructions



To: **Kasias Karpets Ltd** 07825 156676
 Branch: Select Branch
 Branch Contact: Select Contact

Customer Name: Carey **Please quote on invoice**

Job No: R17668 **Please quote on invoice**

Description of Carpet: Harewood, NTHAR-04

Carpet Finish: Top Taping SIDES ONLY

Number of Pieces: 3

Sizes to be cut to: (If applicable) already cut for runners

Runner Lengths for Taping: **Please check before sewing** 5.30, 1.70, and L shape 1m x 1.20m

Date for collection: 13 November 2017 Required back by: 15 November 2017

Collection From: Warehouse Return To: Warehouse

| | | | |
|-------------------------|------------------|----------------------------|--|
| If Tape Selected | Supplied By | Select Supplier (if Appl) | |
| Colour of tape: HB 8412 | Size of Tape: 4" | Amount Visible on Top: 5cm | |
| If Whipping: | | | |
| Colour of Whipping: | | | |

Special Instructions

Sewing charges authorised - Please note only charges authorised in writing will be paid on invoice

| Materials | Description | Quantity | Unit Cost | Total |
|---------------------------|---|----------------|-----------|---------|
| Whipping | Under 3m x 3m | | £2.30 | |
| | Over 3m x 3m | | £2.50 | |
| Standard Taping | Labour Only Under 3m x 3m | 18.00 | £6.00 | £108.00 |
| Double Taping | Labour Only Under 3m x 3m | | £8.50 | |
| Faux Suede & Leather | Labour Only Under 3m x 3m | | £7.00 | |
| Mitres Cotton | Per Corner | NOT APPLICABLE | | |
| Mitres Leather | Per Corner | NOT APPLICABLE | | |
| Blind Stitching MACHINE | 38mm Tape Labour & Tape | | £8.00 | |
| Blind Stitching HAND SEWN | 38mm Tape Labour & Tape | | £10.50 | |
| Hidden Stitching | Additional cost per lin M to above prices | NOT APPLICABLE | | |
| | (Enter the same quantity as tape quantity) | | | |

Materials & other charges

| Quantity | Description | Quantity | Unit Cost | Total |
|----------|-----------------------------|----------|-----------|--------|
| | Padding | | £1.00 | |
| | Chenille Tape 120mm | | £4.00 | |
| | Chrome Tape 120mm | | £3.50 | |
| | Cotton Tape 70mm | | £3.00 | |
| | Cotton Tape CK 120mm | | £3.50 | |
| | Cotton Herringbone HB 120mm | 18.00 | £4.00 | £72.00 |
| | Faux Leather 120mm | | £5.50 | |
| | Faux Suede 120mm | | £5.50 | |
| | Goblin GLV 120mm | | £4.00 | |
| | Jute 120mm | | £3.00 | |
| | Leather 120mm | | £12.50 | |
| | Pipeline | | £3.00 | |
| | Starline (Linen) LS 120mm | | £5.50 | |
| | Superstrong 120mm | | £5.50 | |
| | Slim 120mm | | £3.00 | |
| | Teakline 120mm | | £5.50 | |

| | |
|--------------|----------------|
| Sub Total | £180.00 |
| VAT @ 20% | £36.00 |
| Total | £216.00 |

2022