

cf plan

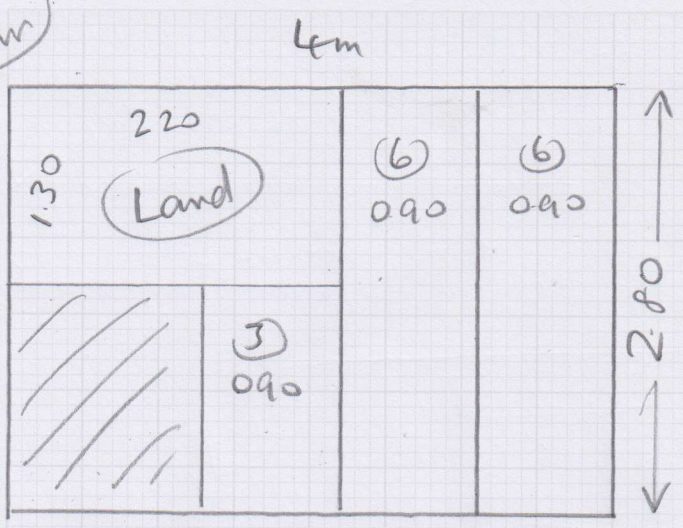

R17687

Andrew Purnell Estates
 151 Worples Road
 Raynes Park
 SW20 8RQ

Sheet: of:
 Silk Touch Delivery
 SLK 423D
 (Night Sky)

Layout

Landing 1.20m x 2.10m
 15 stairs 0.45m x 0.85m

2.80 x 4m

Grey Cor

1.15 x 2m

Hall Cor 1.05 x 1.80

COLLECT KEY FROM:
 ANDREW PURNELL (Estate agent)
 3 The Pavement
 Worples Road (open from 8.45am)
 Wimbledon (Stacey or Frank)
 SW19 4DA

RETURN KEY WHEN FINISHED