

R17740

Mrs R. Woodrighie
38 PARKSIDE
WIMBLEDON
SW19 5NB

Milano, 466 Argento
22.30 x 5m

CUTS
5:30
4:30
5:20
7:50
22.30 x 5m

PHASE 2
11/4/18

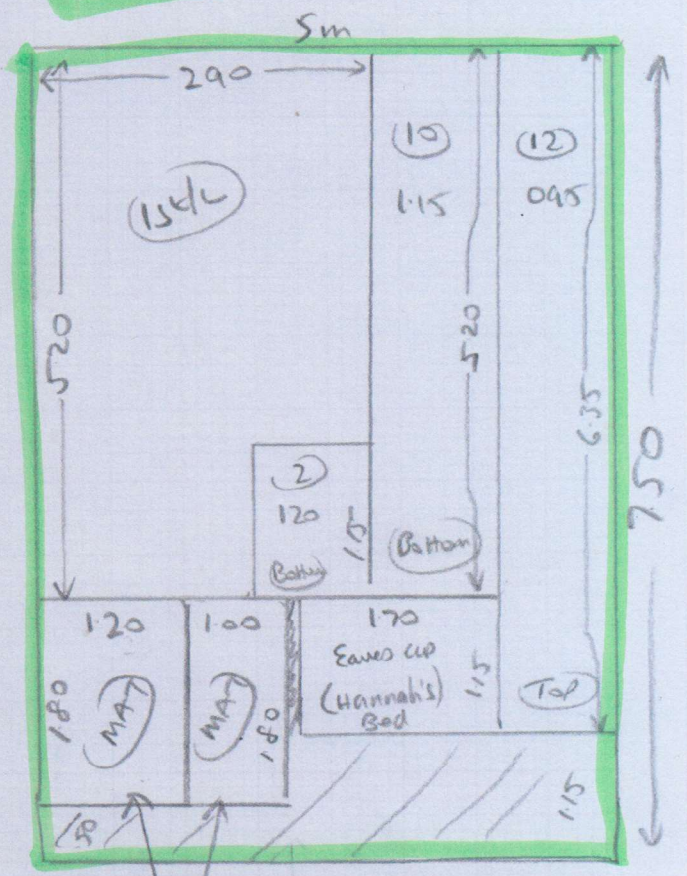

2 mats. Cut to 180x120
+ 180x100
+ send for whipping

2 of 4

2x stairs + L/H/L

Top from stairs

WOOD NOSE

Riser 25 x 86

W1 75 x 98

W2 85 x 120

W3 80 x 80

127

50 x 86

*

PHASE 2
11/4/18

RITTED
WOODNOSE
38 PANKSIDE
SWING SWB

POMACEY ULLAY
4 STAIRS

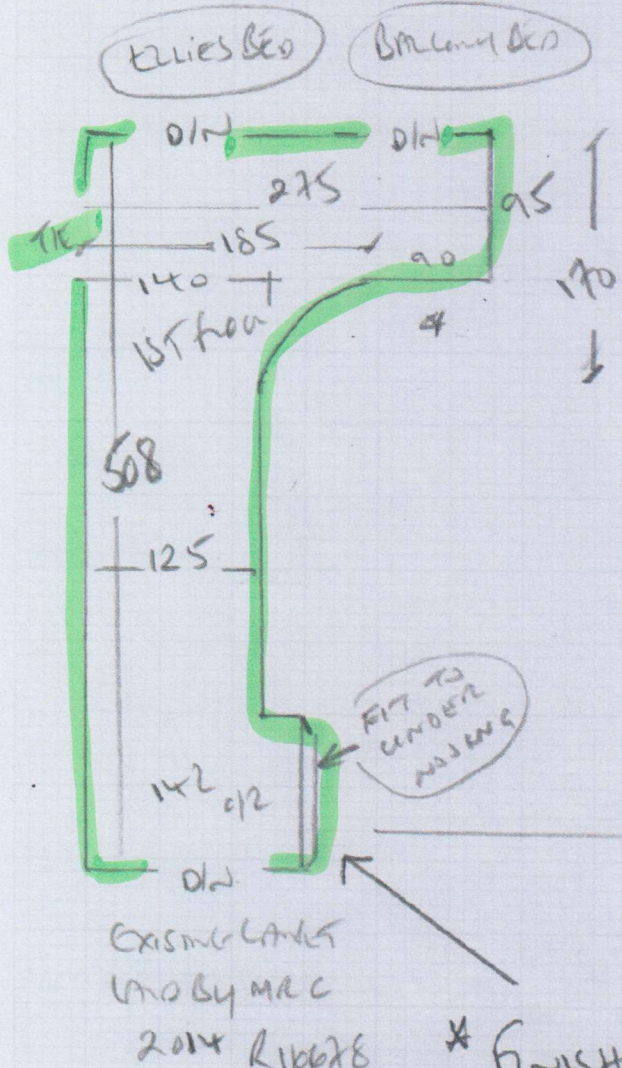

To Hall

Bl. 1 800 x 210

Bl. 2 50 x 140

27

50 x 105

1/4 130 x 105

107

50 x 105

1/4 130 x 103

27

50 x 103

Riser

20 x 107

2x Bls } Turn right
head side in
order to be
same as
stairs

* FINISH OVER LIP *

WALK WAY OVER RISER

* FIT RISER TO MATCH 1st FLOOR DIRECTION *

4024