

imrcarpet  
 Job No: R18707  
 Name: PULVES  
 Address: 78 MALLIYAT RD  
 SWIG 56N  
 Tel:  
 Sheet: 1 of 2

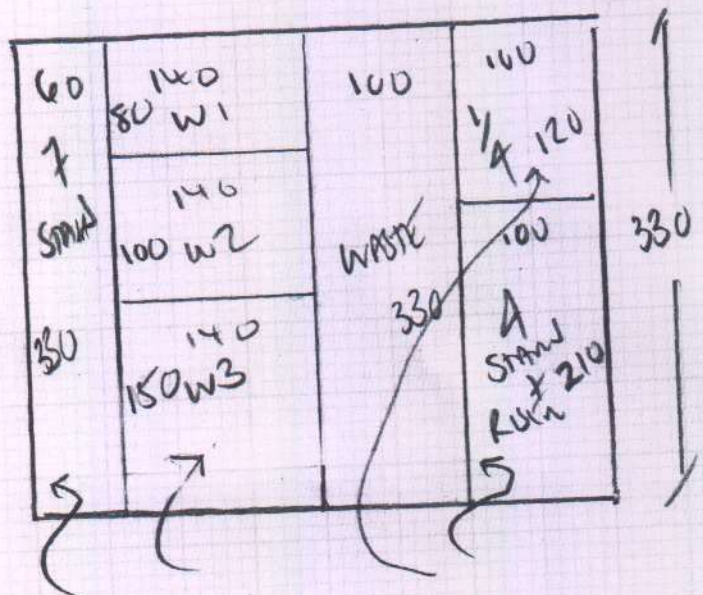

BEST STAIR  
 COVER 129 M<sup>2</sup>

PLAN 330 x 400

13.20 m<sup>2</sup>

- \* TEMPLATE RUNNERS + WINDOWS \*
- + SHAPE 1/4 LANDING ON SIDE
- \* MATCH UP SMILES / PATTERN MATCH \*

+ CAR MAX  
 1.15 x 200

Job No: R18707  
 Name: PULVES  
 Address: 78 MANLY RD  
 SW19 5BN  
 Tel:  
 Sheet: of:

1st floor Landing Wood  
 Riser

16 x 84 } beam  
 44 } TARGO  
 45 x 86 } runner

Riser of 61mm <sup>Remain</sup> wood  
 finish off under lip  
 of base

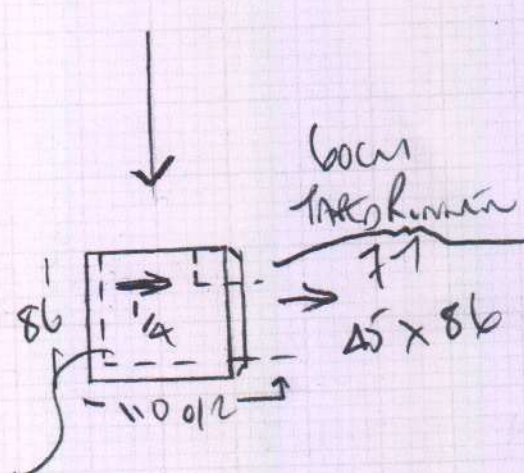

- w1 66 x 88
- w2 850k x 135
- w3 1000k x 86

SHAPE 1/4 landing  
 ON SIDE

Best STAIR  
 Color 129 MENSE  
 SEE PLAN 330 x 400  
 13.20m<sup>2</sup>

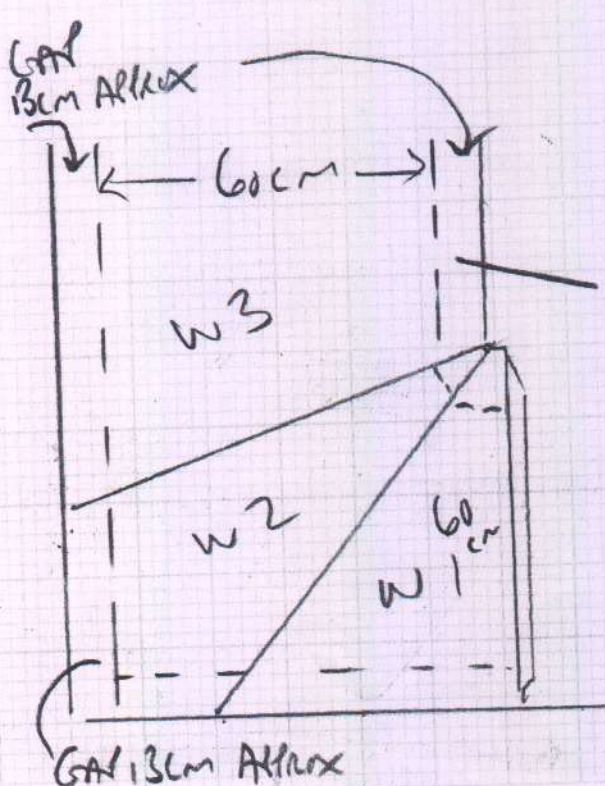

KEEP 13cm GAP AT GALT SIDE OF  
 WINDOWS - UNIFORMED ALL  
 WAY DOWN TO BOTTOM STEP!