

R18257
 JENKINS
 3 MELBOURNE RD

SWIG 3BB
 1 & 2

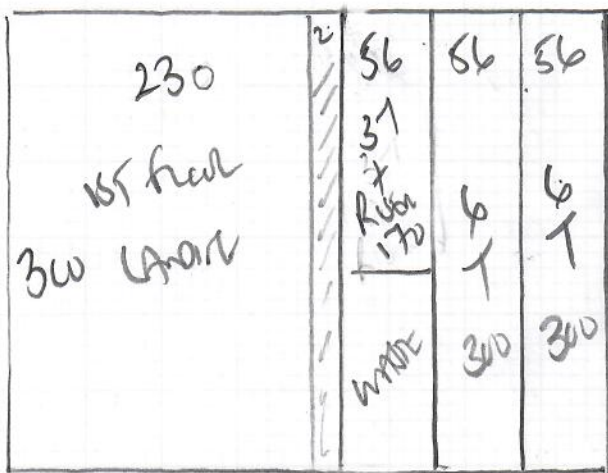

1st floor LANDING
 + STAIRS TO GROUND floor

HAVANA

Color HAV-209

RAW 300 x 400

12m²

MATCH / LINE UP COLORS IN
 LOOP WHEN COME DOWN
 TO LUNNER

* Re-use EX S/NAP at bathroom

Change 3x D/NAP to SATU Ai

R 18 25T
JENKINS
3 MELBUNNEKD
WIMBUDON
SW 19 3BB
2 of 2

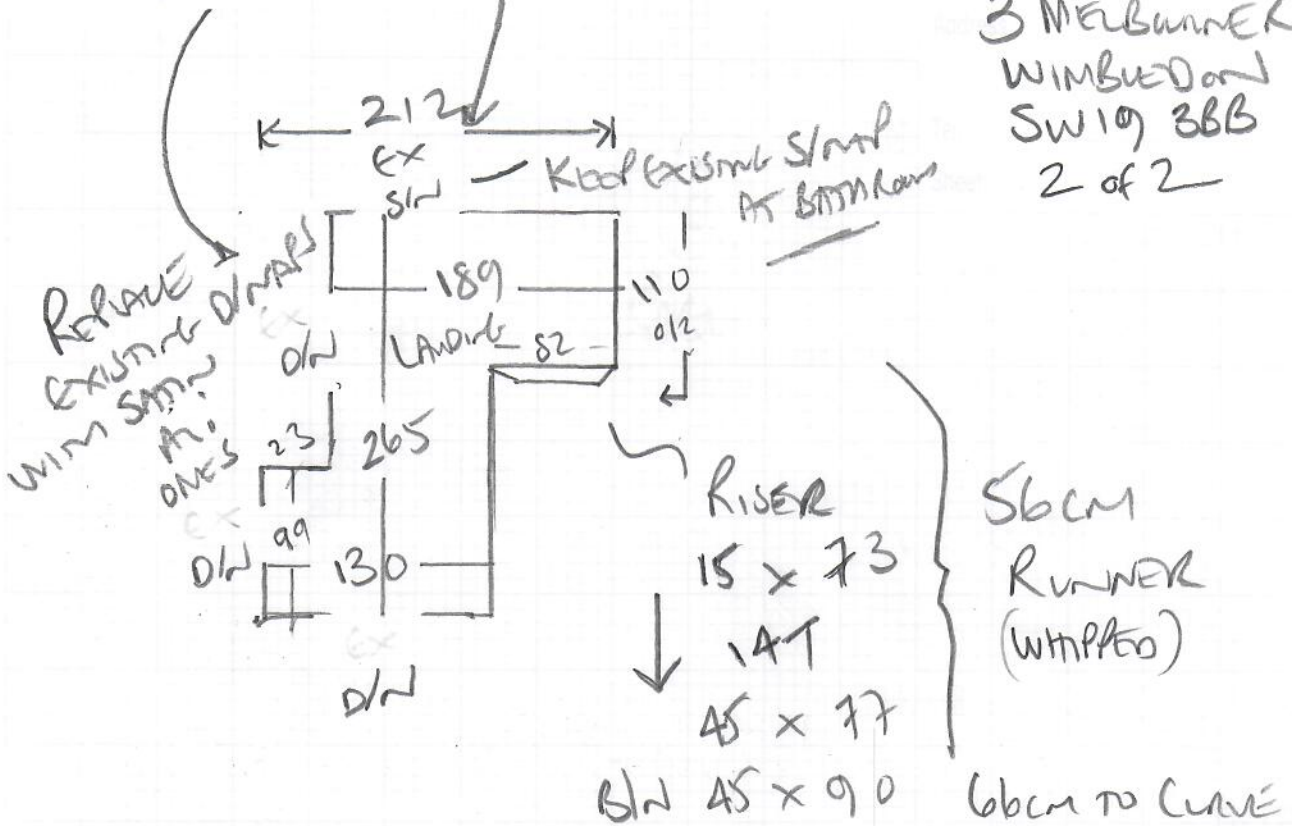

WOOD FLOOR

EXISTING GRIPPER (ALREADY SET AS RUNNER ON STAIRS)

+ ADD 3 NEW STICKS

EXISTING AI BARS 3x D/N 1x S/N

UPGRADE OPTION TO SATU Ai (FOR 3 D/NAP ONLY)

PREVIOUS RUNNER WAS 56cm WHIPPED

CUSTOMER HAS OWN STAIRCASE 66cm (SEE END) WINDSCREW

? CUSTOMER WILL FIT CLAUDES BACK ON STAIRS BEFORE INSTALLATION OF RUNNER