

STAIRCASE - Ground to 1st floor

R19104
 DR2121
 12 TOLVENE ROAD
 SW20 8KA

1 of 1

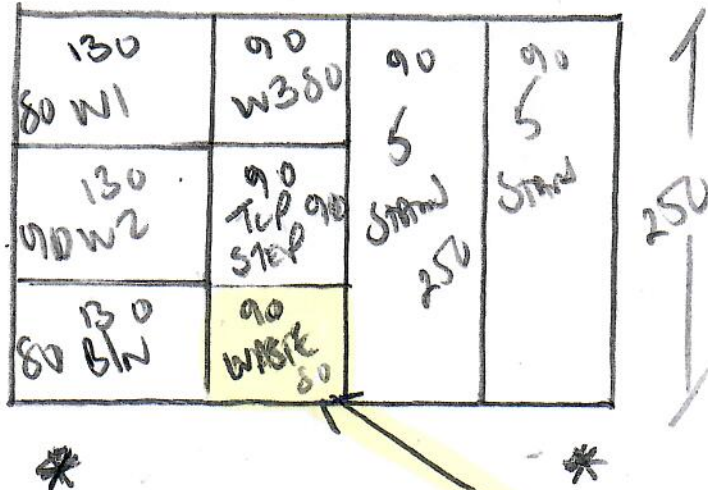

CRITERION TRUST '50'

Colour London Brick

PLAN 2.50 x 4.00

10M²

LANDING DIM 50 BEANS
 FINISH UNDER NOSING

17

↓ 45 x 90

W1 70 x 105

W2 78 x 110

W3 70 x 74

→ 10 STANDS
 43 x 74

BLW
 47 x 90
 CAL + BAND

LEAVE PIECE OF
 WASTE ON SIDE WITH
 CUSTOMER

QUOTE 1 LABYRINTH TRUST EAST 151 £2675-10%
 ALICE 2 NAVIATA CALL TAVO 990 £