

SHARE 1/4 LANDING AS  
 WAREHOUSE + MARK UP  
 EDGES FOR TAPING  
 XX

R19106  
 WILLIAMS  
 20 QUEEN MARY AVE  
 SM445R

1 of 2

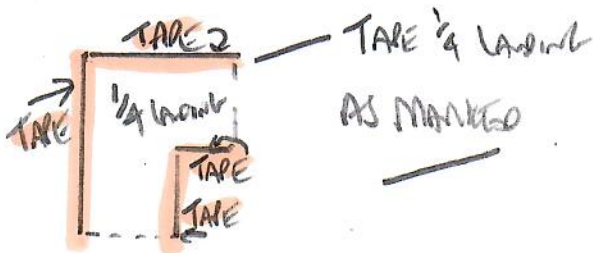
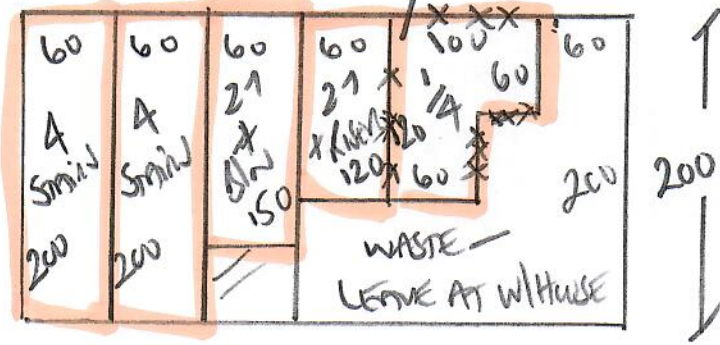

CLIENT  
 Local GHL - CT  
 FAWN

PLAN 200 x 400

TAPING - HB3230 17 LINEAR METERS

Job No: R19106  
Name: Williams  
Address: 20 Queen Mary Ave  
Morden  
Tel: SMA AJK  
Sheet: 2 of 2

SHARE + TAPE  
1/4 Landing

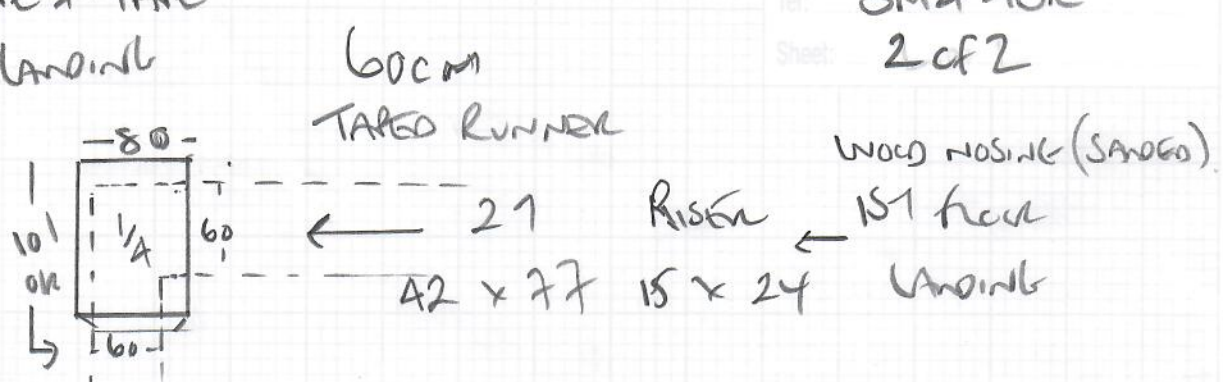

101  
AS x 78 } 60cm  
TAPED  
Runner

Blind AU x 90  
(70cm to curve)

TAPING HB 3230  
17 LIN MATS

WOOD floors (STAIRS PAINTED WHITE)

NO UPLIFT

NO SCOTCH on top Riser so OK for runner ✓

SHARE + TAPE 1/4 Landing TO MATCH RUNNERS WIDTH