

R19179  
The Code Design Studio

1 of 2

HAVANA  
Col. HAV-24

Cut Plan 480x480  
= 19.20m<sup>2</sup>

Eastern Promise Dubai stairs

10 @ 80cm (9T + W10)

3 @ TBC (Remove finial on R/H side + Cut Rod to size)

5 @ 80cm (4T + Rise)

Taping = 19 L/mtrs.

9/8) \* = Cut down @ W/H to exact width & length

\*\* = Shape these 3 winders on site  
maintaining an equal 10cm gap at sides

14/8) F/F = Fully fitted (Mark up + store @ W/H until 14/8)

Landings are having timber floors fitted  
with suitable timber nosings at junctions  
with the stair carpets

\* Fit Eastern Promise - Reeded Rods in SATH BRAS  
Finish With Dubai finials

Upper STAIRS  
(Fully fitted)

Builder to install  
a timber nosing

R19179  
The Code Design  
Studio

2 of 2

Fully Fitted

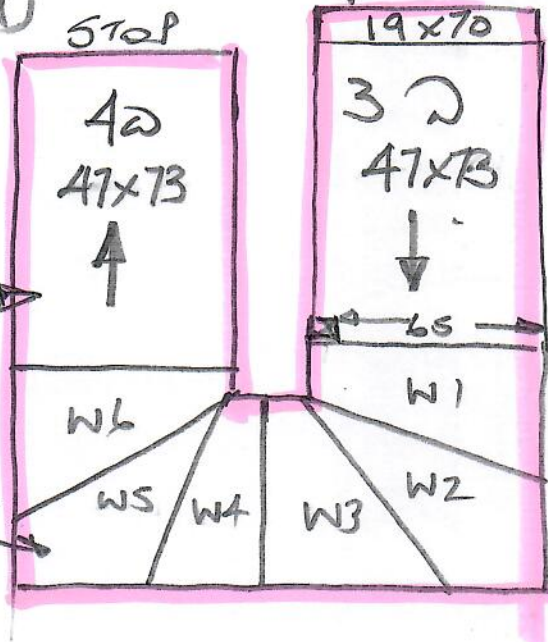

- W1 60x79
- W2 68x101
- W3 65x75
- W4 60x86
- W5 72x101
- W6 65x65

Fully fitted

Lower STAIRS

Builder to install a timber nosing

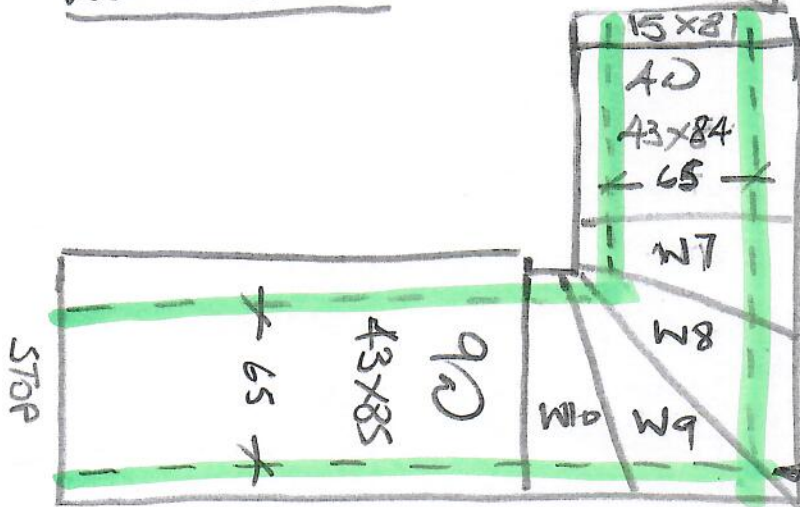

- W7 52x88
- W8 58x115
- W9 68x115
- W10 54x81

Shape on site

Maintain a 10cm gap to match straight stairs

STAIRRODS (for Lower STAIRS only)

- 10 @ 80cm (9T + W10)
- 3 @ TBC (3 x Winder) - Cut to size on site After fitting Winder)
- 5 @ 80cm (4T + Riser)

\* Use a pipe cutter to cut hollow rod to size