

Cut Runners 5/4

R19398
Windsor Homes
(R/H House)

Vllswater
Col. Vlls-29

- 1st floor land 200 x 500
- Cut plan ① 1265 x 500
- Cut plan ② 380 x 500
- Cut plan ③ 425 x 500
- Cut plan ④ 230 x 500
- Cut plan ⑤ 340 x 500

$$2840 \times 500 = \underline{\underline{1420000}}$$

$$v/Lay = 115m^2$$

*Cut Runners
@ 69.50cm so that they'll fit in between 70cm stairrods to be fitted by Windsor Homes

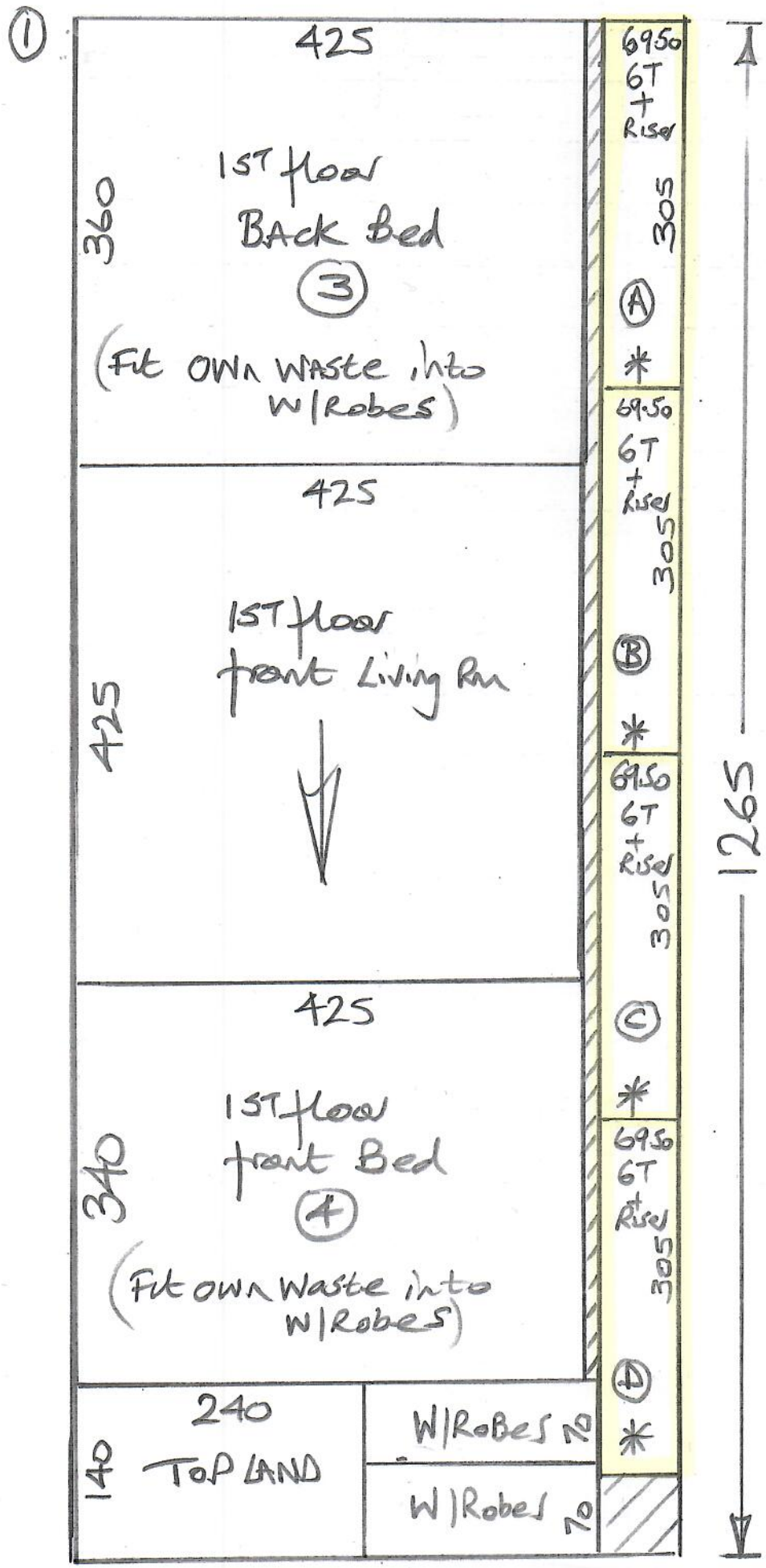

v/floor heating T/out so Must stick s/f to all areas except stairs + 2 x 1/2 Landings

Whipping & Binding Workshop Instructions

Revised Prices FEB 2024



To: **Kasias Karpets Ltd** 07825 156676
 Branch: Raynes Tel: 020 8947 7522 E:raynesbranch@mr-carpet.co.uk
 Branch Contact: Nigel

Please Invoice to
Designer Carpets

Customer Name: Windsor Homes **Please quote on invoice**

Job No: R19398 **Please quote on invoice**

Description of Carpet: Ullswater - ULLS29

Carpet Finish: Whipping SIDES ONLY

Number of Pieces: 4

Sizes to be cut to: (If applicable) 4 @ 3.05 x 69.50cm

Runner Lengths for Taping: **Please check before sewing**

Date for collection: 5th April 24 **Required back by:** 10 April 2024

Collection From: Warehouse **Return To:** Warehouse

If Tape Selected	Supplied By	Other Specify
Colour of tape:	Size of Tape:	Amount Visible on Top:
If Whipping:		
Colour of Whipping: To Match		

Special Instructions:

Sewing charges authorised - Please note only charges authorised in writing will be paid on invoice

Materials	Description	Quantity	Unit Cost	Total
Whipping	Under 3m x 3m	24.40	£3.30	£80.52
	Over 3m x 3m		£3.30	
Standard Taping	Labour Only Under 3m x 3m		£6.80	
Double Taping	Labour Only Under 3m x 3m		£9.50	
Faux Suede & Leather	Labour Only Under 3m x 3m		£8.00	
Mitres Cotton	Per Corner		NOT APPLICABLE	
Mitres Leather & Suede	Per Corner		NOT APPLICABLE	
Narrow Binding THICK PILES	Labour & tape included		£8.50	
Blind Stitching MACHINE	NO LONGER AVAILABLE HAND SEWN ONLY			
Blind Stitching HAND SEWN	38mm Tape Labour & Tape		£15.00	
Hidden Stitching	Additional cost per lin M to above prices		NOT APPLICABLE	
	(Enter the same quantity as tape quantity)			

Materials & other charges

Description	Quantity	Unit Cost	Total
Padding		£1.30	
Chenille Tape 120mm		£4.80	
Chrome Tape 120mm		£4.80	
Cotton Tape 70mm		£3.80	
Cotton Tape CK 120mm		£4.20	
Cotton Herringbone HB 120mm		£4.80	
Linen Twill Tape		£6.40	
Faux Leather 120mm		£7.00	
Faux Suede 120mm		£7.00	
Goblin GLV 120mm		£4.80	
Jute 120mm		£4.60	
Leather 120mm		£14.50	
Pipeline		£3.70	
Starline (Linen) LS 120mm		£6.60	
Superstrong 120mm		£6.40	
Slim 120mm		£4.00	
Jaspa Tapes (Inform Kasia when reqd)	(Select Jaspa Tape)		
Bespoke Tape (Enter description here)	& Enter cost price per mtr in unit cost colum>>		£100.00
		Sub Total	£80.52
		VAT @ 20%	£16.10
		Total	£96.62

CARPETS THAT CANNOT BE MACHINED / HAVE TO BE SEWN BY HAND = EXTRA CHARGE OF £6.00 PER LIN METER