

1

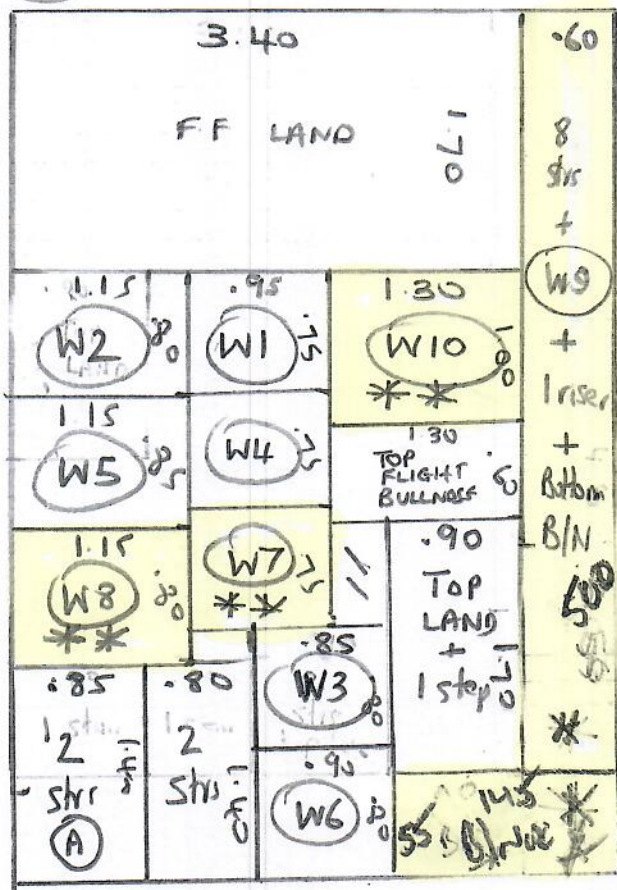

R19642  
WALL  
40 Meadow Close  
SW20 9JB  
07841-656094

1 of 2

BOSTON  
BOS-017

① 5.55 x 4 M.

22.20 SQ M.

19 SQ M U/L

\* - warehouse - Cut Down Runner 500 x 60cm  
\*\* - on site - W7, W8, W10 + Bullnose

TAPING  
JASPA BASKETWARE CASH INDIGO

Runner 87+ Run 01	555 x 2	1110
W7	075 x 2	150
W8	080 x 2	160
W10	100 x 2	200

1620 = 17 Lin Mks

Job No: R19642  
Name: WALL  
Address: 40 Meadow Close  
SW20 9JB  
Tel: 07841 - 656094  
Sheet: 2 of 2

Top to First

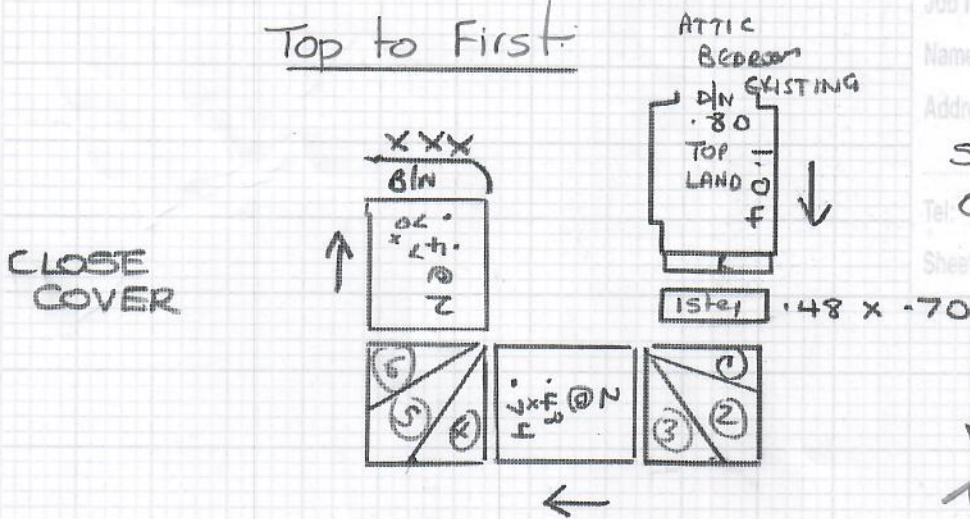

IF SCOTIA BEADING ON  
TOP RISEN KELVIN HAS

ADVISED CUSTOMER TO  
REMOVE BRICK TO RECONSTRUCT  
+ FILL PAINT  
ACCOMPANIED

TEMPLATE BROAD + WID  
AS RUNNER ON SITE

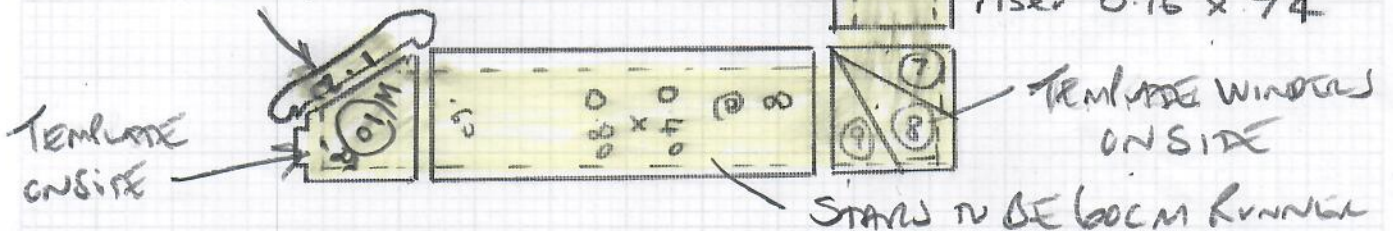

- W1 = 0.64 x 0.83
- W2 = 0.70 x 1.03
- W3 = 0.70 x 0.74
- W4 = 0.66 x 0.87
- W5 = 0.73 x 1.03
- W6 = 0.67 x 0.70
- B/N = 0.49 x .88
- W7 = 0.61 x 0.94
- W8 = 0.70 x 1.13
- W9 = 0.67 x 0.78
- SMU (Bottom) = 0.67 x 1.10
- (Bottom) 0.38 x 1.38

CLOSE COVER

RUNNER

- TAPING 555 x 2 11.10
- W7 75 x 2 150
- W8 80 x 2 160
- W10 100 x 2 200

16.20