

Job No: R19692
Name: The Code Design
Address:

Tel: 1073
Sheet:

Westex Fined Earth
Loxley Loop - Malm

Cut Plan 7.95×100
 $= 7.95m^2$

Taping = 18 Lin mtrs

Jubilee STAIRRODS
Col. Antique

14 No. Rods

Brooklyn
Col. Bro-W09 (Thread)

Under STRS Cupboards
 $= 180 \times 400$
 $= 7.20m^2$

Westex fined Earth
 Loxley loop - Malm with
 Jaspā Khaki tape &
 Jubilee Stairrods in
 Antique finish.

Job No: R19692
 Name: The Code
 Address: Design.
 Tel:
 Sheet: 2 of 3

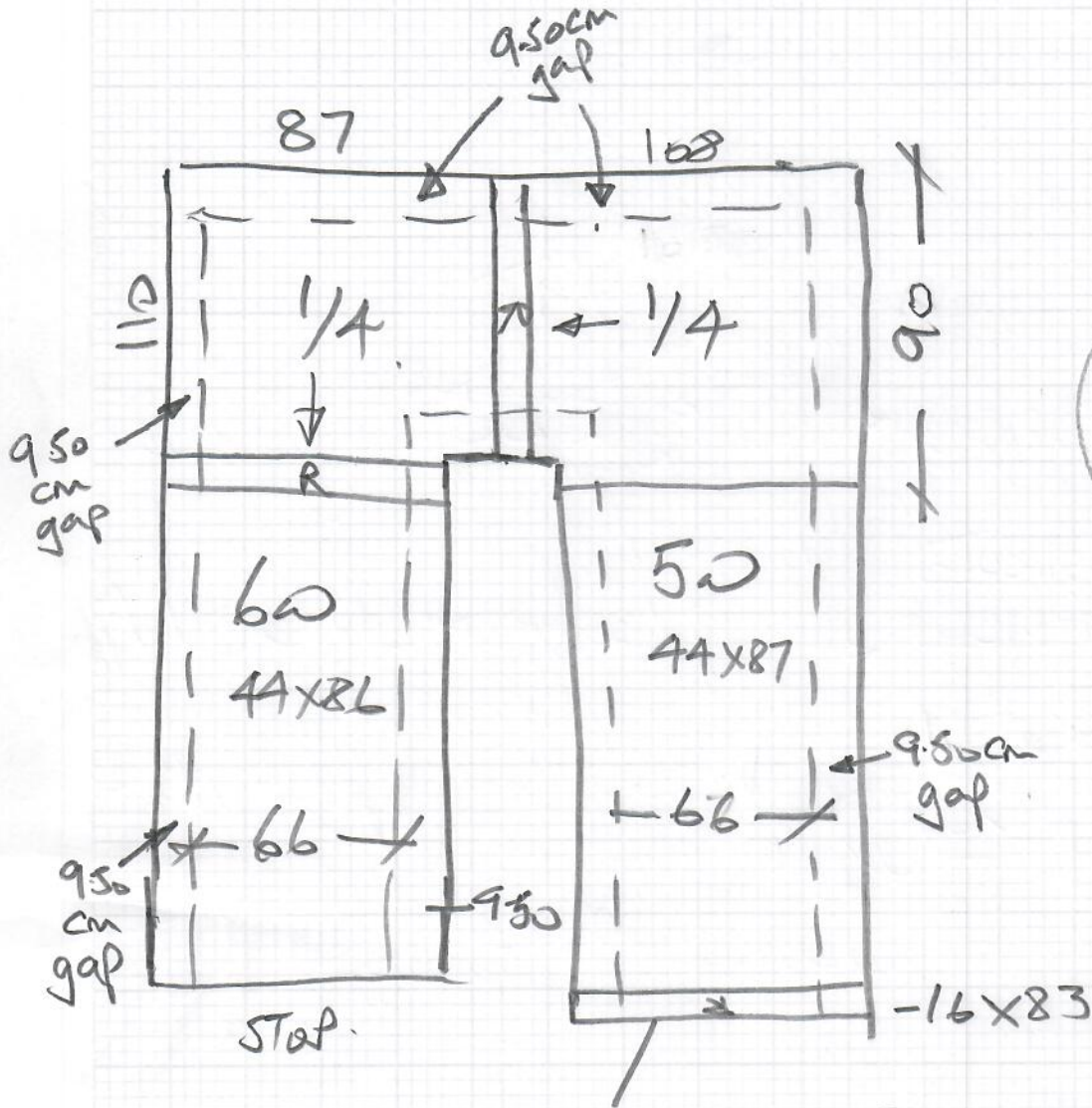

Low tag
 Rubber to
 Runners

Builder to fit
 Timber floor & Timber
 nosing.

Fit HD pu foam u/lky
in this area

mrcarpet
DESIGNS FOR FLOORS
Job No: R19692
Name: The Code Design Studio
Address:
Tel:
Sheet: 3 of 3

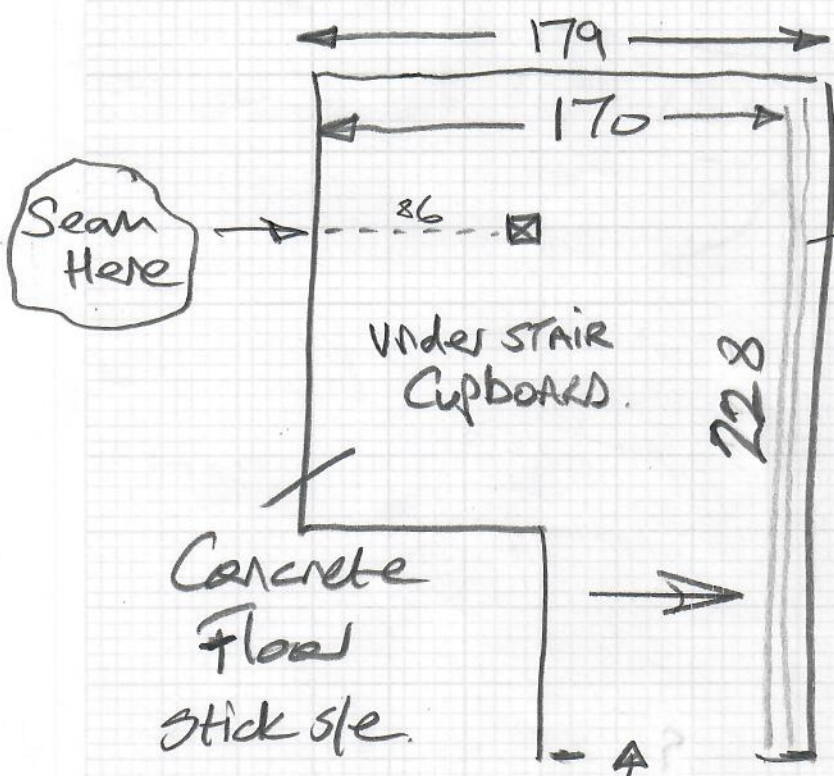

Pipes to be boxed in?

Brooklyn
Gl. BRO-Wo9 Thread

= 180 x 400

Fit 12mm RAMP + fit to wood

HMU (Timber floor) 45mm High

180 Under STAIR Cupboard