

1

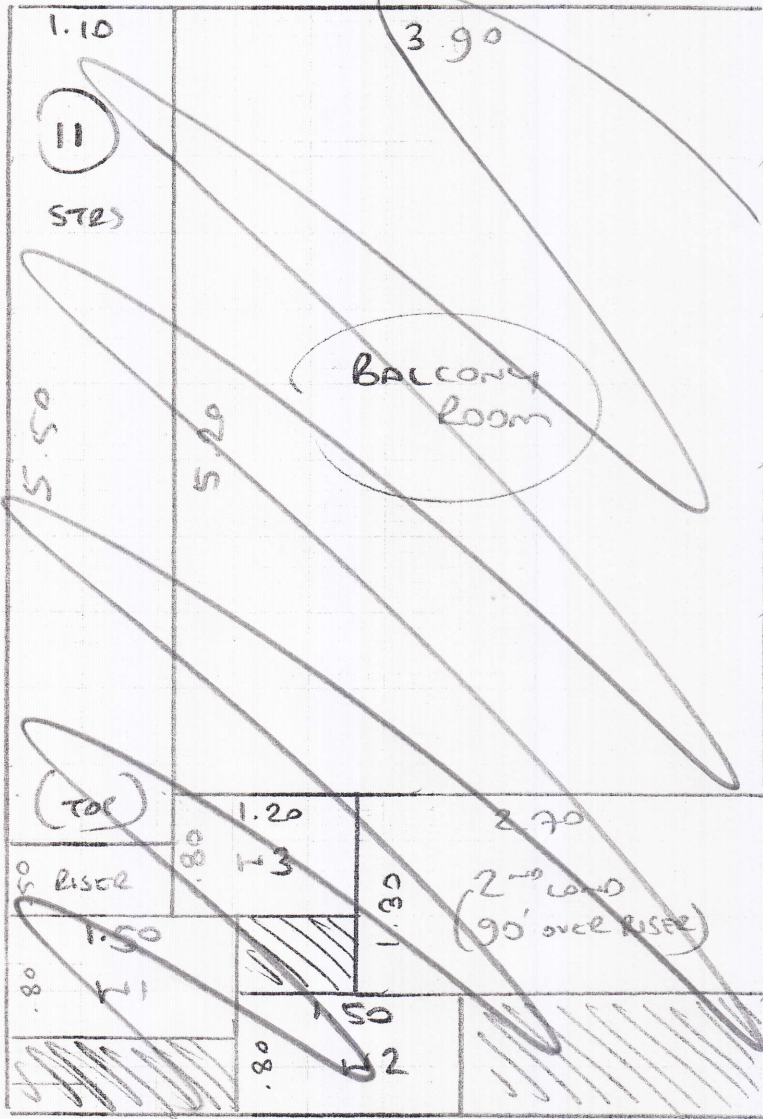

S27013

TODMAN

1 of 2

HERTZEL TRUST 40 - CLTS

1ST LAND 2.20 x 5m
(90' OVER RISE)

Plan 1 7.30 x 5m

9.30 x 5m

47.5m²

2

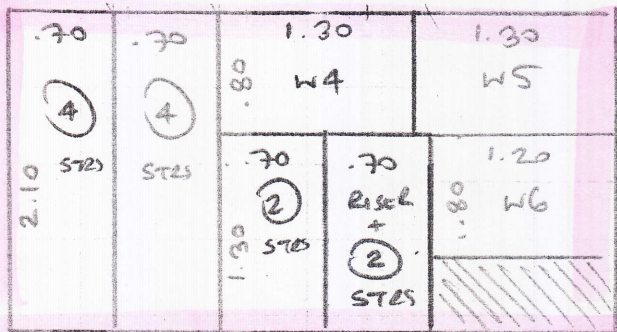

MAIN STAIRS ONLY

HAVANA - CLTS

Plan 2 2.10 x 4m

8.4m²

NOTE - CUT Plan 2 DOWN AS RUNNERS
STRAIGHTS TO BE 69cm WIDE
TEMPLATE WINDERS ON SITE.

ALAN
05-12
TEMPLATING

Todman

2 of 2

TOP STAIRS

- Riser 018 x 0.94
- (9) 0.43 x 0.94
- W1 0.73m x 1.15
- W2 0.72 x 1.34
- W3 0.77 x 1.10
- 2nd/L 2.57m x 1.02
- (2) 0.43 x 0.92

wood
wld
needs ste (now bulky gutted)

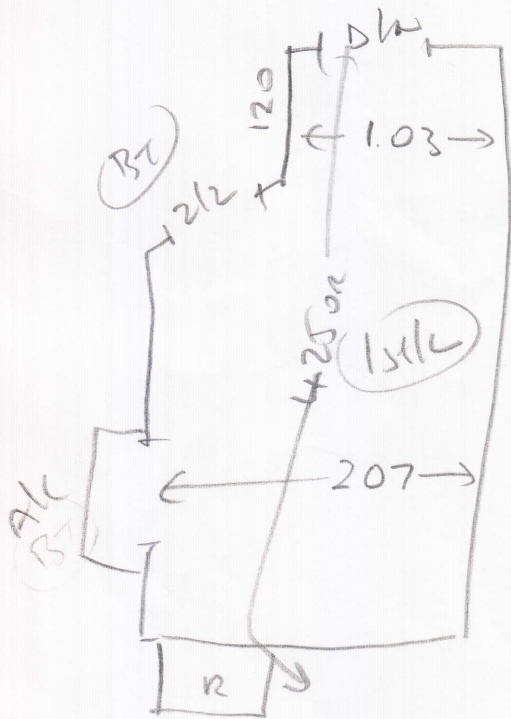

	RHxL	Run
Riser	018 x 0.94	0.69
(12)	0.45 x 0.94	0.69
W4	0.65 x 1.00	} cut on site
c/w5	0.57 x 1.05	
Curved W6	0.76 x 1.28	

L1 stairs
wood
wld
cut ste

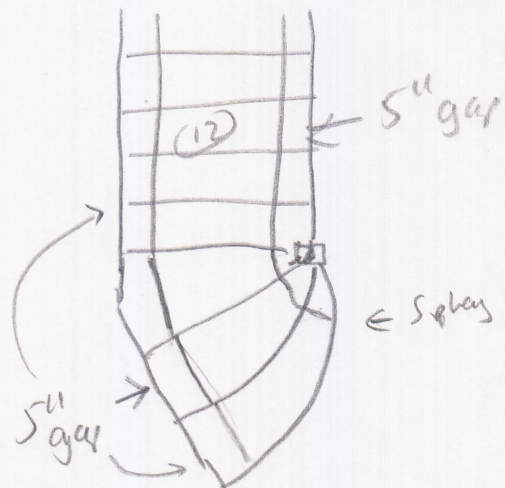



BH CARPETS - WHIPPING / BINDING FORM

Tel - 020-8665-9110

Fax 020-8665-6611

Customer Name: **Todman**

Job No. : **S27013**

Description of carpet : **Havana Pin Stripe**

Whipping / Blind Stitching / **Top Taping**

All Round / **Sides only (for Stair Runner)**

Colour of Tape from Crucial Trading : **C39 Slate**

Size of Binding tape: **_120mm_** Amount showing on top **_1/2 & 1/2**

Number of pieces : **Confirm with W/House** Needed back by: **a.s.a.p**

Sizes to be cut to: **PRECUT**

Whipping:	metres @ £2.00 linear metre	£
Blind Stitch:	_____ metres @ £7.00 linear metre	£_____
7.5 cm Top Taping:	_____ metres @ £5.50 linear metre	£_____
120mm Top Taping	_18m_ metres @ £5.50 linear metre	£99.00 _____
Carriage Charge	_____ @ £10.00 per order	£_____

Any Queries call

Total £99.00

Collect from:
Warehouse

Deliver Back to:
Warehouse

Mr Carpet Use. (Copy to be faxed to Shop & accounts Dept. when returned)

Date Collected: _____ Collected By: _____

Date Returned: _____ Returned By: _____

Invoice No: _____ Comments: _____