

S27473

DR. S. GEORGE  
39 Temple Street Rd  
E Sharn  
SW14 7QP

Foot: F40497  
7.6524

EXISTING U/LAY  
EXISTING SLEDGE

Needs 2 x anod 2/2  
Reuse all other door bars

4m

1st/L

2.00

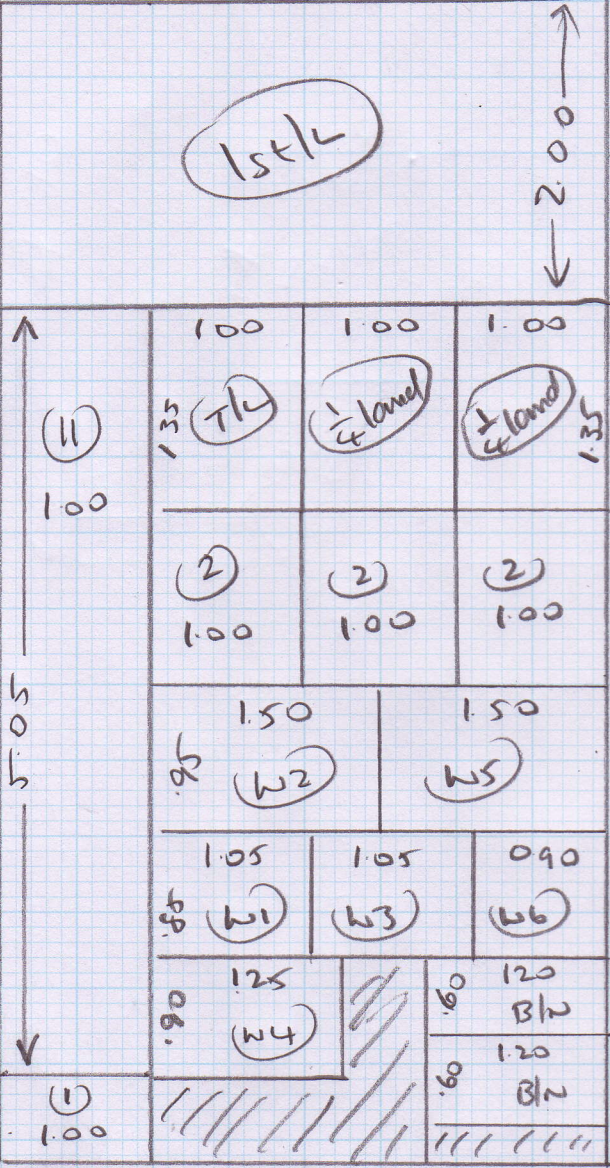

1 or 2

Layout

D.P. [unclear]

527473

DR. S. GEORGE  
39 Temple Sham Road  
E. Sham  
SW14 7QF

TOP STAIRS

T/L 128 on 0095 (amad 2/2)

(2) 049 x 082

W1 068 x 095

W2 075 x 125

W3 079 x 095

(2) 050 x 093

W4 073 x 113

W5 083 x 127

W6 071 x 083

(2) 049 x 081

B/N 050 x 110

UPLIFT / DISPOSE

REUSE EXISTING W/LAY

REUSE EXISTING SLS

REUSE EXISTING DINAPS

NEED 2 NEW 2/2092

1st/L 190 x 310

1x and 2/2

2x ext amad D/W

(1) 050 x 088

1/4 land 116 on 089

(11) 045 x 090

1/4 land 117 x 092

B/LR 047 x 095 ← TURN R. SIDE

2092