



Savage

S27587

SAVAGE

Top Stair

- T/L 155u x 071 (air 2h)
- W1 064 x 085
- W2 071 x 101
- W3 068 x 070
- W4 063 x 085
- W5 072 x 102
- W6 068 x 070
- (8) 048 x 071

**Blwy 13-08**  
**PHASE 1**

- ~~R/W~~
- (12) 044 x 076 extant
- W7 062 x 095
- W8 070 x 115
- Blk/W9 060 x 090
- CAP ONLY

WOOD  
u/d  
m/fix  
ext/slc

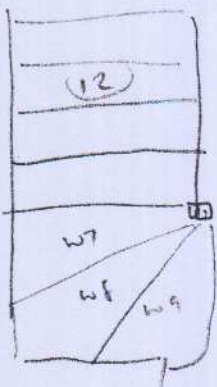

WOOD  
u/d  
ext/slc  
25'  
m/fix(x2)

