

Layout  
Land + Stairs

S279119  
 Mrs N. Holland  
 2 Coval Road  
 E. Sheem  
 SW14 7RL

TOP STAIRS  
 FULLY FITTED

- TKL 1.30m x 0.77
- (2) 0.48 x 0.63
- W1 0.58 x 0.77
- W2 0.62 x 0.92
- W3 0.62 x 0.64
- (1) 0.47 x 0.62
- W4 0.57 x 0.76
- W5 0.62 x 0.90
- W6 0.62 x 0.63
- (5) 0.47 x 0.62

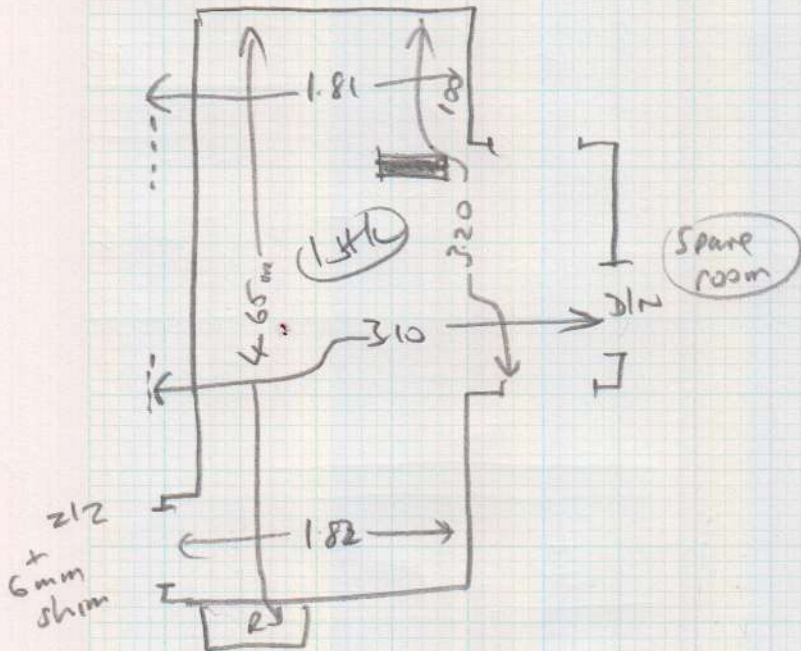

Bottom Stairs  
 all 56 cm runners

- Riser 0.20 x 56 cm runner
- (5) 0.46 x 56 cm runner
- 1/4 land 1.08m x 0.84
- 1/4 land 1.05m x 0.83
- (7) 0.45 x 56 cm runner

(2022)

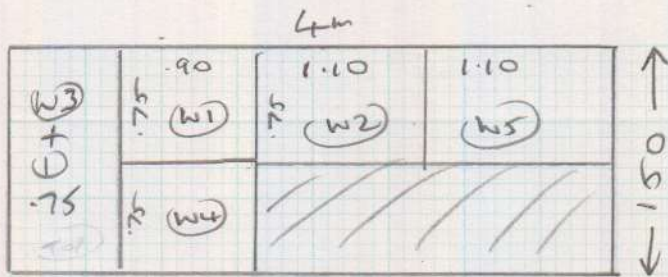

527919

Job Name: Mrs. N. HOLLAND  
 Address: 2 COVAL ROAD  
 E STREAN  
 SW14 7RL

Envelope FLO 492

Cl Stairs 1.50 x 4  
 6.50 x 4

SPACE BED Boston 1305 010  
 2.10 x 4m

Lounge Pastiche, 144  
 5.00 x 4m

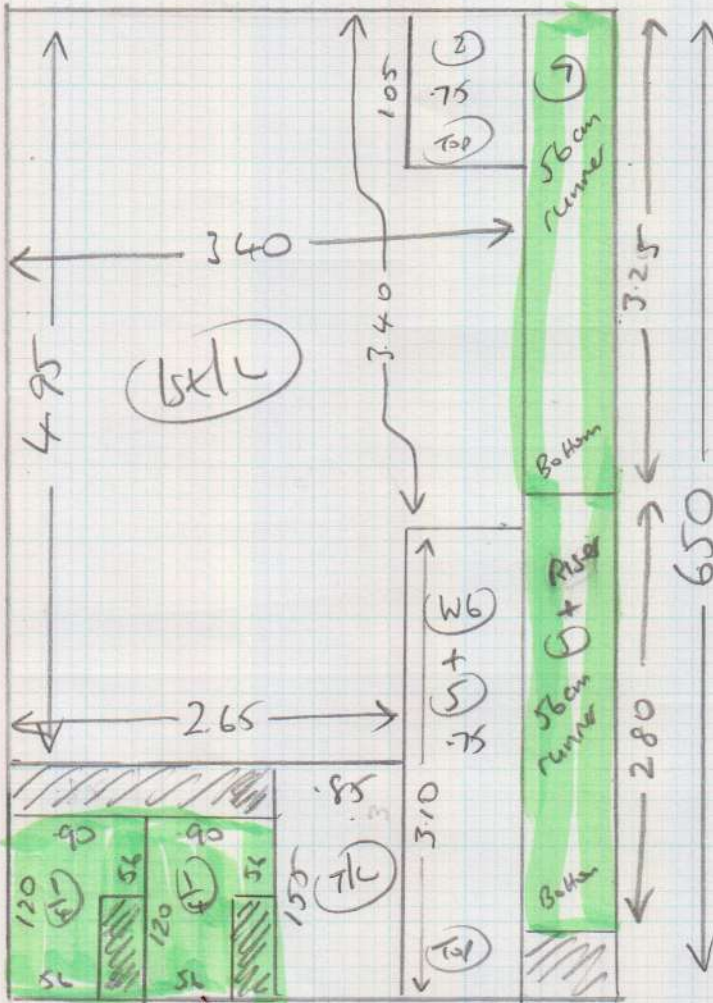

mon 30/11/15

Alan to cut runners  
 in warehouse + send  
 for taping

3.25 x 56cm  
 2.80 x 56cm  
 1.20 x 0.90 } L shape  
 1.20 x 0.90

BOTTOM  
 STAIRS  
 LAYOUT

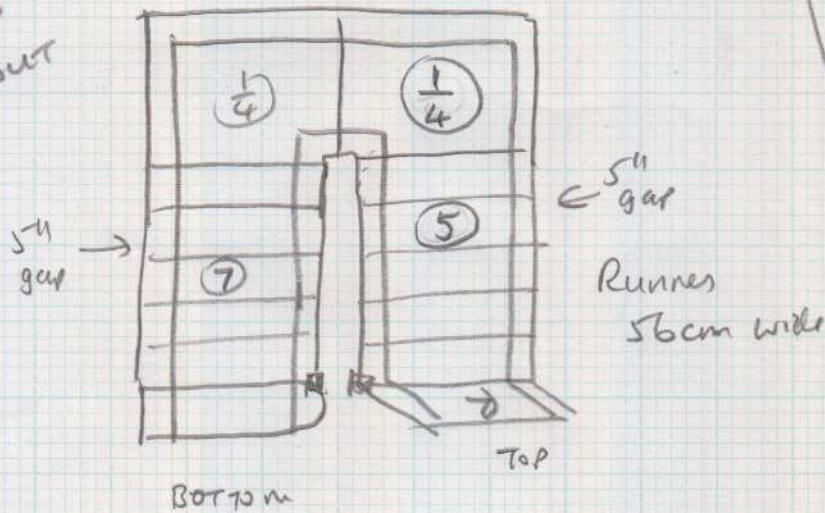

1022

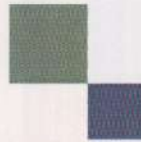

mrcarpet  
DESIGNS FOR FLOORS

299 Upper Richmond Road West, East Sheen SW14 8QS  
Tel: 020-8876 9126/ Fax: 020-8878 2655

## WHIPPING / BINDING FORM

To be collected by BH Carpets

Customer Name: **Holland**

Job No. : **S27919**

Description of carpet : **Fineloo, FLO 492**

Top Taping **50mm showing**

Colour of Binding tape : **C38 Aluminium**

Number of pieces : **4**

Sizes To be cut to: **3.25 x 56cm, 2.80 x 56cm, straight runners**  
**1.20 x 0.90 "L" shape, 1.20 x 0.90 "L" shape**

Whipping : \_\_\_\_\_ metres

1½" Binding : \_\_\_\_\_ metres

3" Binding : **21 metres**

### Any Queries call

John / Andy

**Deliver Back to :- Unit 19, Riverside Road, SW17**

#### Mr Carpet Use. (Copy to be faxed to accounts when returned)

Date Collected: \_\_\_\_\_ Collected By: \_\_\_\_\_

Date Returned: \_\_\_\_\_ Returned By: \_\_\_\_\_

Invoice No: \_\_\_\_\_ Comments: \_\_\_\_\_